



# COUNTY OF HARFORD

006531

Receipt: \_\_\_\_\_

Permit: \_\_\_\_\_

Date: 3-25

## APPLICATION FOR ENVIRONMENTAL HEALTH IMPROVEMENT PERMIT

### PROPERTY DESCRIPTION/LAND USE PERMIT

#### LANDOWNER INFORMATION:

NAME Judy Chatman Ingram  
 ADDRESS Rt 2 Box 58-15  
Cameron NC 28326  
 PHONE 498-2987 W \_\_\_\_\_ H \_\_\_\_\_  
 Home

#### APPLICANT INFORMATION:

NAME \_\_\_\_\_  
 ADDRESS \_\_\_\_\_  
 PHONE \_\_\_\_\_ W \_\_\_\_\_ H \_\_\_\_\_

#### PROPERTY LOCATION:

Street Address Assigned \_\_\_\_\_  
 SR # 1105 RD. NAME off Hicknut TOWNSHIP 09 FIRE \_\_\_\_\_ RESCUE \_\_\_\_\_  
 TAX MAP NO. 9555-11 PARCEL NO. 344 FLOOD PLAIN X PANEL 150  
 SUBDIVISION \_\_\_\_\_ LOT # \_\_\_\_\_ LOT/TRACT SIZE 1.23  
 ZONING DISTRICT N/A DEED BOOK 1072 PAGE 485  
 WATCHED DIST. III WATER DIST. \_\_\_\_\_ PLAT BOOK III PAGE 4

#### Give Directions to the Property from Lillington:

Hwy 421 to 210040 - take Hwy 27 west into Hwy 24-27 - take right at intersection  
take left on 2nd paved rd to the left (in Kay Town rd) in through community  
until you get into trees on both side - when trees clear on the left take left  
road along side of trees on the left come to 4th in. # - Gray + beige (pass) it on  
the right.

#### PROPOSED USE

- Sq Family Dwelling (Size \_\_\_\_\_ x \_\_\_\_\_) # of Bedrooms \_\_\_\_\_ Basement \_\_\_\_\_  
 Garage \_\_\_\_\_ Deck \_\_\_\_\_ (size \_\_\_\_\_ x \_\_\_\_\_)
- Multi-Family Dwelling No. Units \_\_\_\_\_ No. Bedrooms/unit \_\_\_\_\_
- Manufactured Home (Size 12 x 60) # of Bedrooms 2 Garage \_\_\_\_\_  
 Deck \_\_\_\_\_ (size \_\_\_\_\_ x \_\_\_\_\_)
- Number of persons per Household 1
- Business Soft Retail Space \_\_\_\_\_ Type \_\_\_\_\_
- Industry Soft \_\_\_\_\_ Type \_\_\_\_\_
- Home Occupation No. Rooms/size \_\_\_\_\_ Use \_\_\_\_\_
- Accessory Bldg. Size \_\_\_\_\_ Use \_\_\_\_\_
- Addition to Existing Bldg. Size \_\_\_\_\_ Use \_\_\_\_\_
- Sign Size \_\_\_\_\_ Type \_\_\_\_\_ Location \_\_\_\_\_
- Other \_\_\_\_\_

Water Supply:  County  Well (No. dwellings 2)  Other \_\_\_\_\_  
 Sewer:  Septic Tank (Existing? No)  County  Other \_\_\_\_\_  
 Erosion & Sedimentation Control Plan Required? Yes \_\_\_\_\_ No   
 Are there any wells not on this lot but within 40 ft of the property line No (show on Site Plan).

\*NOTE: A Site Plan must be attached to this Application, drawn to scale on an 8.5 by 11 sheet, showing: existing and proposed buildings, garages, driveways, decks, accessory buildings, well, and any wells within 40 feet of your property line.

DOGS IN THE FENCE DO BITE

SETBACK REQUIREMENTS

Front property line  
Side property line  
Corner side line  
Rear Property Line  
Nearest building  
Stream  
Percent Coverage

Actual  
100  
15  
-  
121  
-  
2

Minimum/Maximum Required  
35  
10  
-  
45  
10  
2

Are there any other structures on this tract of land? NE  
No. of single family dwellings \_\_\_\_\_ No. of manufactured homes \_\_\_\_\_  
Other (specify & number) \_\_\_\_\_

Does the property owner of this tract of land own any land that contains a manufactured home within five hundred feet of the tract listed above? Yes X No 2

I hereby CERTIFY that the information contained herein is true to the best of my knowledge; and by accepting this permit shall in every respect conform to the terms of this application and to the provisions of the Statutes and Ordinances regulating development in Harnett County. Any VIOLATION of the terms above stated immediately REVOKES this PERMIT. I further understand this structure is not to be occupied until a CERTIFICATE OF OCCUPANCY is issued. This permit expires six months from date issued.

[Signature]  
Landowner's Signature  
(Or Authorized Agent)

3-25-99  
Date

\*\*\*\*\*

FOR OFFICE USE ONLY

Copy of recorded final plat of subdivision on file? N

Is the lot/tract specified above in compliance with the Harnett County Subdivision Ordinance? -  
Watershed Ordinance? ✓  
Mobile Home Park Ord? -

ISSUED ✓ DENIED \_\_\_\_\_

Comments: \_\_\_\_\_  
\_\_\_\_\_  
\_\_\_\_\_

[Signature]  
Coning/Watershed Administrator

3-25-99  
Date





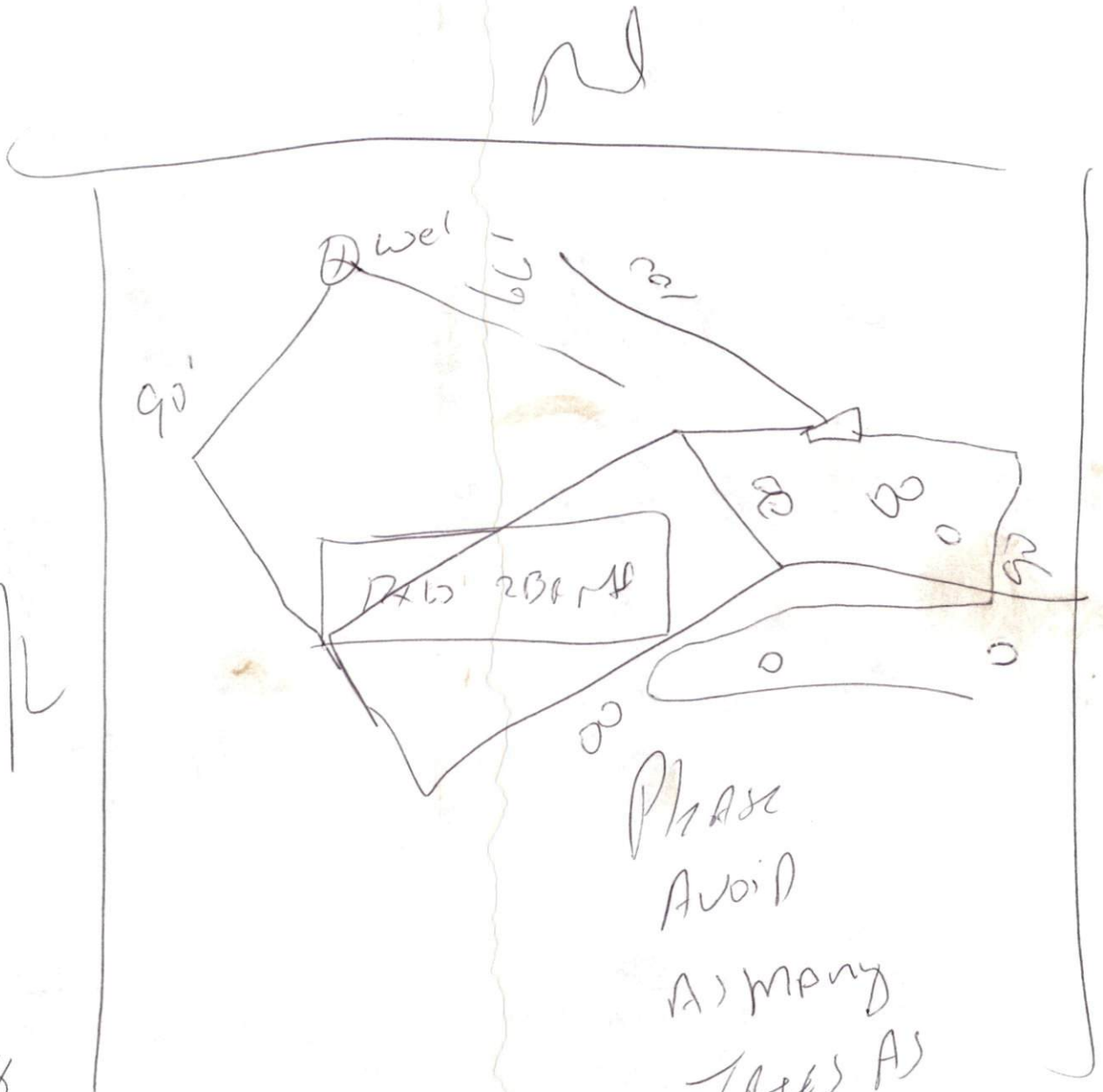

150x7  
 18.24  
 0-38  
 45  
 78 42  
 5 CL

Phase  
 Avoid  
 As many  
 Trees As  
 Poss. be