

HTE# Repair

# Harnett County Department of Public Health

PERMIT # 26170

## Operation Permit

21533

New Installation  Septic Tank  Nitrification Line  Repair  Expansion

PROPERTY LOCATION: 12638 NC 42 Hwy

Name: (owner) John E. Homan Duncan Junction SUBDIVISION \_\_\_\_\_ LOT # \_\_\_\_\_

System Installer: Tommy Coley Registration # \_\_\_\_\_

Basement with plumbing:  Garage  Number of Bedrooms 700 GPO

Type of Water Supply:  Community  Public  Well Distance from well: \_\_\_\_\_ feet

System Type: Existing III b Types V and VI Systems expire in 5 years.

(In accordance with Table V a)

Owner must contact Health Department 6 months prior to expiration for permit renewal.

This system has been installed in compliance with applicable North Carolina General Statutes, Rules for Sewage Treatment and Disposal, and all conditions of the Improvement Permit and Construction Authorization.

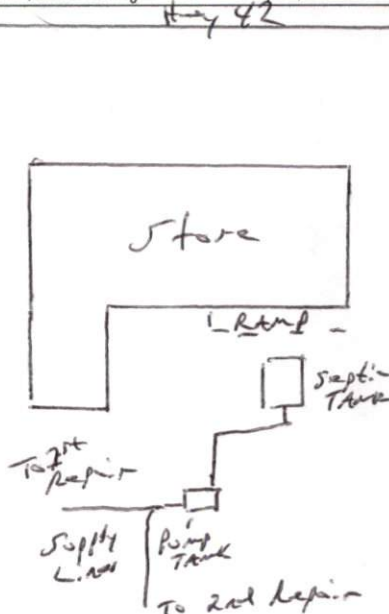

### PERMIT CONDITIONS:

- I. Performance: System shall perform in accordance with Rule .1961.
- II. Monitoring: As required by Rule .1961.
- III. Maintenance: As required by Rule .1961. Other: \_\_\_\_\_  
Subsurface system operator required? Yes  No   
If yes, see attached sheet for additional operation conditions, maintenance and reporting.

IV. Operation: \_\_\_\_\_  
 V. Other: \_\_\_\_\_

D-Box  Pump  Alarm  H2O Line  PWR Line

Following are the specifications for the sewage disposal system on the above captioned property.

Type of system:  Conventional  Other \_\_\_\_\_ Septic Tank: 1500 gallons Pump Tank: Existing gallons  
 Subsurface No. of \_\_\_\_\_ exact length \_\_\_\_\_ width of \_\_\_\_\_ depth of \_\_\_\_\_  
 Drainage Field ditches \_\_\_\_\_ of each ditch \_\_\_\_\_ feet ditches \_\_\_\_\_ feet ditches \_\_\_\_\_ inches  
 French Drain Required: \_\_\_\_\_ Linear feet

Authorized State Agent Ray McJin-REH Date 7/24/2010