

NETT COUNTY HEALTH DEPARTMENT  
 ENVIRONMENTAL HEALTH SECTION  
 307 CORNELIUS HARNETT BLVD.  
 LILLINGTON, N.C. 27546  
 910-893-7547 phone  
 910-893-9371 fax

APPLICATION FOR REPAIR

NAME Leon + Letha Davis PHONE # (home) 793-4079 PHONE # (work) \_\_\_\_\_  
 ADDRESS P.O. Box 214 physical / ( 844 Gregory Circle )  
Buies Creek, NC 27546 Addr -> Lillington  
 IF RENTING, LEASING ETC., LIST PROPERTY OWNER NAME \_\_\_\_\_  
 SUBDIVISION NAME \_\_\_\_\_ LOT# \_\_\_\_\_ STATE ROAD NAME AND # SR1521 Gregory Cir Tract 3 SIZE OF LOT OR TRACT \_\_\_\_\_

Type of dwelling  Modular  Mobile Home  Stick Built  Other \_\_\_\_\_  
 Number of bedrooms  1  2  3  4  or more - Basement with plumbing  Yes  No

Garage  Yes  No - Dishwasher  Yes  No - Garbage Disposal  Yes  No

Water Supply:  Private Well  Community System  County House use only  
*for use outside only*

Directions from Lillington to your site: Hwy 421 to Short Stop in B. Creek -  
(L) @ Stop - (L) @ traffic light - past school - turn  
(L) SR1521 Gregory Cir - go 1 mile House #844 on (R)

- In order for Environment Health to help you with your repair you will need to comply by doing the following:**
1. A surveyed and recorded map and deed to your property must be attached to this application along with a site plan showing (a) location of dwelling (b) location of driveway (c) location of any wells and other existing structures.
  2. The outlet end of the tank and distribution box will need to be uncovered and property lines marked. After the tank is uncovered, property lines are marked and orange sign has been placed, you will need to call us at 893-7547 or 893-7548 to let us know that it is ready.
  3. The system must be repaired within 30 days or the set time within receipt of a violation letter.

This certifies that all of the above information is correct to the best of my knowledge. False information will result in the denial of the permit. The permit is subject to revocation if the site plan, intended use, or ownership change.

Leon + Letha Davis 05-24-05  
 Signature Date

6/1/05(N)

# HOMEOWNER INTERVIEW FORM

It is important that you answer the following questions for our inspectors. Please do not leave any blanks if possible and answer all questions to the best of your ability. Thank you.

Have you received a letter for a failing septic system from our office? [ ] YES [  ] NO

Also, within the last 5 years have you completed an application for repair for this site? [ ] YES [  ] NO

Installer of system \_\_\_\_\_  
Septic Tank Pumper \_\_\_\_\_  
Designer of System \_\_\_\_\_

1. Number of people who live in house? 2 # adults \_\_\_\_\_ # children \_\_\_\_\_ # total \_\_\_\_\_
2. What is your average estimated daily water usage? \_\_\_\_\_ gallons/month or day \_\_\_\_\_ county water  
If HCPU please give the name that the water bill is listed in? \_\_\_\_\_
3. If you have a garbage disposal, how often is used? [ ] daily [ ] weekly [ ] monthly
4. When was the septic tank last pumped? \_\_\_\_\_ How often do you have it pumped? Once in 60 years
5. If you have a dishwasher, how often do you use it? [ ] daily [ ] every other day [  ] weekly <sup>12 x's</sup>
6. If you have a washing machine, how often do you use it? [ ] daily [  ] every other day [ ] weekly [ ] monthly
7. Do you have a water softener or treatment system? [ ] YES [  ] NO Where does it drain? \_\_\_\_\_
8. Do you use an "in tank" toilet bowl sanitizer? [ ] YES [  ] NO
9. Are you or any member in your family using long term prescription drug(s), antibiotics or chemotherapy?  
[ ] YES [  ] NO If yes, please list \_\_\_\_\_
10. Do you put household cleaning chemicals down the drain? [ ] YES [  ] NO If so, what kind? \_\_\_\_\_
11. Have you put any chemicals (paints, thinners, etc.) down the drain? [ ] YES [  ] NO  
If yes, what kind? \_\_\_\_\_
12. Have you installed any water fixtures since your system has been installed? [ ] YES [  ] NO If yes, please list  
any additions including any spas, whirlpools, sinks, lavatories, bath/showers, toilets. \_\_\_\_\_
13. Do you have an underground lawn watering system? [ ] YES [  ] NO
14. Has any work been done to your structure since your initial move, such a roof, gutter drains, basement  
foundation drains, landscaping, etc? [ ] YES [  ] NO If yes, please list \_\_\_\_\_
15. Are there any underground utilities on your lot? [ ] YES [ ] NO  
Please check all that apply [ ] Power [ ] Phone [ ] Cable [  ] Gas [  ] Water
16. Describe what is happening when you have problems with your septic system and when was it first  
noticed. Backing up, terrible odor - a hole was dug to  
open drain lines & now fills w/ water - may need new lines
17. Do you notice the problem as being patterned or linked to a specific event (i.e., wash clothes, heavy rains,  
household guests)? [ ] YES [  ] NO If yes, please list \_\_\_\_\_



Click on the Map to:

ZoomIn  ZoomOut  Recenter Map  Identify: **Tax Parcels**

Zoom Factor: **2X**  Radius Search (feet)

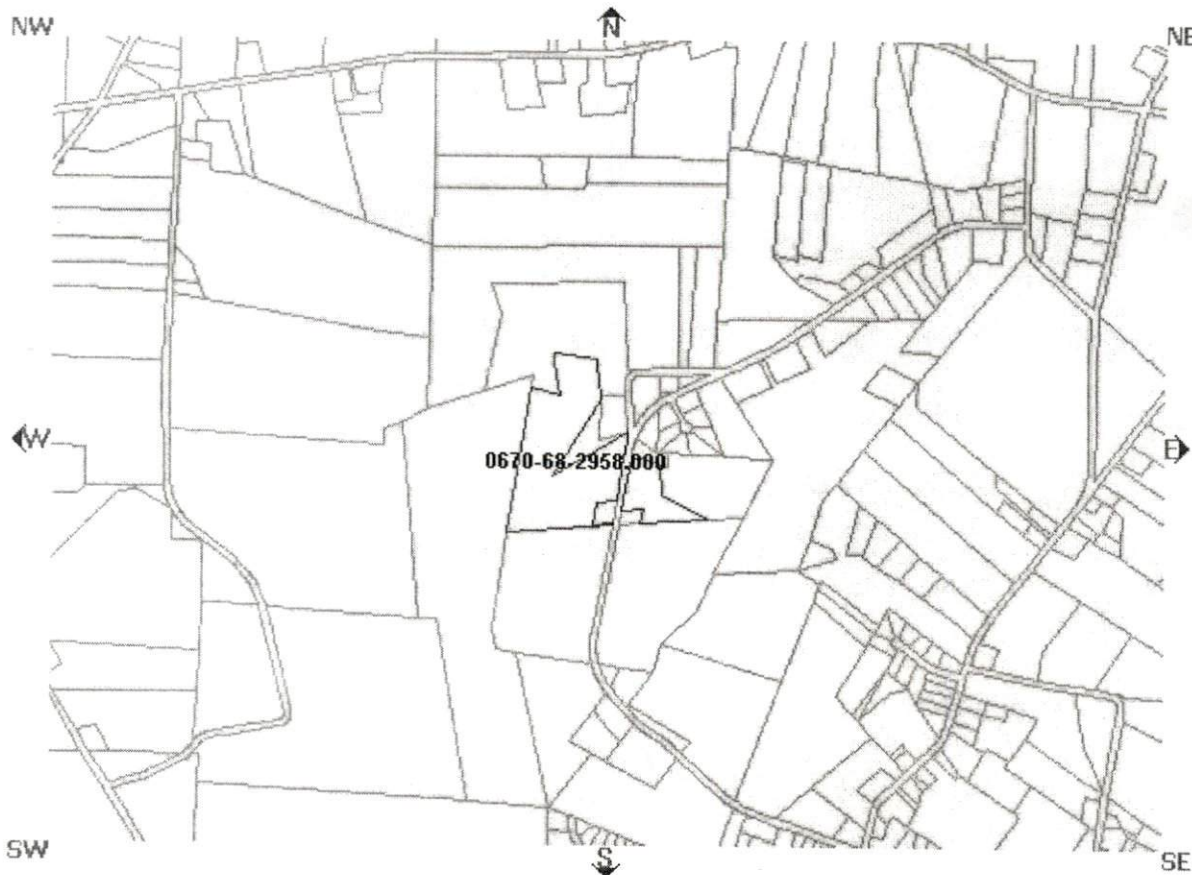

**Parcel Data**

Find Adjoining Parcels

<ul style="list-style-type: none"> <li>Account Number:001100230000</li> <li>Owner Name: DAVIS LEON E &amp;</li> <li>Owner/Address 1: DAVIS LETHA &amp;</li> <li>Owner/Address 2:</li> <li>Owner/Address 3: BOX 216</li> <li>City,State Zip: BUIES CREEK ,NC 275060000</li> <li>Commissioners District: 3</li> <li>Voting Precinct: 1102</li> <li>Census Tract: 1102</li> <li><u>Determine Flood Zone(s)</u></li> <li>In Town:</li> <li>Fire Ins. District: Buies Creek</li> <li>School District: 3</li> </ul>	<ul style="list-style-type: none"> <li>PIN: 0670-68-2958.000</li> <li>REID: 8505</li> <li>Parcel ID: 110579 0200</li> <li>Legal 1:27.75ACRES HOME PLACE</li> <li>Legal 2:</li> <li>Property Address: GREGORY (1521 NC SR) CR X</li> <li>Assessed Acres: 27.75AC</li> <li>Calculated Acres: 26.33</li> <li>Deed Book/Page: 00487/0019</li> <li>Deed Date: 00/00/00</li> <li>Sale Price: \$0.00</li> <li>Revenue Stamps: \$ . 0</li> <li>Year Built: 1939</li> </ul>
---	--

**Map Li**  
**Draw L**  
 Draw select  
**Boundary**  
 Townships  
 Tax Parcels  
 Aerial Phot 2002 \*\*  
 Aerial Phot \*\*  
 Fire Tax Di  
 Fire Insura Districts  
 Rescue Dis  
 Zoning  
**Governmen**  
 Commissio Districts  
 Voting Prec  
 Census Tra  
 School Dis  
**Infrastructu**  
 Major Road  
 Roads  
**Physical**  
 Soils  
  
 Rivers  
 Watershed  
 Flood Zone  
  
**Draw L**  
**MAP C**

This map is prep  
 inventory of real  
 within this jurisdic  
 compiled from re  
 plats, and other p  
 and data. Users c  
 hereby notified th  
 aforementioned p  
 information sourc  
 consulted for veri  
 information conta  
 map. The Harnet  
 mapping, and sol  
 companies assur  
 responsibility for  
 contained on this  
 website.  
 Data Effective De

NORTH CAROLINA,  
HARNETT COUNTY.

D E E D

THIS DEED, Made and entered into this first day of June, 1966,  
by and between LETHA GREGORY DAVIS, party of the first part, and  
LEON E. DAVIS and wife, LETHA GREGORY DAVIS, parties of the second  
part, all of Harnett County, North Carolina;

W I T N E S S E T H:

That the party of the first part, for and in consideration of  
the sum of ONE HUNDRED DOLLARS and other valuable consideration to  
her paid by the parties of the second part, the receipt of which is  
hereby acknowledged, has bargained and sold and by these presents  
does hereby give, grant, bargain, sell and convey unto the said  
parties of the second part, their heirs and assigns, those certain  
tracts or parcels of land, situate in Grove and Neill's Creek Town-  
ships, Harnett County, North Carolina, and more particularly described  
as follows:

FIRST TRACT:

Beginning at an iron stake corner with Waylon M. Gregory  
in line of James land and runs with said Gregory line  
South 80 degrees East 30 chains to iron stake corner in  
line of McLamb; thence line of McLamb South 5 degrees  
West 461 feet to iron stake corner with Lot No. 3 of  
Sherwood W. Gregory; thence line of said Gregory North  
80 degrees West 30 chains to iron stake corner in James  
land; thence North 5 degrees East 450 feet to beginning,  
containing 19.50 acres, more or less, and being Lot No.  
2 of Division of Denning 76 acre tract according to survey  
and map by Walter Lee Johnson, County Surveyor, dated  
April, 1954.

SECOND TRACT:

Beginning in Betts line, corner with Wilbur R. Gregory 14  
acres, and runs thence with line of said Gregory South 7  
degrees West 825 feet to iron stake corner with Waylon  
Gregory; thence with said Gregory South 76 degrees 30  
minutes East 212 feet to iron stake corner with Sherwood  
W. Gregory 4 acres; thence line of said Gregory 4 acres  
North 7 degrees East 825 feet to iron stake corner in  
line of Betts; thence Betts line North 76 degrees 30 minutes  
West 212 feet to beginning, containing 4 acres, more or less,

THIRD TRACT:

Beginning at an iron stake with pointers in line of Floyd Gregory, corner with Wilbur R. Gregory 20 acre tract No. 4, and runs thence with line of said Gregory North 58 degrees West 466 feet to iron stake corner; thence line of said Gregory North 3 degrees East 357 feet to corner with Sherwood W. Gregory; thence line of said Gregory Lot No. 3, North 51 degrees West 288 feet to iron stake gum pointers on west side of road; thence line of said Lot No. 4, South 64 degrees West 793 feet to iron stake corner in Pond Dam; thence line of Lot No. 4 North 38 degrees 30 minutes East 800 feet to iron stake corner; thence line of said Lot No. 4 North 5 degrees West 366 feet and North 81 degrees West 366 feet and South 5 degrees East 366 feet and North 72 degrees West 257 feet to iron stake, corner in line of Johnson Estate land; thence line of Johnson Estate land South 13 degrees 30 minutes West 1266 feet to iron and lightwood stake corner with Floyd Gregory, oak and hickory pointers; thence line of Floyd Gregory crossing road North 89 degrees 30 minutes East 1734 feet to the beginning, containing 30 acres, more or less, and being Lot No. 2 in division of Gregory Home Tract, according to Map and survey by Walter Lee Johnson, County Surveyor, dated April, 1954. See Book 356, Page 643, Harnett County Registry.

This deed is being given in order to create an estate by the entireties between the parties hereto.

TO HAVE AND TO HOLD the aforesaid tracts or parcels of land together with all privileges and appurtenances thereunto belonging unto the parties of the second part, their heirs and assigns, to their only use and behoof forever.

And the party of the first part for herself, her heirs, executors and administrators covenants with the parties of the second part, their heirs and assigns, that she is seized of said premises in fee and has the right to convey the same; that the same is free and clear from all encumbrances, and that she does hereby forever warrant and will forever defend the title to the same against the claims of all persons whomsoever.

IN WITNESS WHEREOF, the party of the first part has hereunto set her hand and seal the day and year first above written.

NORTH CAROLINA,  
HARNETT COUNTY.

*Ruby J. Currin asst.*  
I, ~~Elizabeth F. Matthews~~, Clerk of Superior Court of Harnett County, do hereby certify that Letha Gregory Davis, wife of Leon E. Davis, personally appeared before me this day and acknowledged the due execution of the foregoing deed of conveyance; and the said Letha Gregory Davis, being by me privately examined, separate and apart from her said husband, touching her voluntary execution of the same, does state that she signed the same freely and voluntarily, without fear or compulsion of her said husband or any other person, and that she does still voluntarily assent thereto.

And I do further certify that it has been made to appear to my satisfaction, and I do find as a fact, that the same is not unreasonable or injurious to her.

Witness my hand and official seal, this 1 day of June, 1966.

*Ruby J. Currin asst.*  
Elizabeth F. Matthews, Clerk  
of Harnett County Superior  
Court

Filed for registration at 1:30 o'clock P. M.  
June 1 1966 and registered in  
the Office of the Register of Deeds for Harnett  
County, in Book 487 Page 19  
June 1 1966  
*Jack Harrington*  
do Register of Deeds, Harnett County, N. C.  
Recorded and Verified \_\_\_\_\_