

IMPROVEMENT PERMIT

Be it ordained by the Harnett County Board of Health as follows: Section III, Item B. "No Person shall begin construction of any building at which a septic tank system is to be used for disposal of sewage without first obtaining a written permit from the Harnett County Health Department."

Name: (owner) Philip Inman

New Installation Septic Tank

Property Location: SR# 1201 Ponderosa

Repairs Nitrification Line

Subdivision Philip Inman Lot #

Tax ID # Quadrant #

Number of Bedrooms Proposed: 3 (28x60) Lot Size: 2.3 Ac

Basement with Plumbing: Garage: MUST use filter & marker
Water Supply: Well Public Community Do not Drive or park on system
Distance From Well: 50 min ft.

Following is the minimum specifications for sewage disposal system on above captioned property. Subject to final approval.

Type of system: Conventional Other

Size of tank: Septic Tank: 1000 gallons Pump Tank: gallons

Subsurface Drainage Field No. of ditches 1 exact length of each ditch 240 ft. width of ditches 3 ft. depth of ditches 18 ^{MAX} in.

French Drain Required: Linear feet

Date: 8-6-99

Signed: Jr Westers

Environmental Health Specialist

This permit is subject to revocation if site plans or intended use change.

Old Pond (Dry)

old Pond (Dry)

MUST meet on site
18" MAX Ditch Depth
Follow contour

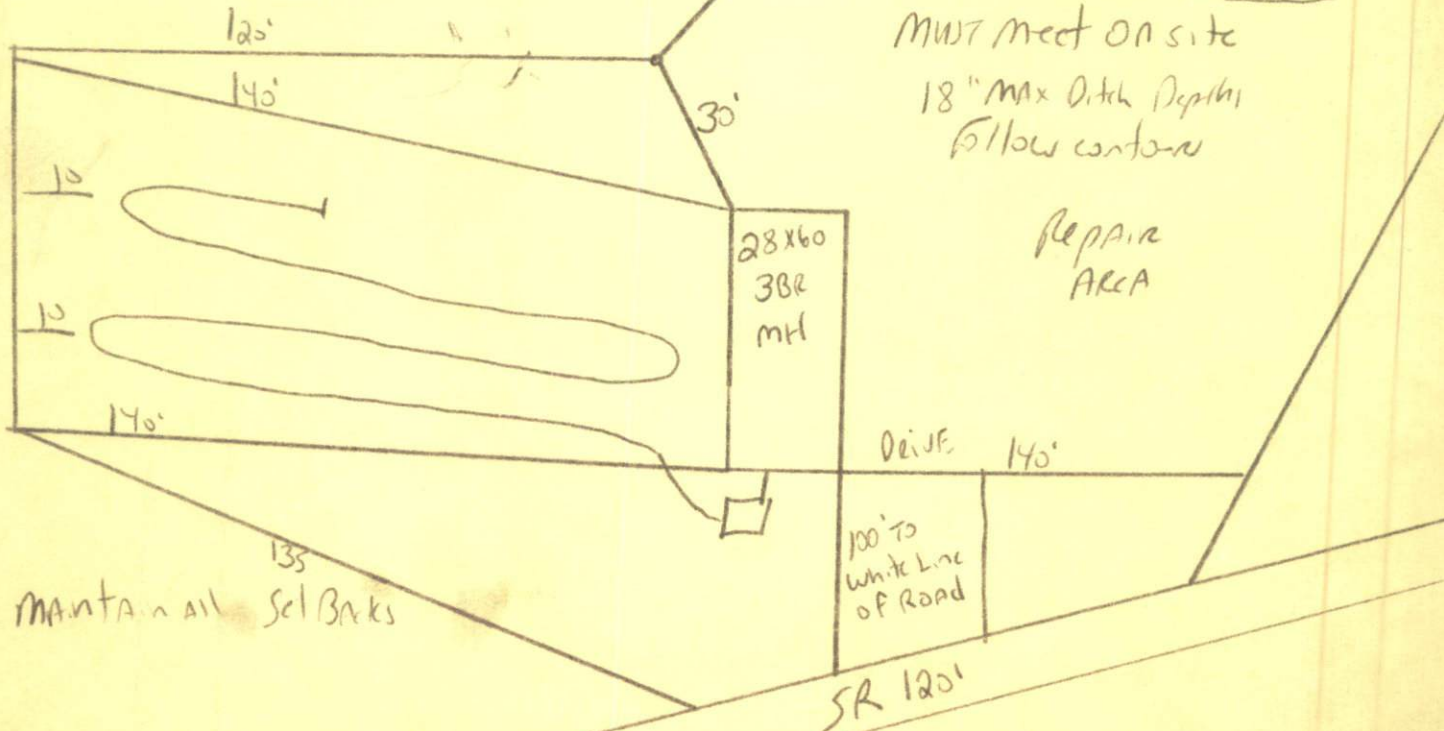

HARNETT COUNTY HEALTH DEPARTMENT
AUTHORIZATION TO CONSTRUCT

Authorization is hereby given to construct a wastewater system to the specifications described by Harnett County Health Department Improvement Permit # 16274. This authorization shall be valid for a period not to exceed five (5) years from the date of issuance. This authorization will be invalid if ownership, site plans, or intended use change.

Owner or Authorized Agent Philip Inman

Name: _____ Telephone # _____

Address: _____

Property Location: SR # 1201 Road Name _____

New Installation Repair _____ Septic Tank Nitrification Lines

Subdivision Philip Inman Lot # _____

Number of Bedrooms Proposed: 3 (28x60) Lot size: 2.3 AC

Basement _____ With Plumbing _____ Without Plumbing _____

Water Supply: Well _____ Public Minimum Well Setback: _____ ft.

Type of System: Conventional Other _____

Tank Volume: Septic Tank 1000 gallons Pump Chamber _____ gallons

Nitrification Field Specifications

Number of fields 1 Number of Lines per Field 1 Length of lines 240

Width of ditches 3 ft. Depth of ditches 18 inches

French Drain: Linear feet required _____ Depth of gravel _____

No wastewater system shall be covered or placed into use by any person until an inspection by the Harnett County Health Department has determined that the system has been installed according to the conditions of the improvement permit and that a valid operations permit has been issued.

Authorized Agent for Harnett County Health Department

Name: [Signature] Date: 8-6-99