

# SANITARY SEWAGE SYSTEM

OWNER: Gullikson PHONE: \_\_\_\_\_ DATE REQUESTED: \_\_\_\_\_ DATE EVALUATED: \_\_\_\_\_  
 ADDRESS: \_\_\_\_\_ PROPERTY IDENTIFICATION NO.: \_\_\_\_\_  
 COUNTY: \_\_\_\_\_ PROPERTY SIZE: \_\_\_\_\_ PROPOSED FACILITY: \_\_\_\_\_  
 LOCATION OF SITE: \_\_\_\_\_  
 WATER SUPPLY: On-Site Well \_\_\_\_\_ Community \_\_\_\_\_ Public \_\_\_\_\_ EVALUATION BY: Auger Boring \_\_\_\_\_ Pit \_\_\_\_\_ Cut \_\_\_\_\_

LANDSCAPE POSITION	Group	TEXTURE	App. Rate	MOIST	CONSISTENCE	WET	STRUCTURE	MINERALOGY
R - Ridge	I	s - sand	1.2-0.8	vfr - very friable	fr - friable	Ns - non-sticky	sg - single grain	1:1, 2:1, mixed
S - Shoulder slope		ls - loamy sand						
L - Unear slope	II	sl - sandy loam	0.8-0.6	fl - firm	ff - firm	Ss - slightly sticky	cr - crumb	
FS - Foot slope		l - loam						
N - Nose slope	III	sil - silt	0.6-0.3	vfl - very firm	sll - silt loam	S - sticky	gr - granular	
H - Head slope		sil - silt loam						
Cc - Concave slope	IV	sicl - silty clay loam	0.4-0.1	sll - extremely firm	scl - sandy clay loam	Vs - very sticky	sbk - subangular blocky	
Cv - Convex slope		cl - clay loam						
T - Terrace		scl - sandy clay loam						
FP - Flood Plain		sc - sandy clay				Np - non-plastic	pl - platy	
		slc - silty clay				Sp - slightly plastic	pr - prismatic	
		c - clay				P - plastic		
						Vp - very plastic		

Use the above standard abbreviations.

- NOTES:**
- Horizon Depth - in inches
  - Depth of Fill - in inches from land surface
  - Restrictive Horizon - thickness and inches from land surface
  - Saprolite - S (suitable) or U (unsuitable)
- DHS 2601 (Revised \_\_\_\_\_)  
 Sanitation Branch (Review \_\_\_\_\_)

- NOTES:**
- Soil Wetness - inches from land surface to free water or inches from land surface to soil colors with chroma 2 or less - record Munsell color chip designation
  - Classification - S (suitable), PS (provisionally suitable) or U (unsuitable)
  - Long-Term Acceptance Rate - gal/day/ft<sup>2</sup>

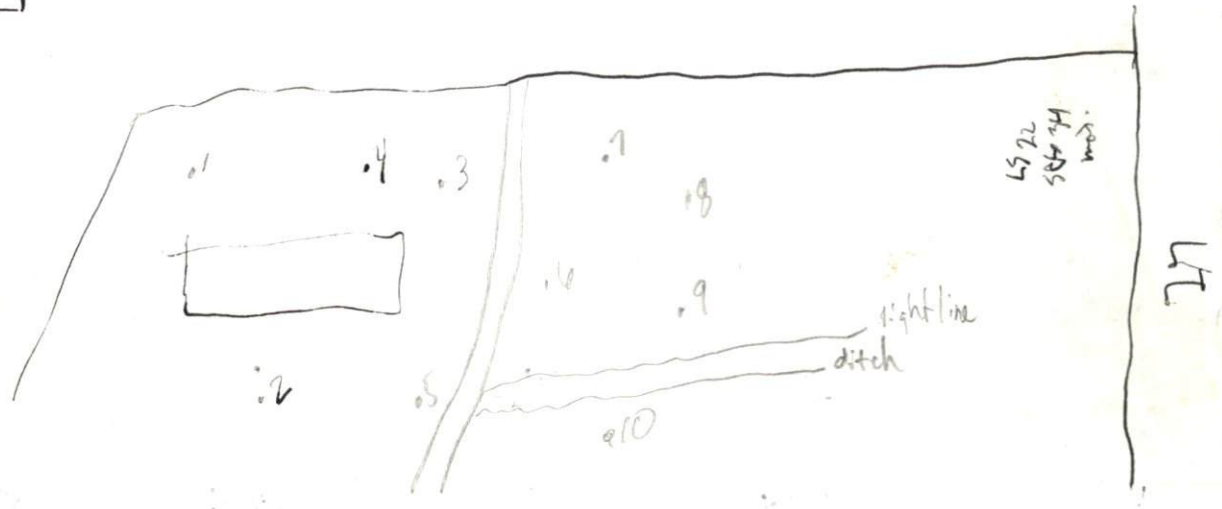

FACTORS	PROFILE 1	PROFILE 2	PROFILE 3	PROFILE 4	PROFILE 5
LANDSCAPE POSITION	Cc	H	H	H	
SLOPE (%)	0-3	0-3	0-3		
HORIZON I DEPTH	0-32	0-42	0-12	0-36	8-0 fill
Texture Group	LS	LS	LS	LS	LS
Consistence	L	L	L	L	L
Structure	qr	qr	qr	qr	qr
Mineralogy	1:1	1:1	1:1	1:1	1:1
HORIZON II DEPTH			12-36	26-32	8-70
Texture Group			SCL	SL	SL
Consistence			fr	fr	fr
Structure			Sbk	Sbk	cr
Mineralogy			1:1	1:1	1:1
HORIZON III DEPTH				32-42	20-36
Texture Group				SCL	LS
Consistence				fr	fr
Structure				Sbk	cr
Mineralogy				1:1	1:1
HORIZON IV DEPTH					
Texture Group					
Consistence					
Structure					
Mineralogy					
SOIL WETNESS	32"	> 42	36	> 42	36
RESTRICTIVE HORIZON					
SAPROLITE					
CLASSIFICATION					
LONG-TERM ACCEPTANCE RATE		.8	.5	.5	.8

FACTORS	PROFILE 1	PROFILE 2	PROFILE 3	PROFILE 4	PROFILE 5
LANDSCAPE POSITION	L	L			
SLOPE (%)	2-6				
HORIZON I DEPTH	0-18	0-10	0-12	0-18	0-20
Texture Group	SL	SL	SL	SL	SL
Consistence	fr	fr	fr	fr	fr
Structure	cr	cr	cr	cr	cr
Mineralogy	1:1	1:1	1:1	1:1	1:1
HORIZON II DEPTH	18-24	10-16	12-26	18-24	20-38
Texture Group	SCL	SCL	SL	SL	SL
Consistence	fr	fr	fr	fr	fr
Structure	Sbk	Sbk	Sbk	Sbk	Sbk
Mineralogy	1:1	1:1	1:1	1:1	1:1
HORIZON III DEPTH	24-36	16-30			
Texture Group	SL	SL			
Consistence	fr	fr			
Structure	Sbk	Sbk			
Mineralogy	1:1	1:1			
HORIZON IV DEPTH					
Texture Group					
Consistence					
Structure					
Mineralogy					
SOIL WETNESS	34	18	26	28	38
RESTRICTIVE HORIZON					
SAPROLITE					
CLASSIFICATION					
LONG-TERM ACCEPTANCE RATE	.4				.4

SITE CLASSIFICATION: \_\_\_\_\_ SITE LONG-TERM ACCEPTANCE RATE: \_\_\_\_\_  
 EVALUATED BY: \_\_\_\_\_ OTHER(S) PRESENT: \_\_\_\_\_  
 REMARKS: \_\_\_\_\_  
 \_\_\_\_\_  
 \_\_\_\_\_