

SOIL/SITE EVALUATION

for ON-SITE WASTEWATER SYSTEM

OWNER: Lester Chalmers APPLICANT: Ervin Dailey
 ADDRESS: Cameron NC APPLICATION DATE: 10/18/96 DATE EVALUATED: 1-5-97
 PROPOSED FACILITY: Dw mH PROPOSED DESIGN FLOW (.1949): _____ PROPERTY SIZE: 1.76 AC.
 LOCATION OF SITE: Hwy 27 PROPERTY RECORDED: _____
 WATER SUPPLY: Private Public Well Spring Other _____
 EVALUATION METHOD: Auger Boring Pit Cut _____
 TYPE OF WASTEWATER: Sewage Industrial Process Mixed _____

P R O F I L E #	.1940 LAND- SCAPE POSITION/ SLOPE %	HORI- ZON DEPTH (IN.)	SOIL MORPHOLOGY (.1941)		OTHER PROFILE FACTORS				PROFILE CLASS & LTAR
			.1941 STRUCTURE/ TEXTURE	.1941 CONSISTENCE/ MINERALOGY	.1942 SOIL WETNESS/ COLOR	.1943 SOIL DEPTH	.1956 SAPRO CLASS	.1944 RESTR HORIZ	
1	L	0-48	LS ₂ SL	VFR	cr ^c 34"				PS .8
2	L	0-24	LS	VFR	cr ^c at 36"				PS .7
		24-36	SL	VFR					
3	L	0-24	LS	VFR	cr ^c 40"				PS .8
		24-36	SL	VFR					
4									

DESCRIPTION	INITIAL SYSTEM	REPAIR SYSTEM	OTHER FACTORS (.1946):
Available Space (.1945)	OK	OK	SITE CLASSIFICATION (.1948): <u>PS</u>
System Type(s)	CONV.	CONV.	EVALUATED BY: <u>JFF Eudy</u>
Site LTAR	.8	.8+.7	OTHER(S) PRESENT: _____

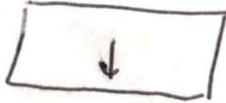

① SLT-85
C=2 28"

② CS 0-24
SL 24-36
C=2 36"

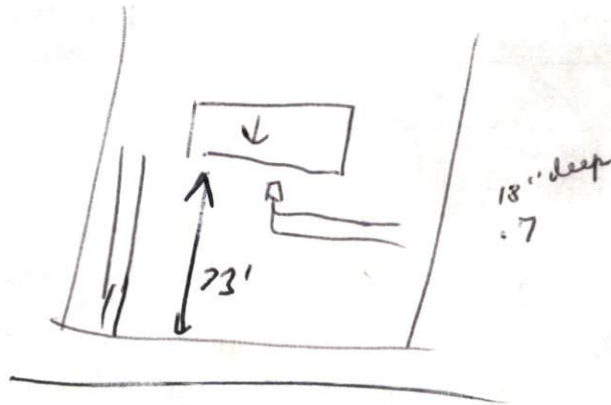

87

SETBACK REQUIREMENTS

Front property line
Side property line
Corner side line
Rear Property Line
Nearest building
Stream
Percent Coverage

Actual

40
85

250

Minimum/Maximum Required

35
10
15
25
10

Are there any other structures on this tract of land? NO
No. of single family dwellings None No. of manufactured homes none
Other (specify & number) _____

Does the property owner of this tract of land own any land that contains a manufactured home within five hundred feet of the tract listed above? Yes _____ No

I hereby CERTIFY that the information contained herein is true to the best of my knowledge; and by accepting this permit shall in every respect conform to the terms of this application and to the provisions of the Statutes and Ordinances regulating development in Harnett County. Any VIOLATION of the terms above stated immediately REVOKES this PERMIT. I further understand this structure is not to be occupied until a CERTIFICATE OF OCCUPANCY is issued. This permit expires six months from date issued.

Lester D. Chalmer
Landowner's Signature
(Or Authorized Agent)

10-17-96
Date

FOR OFFICE USE ONLY

Copy of recorded final plat of subdivision on file? no (not req)

Is the lot/tract specified above in compliance with the Harnett County Subdivision Ordinance?
Watershed Ordinance?
Mobile Home Park Ord?

ISSUED _____ DENIED _____

Comments: _____

Tom [Signature]
Zoning/Watershed Administrator

10-18-96
Date