

HTE# Repair

# Harnett County Department of Public Health

27995

## Improvement Permit

A building permit cannot be issued with only an Improvement Permit

ISSUED TO: Wayne Barbour PROPERTY LOCATION: 1233 Bud Hawkins Rd  
 SUBDIVISION \_\_\_\_\_ LOT # \_\_\_\_\_  
 NEW  REPAIR  EXPANSION  Site Improvements required prior to Construction Authorization Issuance: \_\_\_\_\_  
 Type of Structure: Existing SFD  
 Proposed Wastewater System Type: Existing  
 Projected Daily Flow: 360 GPD  
 Number of bedrooms: 3 Number of Occupants: 6 max  
 Basement  Yes  No  
 Pump Required:  Yes  No  May be required based on final location and elevations of facilities  
 Type of Water Supply:  Community  Public  Well Distance from well \_\_\_\_\_ feet Permit valid for:  Five years  
 Permit conditions: \_\_\_\_\_  No expiration

Authorized State Agent: Bryan McSwain, RCHS Date: 8/25/2014 SEE ATTACHED SITE SKETCH

The issuance of this permit by the Health Department in no way guarantees the issuance of other permits. The permit holder is responsible for checking with appropriate governing bodies in meeting their requirements. This site is subject to revocation if the site plan, plat, or the intended use changes. The Improvement Permit shall not be affected by a change in ownership of the site. This permit is subject to compliance with the provisions of the Laws and Rules for Sewage Treatment and Disposal and to conditions of this permit.

## Construction Authorization

(Required for Building Permit)

The construction and installation requirements of Rules .1950, .1952, .1954, .1955, .1956, .1957, .1958, and .1959 are incorporated by references into this permit and shall be met. Systems shall be installed in accordance with the attached system layout.

ISSUED TO: Wayne Barbour PROPERTY LOCATION: 1233 Bud Hawkins Rd  
 SUBDIVISION \_\_\_\_\_ LOT # \_\_\_\_\_  
 Facility Type: SFD  New  Expansion  Repair  
 Basement?  Yes  No Basement Fixtures?  Yes  No  
 Type of Wastewater System\*\* \_\_\_\_\_ (Initial) Wastewater Flow: 360 GPD  
 (See note below, if applicable )

(Repair)  
Installation Requirements/Conditions  
 Septic Tank Size 1000 gallons Number of trenches Existing  
 Pump Tank Size \_\_\_\_\_ gallons Exact length of each trench \_\_\_\_\_ feet Trench Spacing: \_\_\_\_\_ Feet on Center  
 Trenches shall be installed on contour at a \_\_\_\_\_ Soil Cover: \_\_\_\_\_ inches  
 Maximum Trench Depth of: \_\_\_\_\_ inches (Maximum soil cover shall not exceed  
 (Trench bottoms shall be level to  $\pm 1/4"$  36" above the trench bottom)  
 in all directions)

Pump Requirements: \_\_\_\_\_ ft. TDH vs. \_\_\_\_\_ GPM Aggregate Depth: \_\_\_\_\_ inches below pipe  
 \_\_\_\_\_ inches above pipe  
 \_\_\_\_\_ inches total

Conditions: Pump out + crush in place old tank. Set new tank where plumbing + existing drainfield can be tied into

**WATER LINES (INCLUDING IRRIGATION) MUST BE 10FT. FROM ANY PART OF SEPTIC SYSTEM OR REPAIR AREA.  
 NO UTILITIES ALLOWED IN INITIAL OR REPAIR DRAIN FIELD AREA.**

\*\*If applicable: I understand the system type specified is different from the type specified on the application. I accept the specifications of this permit.

Owner/Legal Representative Signature: \_\_\_\_\_ Date: \_\_\_\_\_

This Construction Authorization is subject to revocation if the site plan, plat, or the intended use changes. The Construction Authorization shall not be transferred when there is a change in ownership of the site. This Construction Authorization is subject to compliance with the provisions of the Laws and Rules for Sewage Treatment and Disposal and to the conditions of this permit. SEE ATTACHED SITE SKETCH

Authorized State Agent: Bryan McSwain, RCHS Date: 8/25/2014  
 Construction Authorization Expiration Date: 8/25/2019

HTE# Repair

Permit # 27995

# Harnett County Department of Public Health Site Sketch

ISSUED TO: Wayne Barbour PROPERTY LOCATOR: 1237 Bud Hawkins Rd  
SUBDIVISION \_\_\_\_\_ LOT # \_\_\_\_\_

Authorized State Agent: Debra McLean, RCHS Date: 8/25/2014

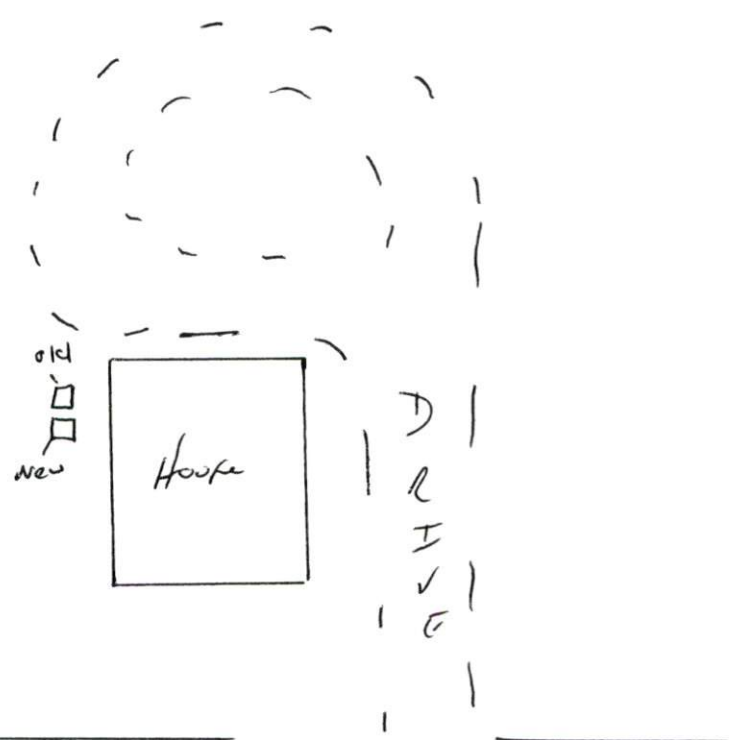

Bud Hawkins Rd.