

# HARNETT COUNTY HEALTH DEPARTMENT IMPROVEMENT PERMIT

No 16646  
011111

Be it ordained by the Harnett County Board of Health as follows: Section III, Item B. "No Person shall begin construction of any building at which a septic tank system is to be used for disposal of sewage without first obtaining a written permit from the Harnett County Health Department."

Name: (owner) Johnny Faircloth  New Installation  Septic Tank  
 Property Location: SR# 1270 Hollys Pine  Repairs  Nitrification Line

Subdivision Hollys Pine Lot # 1

Tax ID # 72000 Quadrant # \_\_\_\_\_

Number of Bedrooms Proposed: 3 (14x7) Existing Lot Size: 60 AC

Basement with Plumbing:  Garage:  MUST USE filter & septic tank muck  
 Water Supply:  Well  Public  Community  
 Distance From Well: 50 ft.

**Following is the minimum specifications for sewage disposal system on above captioned property. Subject to final approval.**

Type of system:  Conventional  Other \_\_\_\_\_

Size of tank: Septic Tank: 1000 gallons Pump Tank: \_\_\_\_\_ gallons

Subsurface Drainage Field No. of ditches 1 exact length of each ditch 480 ft. width of ditches 3 ft. depth of ditches 18 in.

French Drain Required: \_\_\_\_\_ Linear feet

Date: 12-22-99

**This permit is subject to revocation if site plans or intended use change.**  
 Signed: [Signature]  
 Environmental Health Specialist

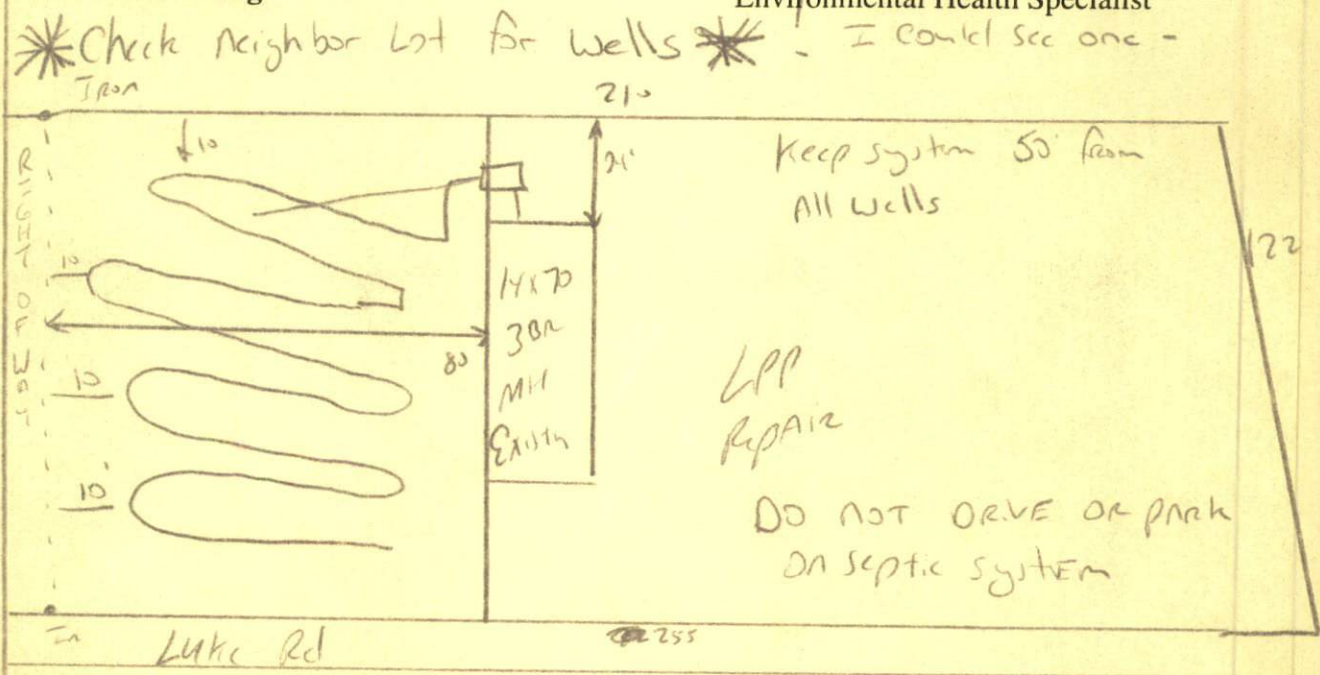

MUST meet onsite - 18' max Ditch Depth follow contours  
 MAINTAIN All Set Backs - MUST Re Route Water Line - keep 10' from septic system

# AUTHORIZATION TO CONSTRUCT

Authorization is hereby given to construct a wastewater system to the specifications described by Harnett County Health Department Improvement Permit # 16646. This authorization shall be valid for a period not to exceed five (5) years from the date of issuance. This authorization will be invalid if ownership, site plans, or intended use change.

Owner or Authorized Agent Johnny Farber

Name: \_\_\_\_\_ Telephone # \_\_\_\_\_

Address: \_\_\_\_\_

Property Location: SR # 1270 Road Name \_\_\_\_\_

New Installation  Repair \_\_\_\_\_ Septic Tank  Nitrification Lines

Subdivision Hollis Pine Lot # 1

Number of Bedrooms Proposed: 3 (14x70) <sup>Existing</sup> Lot size: 60 AC

Basement \_\_\_\_\_ With Plumbing \_\_\_\_\_ Without Plumbing \_\_\_\_\_

Water Supply: Well \_\_\_\_\_ Public  Minimum Well Setback: 50 ft.

Type of System: Conventional  Other \_\_\_\_\_

Tank Volume: Septic Tank 1000 gallons Pump Chamber \_\_\_\_\_ gallons

### Nitrification Field Specifications

Number of fields 1 Number of Lines per Field 1 Length of lines 480

Width of ditches 3 ft. Depth of ditches 18 inches

French Drain: Linear feet required \_\_\_\_\_ Depth of gravel \_\_\_\_\_

No wastewater system shall be covered or placed into use by any person until an inspection by the Harnett County Health Department has determined that the system has been installed according to the conditions of the improvement permit and that a valid operations permit has been issued.

Authorized Agent for Harnett County Health Department

Name: Jon West Date: 12.20.99