

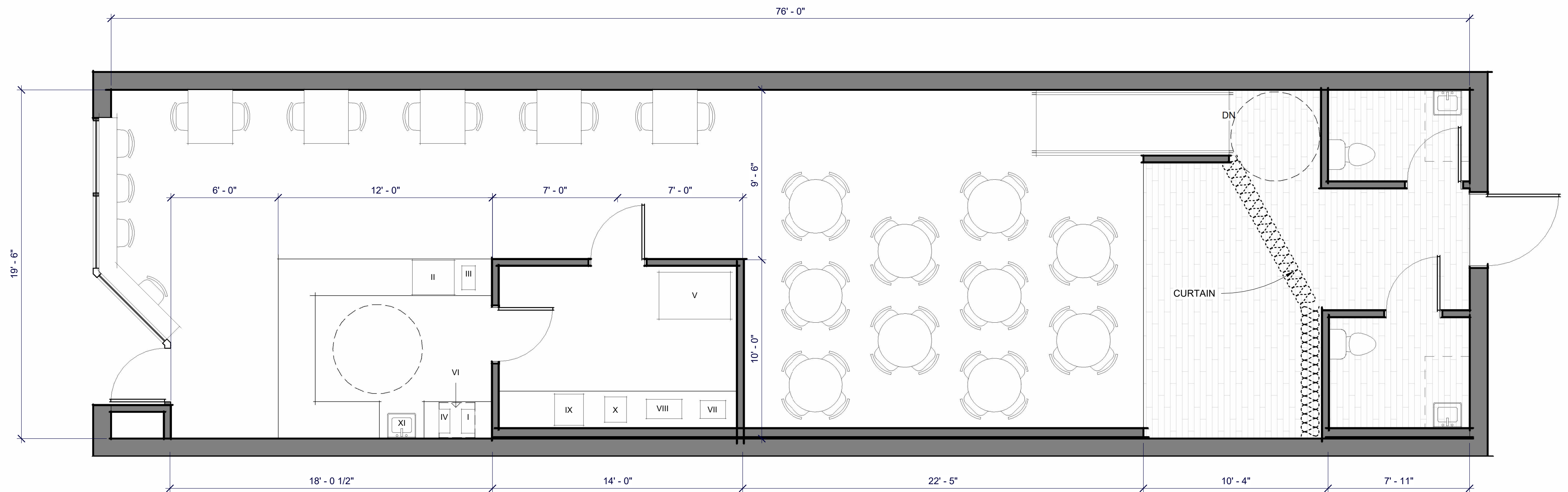

DUMPSTER LOCATION

- Equipment List**
- I. Commercial Drip Brewer (Moccamaster)**  
<https://us.moccamaster.com/collections/cafes-office-brewers/products/cdt>
  - II. Espresso Machine 2 Group (La Marzocco Linea Classic S AV Automatic)**  
<https://www.voltagerestaurantsupply.com/products/la-marzocco-linea-classic-s-esspressomachine>
  - III. Commercial Grinder (Espresso)**  
<https://www.voltagerestaurantsupply.com/collections/mazzer-super-jolly-grinders/products/mazzer-super-jolly-v-pro-electronic>
  - IV. Commercial Bulk Grinder**  
<https://www.voltagerestaurantsupply.com/collections/bunn-coffee-grinders/products/bunn-g2-22102-0000>
  - V. Commercial Refrigerator/Freezer**  
[https://www.amazon.com/WESTLAKE-Commercial-Refrigerator-Stainless-Restuarant/dp/B0B8H63N2/ref=sr\\_1\\_5?keywords=commercial%2Brefrigerator%2Bfreezer&qid=1681574610&mid=244274660\\_11&s=industrial&sr=1-5&ufe=app\\_do%3Aamazon1.fos.17126c18-b61b-4ce9-8a28-de351141c1fb&th=1](https://www.amazon.com/WESTLAKE-Commercial-Refrigerator-Stainless-Restuarant/dp/B0B8H63N2/ref=sr_1_5?keywords=commercial%2Brefrigerator%2Bfreezer&qid=1681574610&mid=244274660_11&s=industrial&sr=1-5&ufe=app_do%3Aamazon1.fos.17126c18-b61b-4ce9-8a28-de351141c1fb&th=1)
  - VI. Under Counter Refrigerator**  
<https://www.katom.com/162-FF7BSSTBADA.html>
  - VII. Panini Press**  
<https://www.webstaurantstore.com/avantco-p70s-smooth-commercial-panini-sandwichgrill-13-x-8-3-4-cooking-surface-120v-1750w/177P70S.html>
  - VIII. Hot Plate**  
<https://www.webstaurantstore.com/avantco-177eb202bsm-double-burner-solid-top-stainless-steel-portable-electric-side-by-side-hot-plate-3-000w-240v/177EB202BSM.html>
  - IX. Waffle Maker**  
<https://www.webstaurantstore.com/carnival-king-wbm26dgt-non-stick-double-belgian-waffle-maker-with-digital-timer-and-temperature-controls-120v/382WBM26DGT.html>
  - X. Conveyor Toaster**  
<https://www.webstaurantstore.com/avatoast-1140-conveyor-toaster-with-3-opening-120v-formerly-avantco-t140/184T140.html>
  - XI. Hand Wash Sink**



FLOOR PLAN - OPTION A 1  
 1/4" = 1'-0"

