

### Equipment List

<b>A</b>	Chargrill	Avantco-CAG24RC
<b>B</b>	Flat top	4 burner-Cookright AGR-4B36G
<b>C</b>	Fryer X3	CookRight-ATFS-40
<b>D</b>	Cooler	Dukers-DUC72R
<b>E</b>	Stand up cooler	Dukers-DUC48F
<b>F</b>	Freezer	Dukers-DUC48F
<b>G</b>	Hotwell X3	Galaxy-177GWC50E
<b>H</b>	Sandwich Cooker	Dukers-DSP48
<b>I</b>	Dish Machine	Ecolab-ES-2000
<b>J</b>	Pepsi	2323 Drop in
<b>K</b>	Pepsi	FTN Bar Icewell 2123
<b>L</b>	Pepsi	FTN Bar Can 14
<b>M</b>	Pepsi	Team URN No Carb
<b>N</b>	True TD	TD-80-30
<b>O</b>	IDW Stand up Cooler	G26c-GCG2GC
<b>P</b>	Hoshizaki Ice Machine	KM-350-MAJ
<b>Q</b>	Microwave	Galaxy-MW1000PB
<b>R</b>	3 Bay Sink	Regency 70" 16 Gauge Through Capacity 14"x16"x12" Bowl with two Drain Boards
<b>S</b>	Prep Sink	Regency 16 Gauge 20"x23"x17"
<b>T</b>	Food Processor	Warning-WFP145W 3.5 Qt

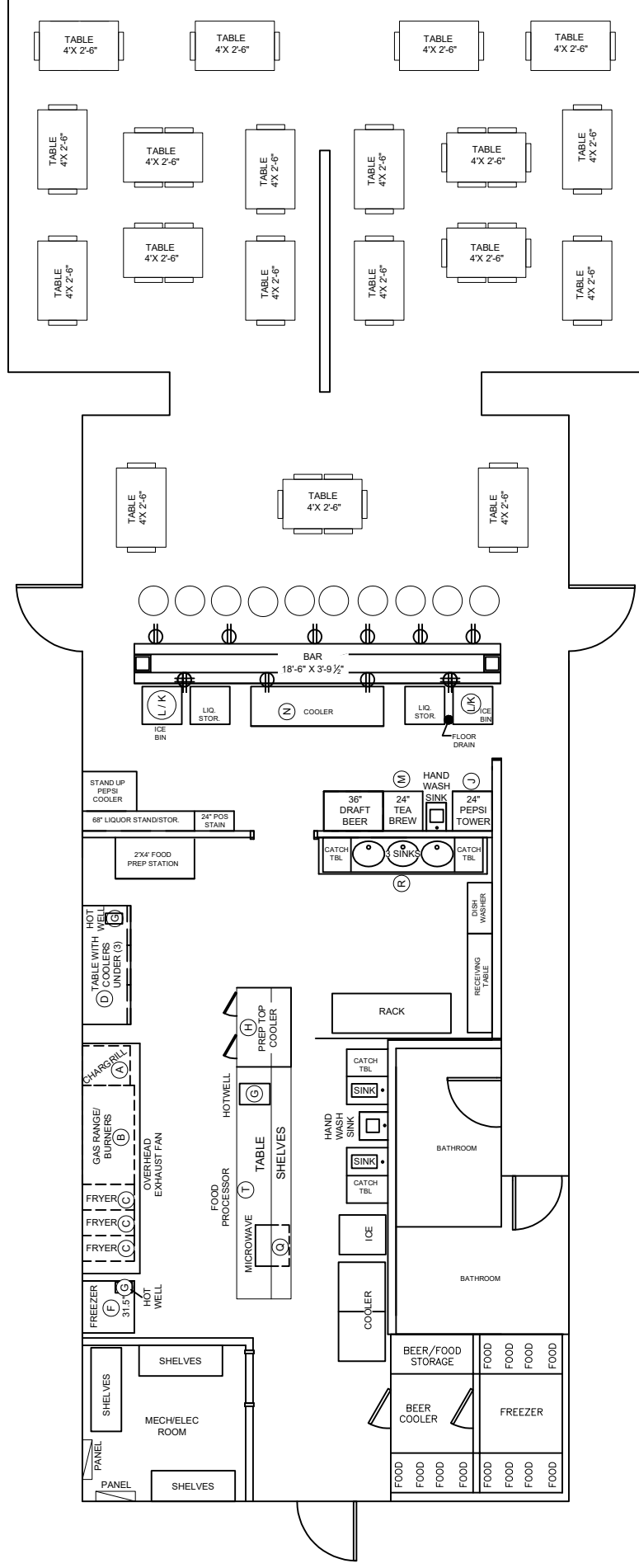

# KICKING CAMEL

PLAN

SCALE: 1/8" = 1'-0"

FOR  
**KICKING CAMEL**  
 174 N McKinley St, Coats