

Central Carolina Soil Consulting, PLLC

1900 South Main Street, Suite 110

Wake Forest, NC 27587

919-569-6704

September 18, 2025

October 29, 2025

Job # 3806

DRB Group
Christian St. James
1101 Slater Road
Suite 300
Durham, NC 27703

RE: Site meeting at lot 31, Honeycutt Hills SD, Harnett County, NC.

Dear Mr. James:

Central Carolina Soil Consulting, PLLC met with you and others from DRB Group at lot 31 in Honeycutt Hills SD due to previous effluent surfacing on the lot. Per the Construction Authorization completed by the Harnett County HD, the lot has a daily flow rate of 480 gal/day (4-bedroom) with a horizontal panel block drainfield. The system is pressure dosed with serial distribution (using drop boxes per paperwork provided). No effluent was surfacing on the date of the site meeting (8-19-25), although areas in the front yard showed evidence of previous effluent surfacing.

Central Carolina Soil recommends to install a manifold box with taps (see tap chart) to feed some of the lines individually to better disperse the effluent (with the exception of lines 1-2 (20' & 40') & 3-4 (55' & 70') keep those step-downs). Additionally, the current control panel shall be replaced with an Aquaworx control panel to control the dosing of the system. The flow shall be split between 4 cycles per day (every 4 hours) away from a larger demand dose system. Water records need to be taken on the lot to ensure the system is not being over loaded based on the daily flow rate.

These proposed changes to the wastewater system need to be reviewed and have a permit issued by the Harnett County HD before installation. The recommended changes do not guarantee a fix to wastewater system, rather best professional judgement by CCSC. No soils work was completed on lot 31 on 8-19-25.

If you have any questions regarding the findings on the attached map or in this report, please feel free contact me at anytime. Thank you allowing Central Carolina Soil Consulting to perform this site evaluation for you.

Sincerely,

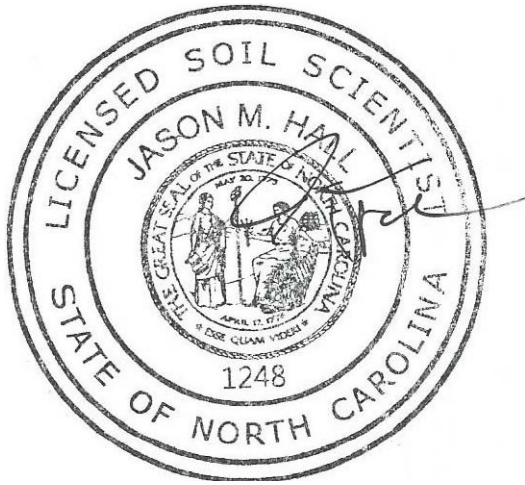

Jason Hall
NC Licensed Soil Scientist #1248
AOWE # 10004

Encl: tap chart, County Permit

Harnett County Department of Public Health

PERMIT # SFD 2406-0035

Operation Permit

☐ New Installation ☐ Septic Tank ☐ Nitrification Line ☐ Repair ☐ Expansion

PROPERTY LOCATION: 362 Adams Pointe CT (SR 1362)

Name: (owner) DRB Group

SUBDIVISION Honey Creek Hills

LOT # 31

System Installer: C + M

Basement with plumbing: ☐ Garage ☒ Number of Bedrooms 4 (8 people)

Type of Water Supply: ☐ Community ☒ Public ☐ Well Distance from well _____ feet

System Type: TYPE III B Types V and VI Systems expire in 5 years.

(In accordance with Table V a)

Owner must contact Health Department 6 months prior to expiration for permit renewal.

This system has been installed in compliance with applicable North Carolina General Statutes, Rules for Sewage Treatment and Disposal, and all conditions of the Improvement Permit and Construction Authorization.

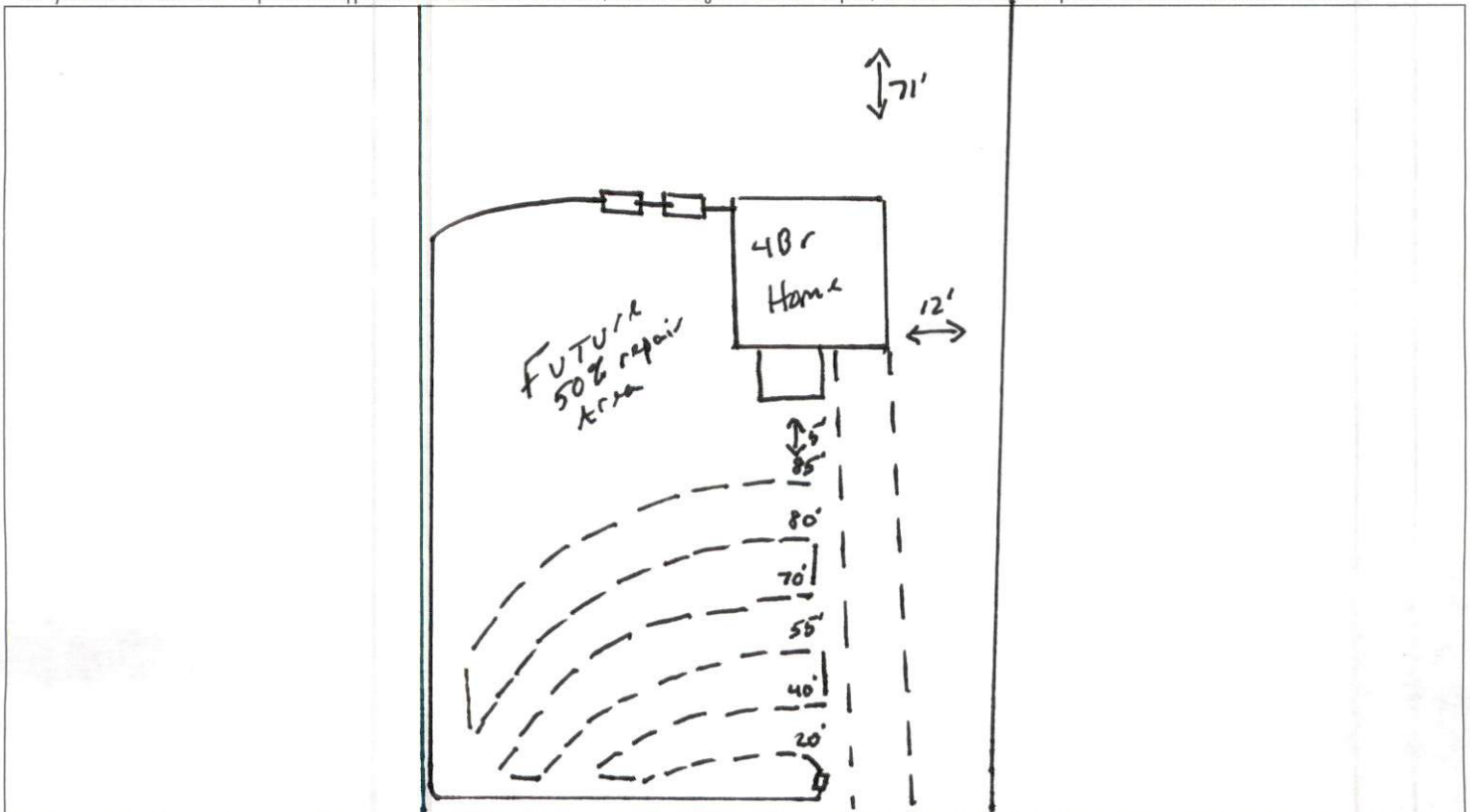

PERMIT CONDITIONS:

I. Performance: System shall perform in accordance with Rule .1961.

II. Monitoring: As required by Rule .1961.

III. Maintenance: As required by Rule .1961. Other: _____

Subsurface system operator required? Yes ☐ No ☒

If yes, see attached sheet for additional operation conditions, maintenance and reporting.

IV. Operation: _____

V. Other: _____

☒ D-Box ☐ Pump ☐ Alarm ☐ H2O Line ☐ PWR Line

Following are the specifications for the sewage disposal system on the above captioned property.

Type of system: ☐ Conventional ☒ Other 25% reduction in flow Septic Tank: 1000 gallons Pump Tank: 1000 gallons

Subsurface No. of exact length width of depth of
Drainage Field ditches 1 of each ditch 350 feet ditches 3 feet ditches 21 inches

French Drain Required: _____ Linear feet

Authorized State Agent [Signature]

Date 1-7-25

17A only

Honeycutt Hills lot 31 System Tap Chart

Bench Mark		is = 100.00		Location of BM		Elevation Head			10.90
Pump tank elev.		6	94.00	Pump elev.	89.00	Manifold elev.			99.90
line	color	rod read	Elevation	length	hole size	flow/tap	gal/day	trench area	LINE LTAR
1 & 2		1.10	98.90	60	1/2in SCH 80	5.48	88.27	180	0.4904
3&4			100.00	125	3/4in SCH 80	10.1	162.68	375	0.4338
5			100.00	80	1/2in SCH 40	7.11	114.52	240	0.4772
6			100.00	85	1/2in SCH 40	7.11	114.52	255	0.4491
		total	feet =	350	gal/min =	29.8	<u>LTAR =</u>		0.3500
							<u>LTAR + %5</u>		0.3675
% of Dose Vol.	75	<u>Des. Flow</u>		480			(ltar W/ INOV)		0.4667
Dose Volume	170.63	Pump Run=		16.11			(ltar W/ INOV + 5%)		0.4900
Dose Pump Time	5.73	Tank Gal/IN		21					
Drawdown in Inches	8.13								

Keep existing step-down between lines 1-2 and lines 3&4.