

SOIL/SITE EVALUATION for ON-SITE WASTEWATER SYSTEM

(Complete all fields in full)

OWNER: Deamon Baker DATE EVALUATED: 6-27-25

ADDRESS: 12235 NC 42

PROPOSED FACILITY: EX. SFD PROPOSED DESIGN FLOW (.0400): 360 PROPERTY SIZE:

LOCATION OF SITE: PROPERTY RECORDED:

WATER SUPPLY: ☒ Public ☐ Single Family Well ☐ Shared Well ☐ Spring ☐ Other WATER SUPPLY SETBACK:

EVALUATION METHOD: ☒ Auger Boring ☐ Pit ☐ Cut TYPE OF WASTEWATER: ☒ Domestic ☐ High Strength ☐ IPWW

P R O F I L E #	.0502 LANDSCAPE POSITION/ SLOPE %	HORIZON DEPTH (IN.)	SOIL MORPHOLOGY		OTHER PROFILE FACTORS				.0509 PROFILE CLASS & LTAR*	.0503 SLOPE CORRE CTION
			.0503 STRUCTURE/ TEXTURE	.0503 CONSISTENCE/ MINERALOGY	.0504 SOIL WETNESS/ COLOR	.0505 SOIL DEPTH	.0506 SAPRO CLASS	.0507 RESTR HORIZ		
1	2% LS	0-32	SL, gr			48"			.375	
		32-48	SCL, SBR	Fr, SS, NP, SE						
2, 3	2% LS	0-25	SL, gr			48"			.5	
		25-48	SCL, SBR	Fr, NS, NP, SE						
3										
4										

DESCRIPTION	INITIAL SYSTEM	REPAIR SYSTEM	SITE CLASSIFICATION (.0509): S EVALUATED BY: RL OTHER(S) PRESENT:
Available Space (.0508)	<input checked="" type="checkbox"/>	<input checked="" type="checkbox"/>	
System Type(s)	XXXX	25% Red	
Site LTAR		.375	
Maximum Trench Depth	<input checked="" type="checkbox"/>	18-28"	

Comments: Failure of EXISTING

Extra 180' for 30% Reduction for Future Repair

LEGEND

LANDSCAPE POSITION	SOIL GROUP	SOIL TEXTURE	CONVENTIONAL LTAR (gpd/ft²)	SAPROLITE LTAR (gpd/ft²)	LPP LTAR (gpd/ft²)	MINERALOGY/ CONSISTENCE		STRUCTURE
CC (Concave slope)	I	S (Sand)	0.8 - 1.2	0.6 - 0.8	0.4 -0.6	MOIST	WET	SG (Single grain)
CV (Convex Slope)		LS (Loamy sand)		0.5 -0.7		Lo (Loose)	NS (Non-sticky)	M (Massive)
D (Drainage way)	II	SL (Sandy loam)	0.6 - 0.8	0.4 -0.6	0.3 - 0.4	VFR (Very friable)	SS (Slightly sticky)	GR (Granular)
FP (Flood plain)		L (Loam)		0.2 - 0.4		FR (Friable)	S (Sticky)	SBK (Subangular blocky)
FS (Foot slope)	III	SiL (Silt loam)	0.3 - 0.6	0.1 - 0.3	0.15 - 0.3	FI (Firm)	VS (Very sticky)	ABK (Angular blocky)
H (Head slope)		SCL (Sandy clay loam)		0.05 - 0.15**		VFI (Very firm)	NP (Non-plastic)	PR (Prismatic)
L (Linear Slope)		CL (Clay loam)		None		EFI (Extremely firm)	SP (Slightly plastic)	PL (Platy)
N (Nose slope)		SiCL (Silty clay loam)					P (Plastic)	
R (Ridge/summit)		Si (Silt)					VP (Very plastic)	
S (Shoulder slope)		IV				SC (Sandy clay)	0.1 - 0.4	0.05 - 0.2
T (Terrace)	SiC (Silty clay)		EXP (Expansive)					
TS (Toe Slope)	C (Clay)							
		O (Organic)	None					

* Adjust LTAR due to depth, consistence, structure, soil wetness, landscape, position, wastewater flow and quality.

**Sandy clay loam saprolite can only be used with advanced pretreatment in accordance with 15A NCAC 18E .1200.

HORIZON DEPTH In inches below natural soil surface

DEPTH OF FILL In inches from land surface

RESTRICTIVE HORIZON Thickness and depth from land surface

SAPROLITE S(suitable) or U(unsuitable); Evaluation of saprolite shall be by pits.

SOIL WETNESS Inches from land surface to free water or inches from land surface to soil colors with chroma 2 or less - record Munsell color chip designation

CLASSIFICATION S (Suitable) or U (Unsuitable)

Show profile locations and other site features (dimensions, reference or benchmark, and North).

Harnett County Environmental Health

SITE SKETCH

PIN 0635-89-8802.000

Permit Number EH2506-0027

BAKER HENRY BEAMON & BAKER ELIZABETH ANN

73 ACRE 2 LOTS

Applicant's Name

Subdivision/Section/Lot Number

Ren Levocz

07/02/2025

Authorized State Agent

Date

System components represent approximate contours only. The contractor must flag the system prior to beginning the installation to ensure that the proper grade is maintained.

Scale = NTS

Spill Notes

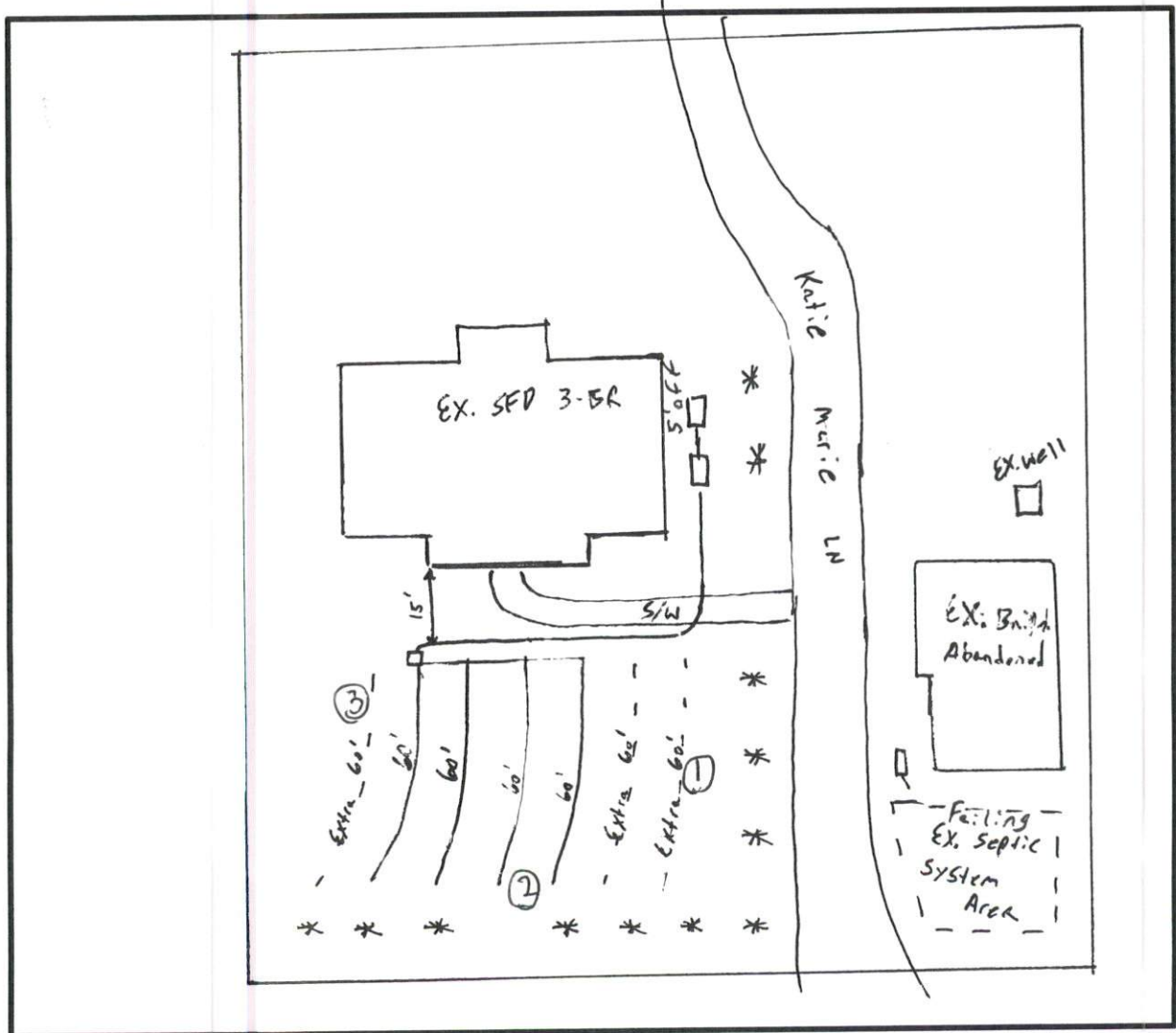

NC 42