

Owner: Blaine Sutton Applicant:

Address: 11818 Date Evaluated:  
Proposed Facility: Dwmth Design Flow (.1949): 480 GPD Property Size:  
Location of Site: Property Recorded:  
Water Supply: ☒ Public ☐ Individual ☒ Well ☐ Spring ☐ Other  
Evaluation Method: ☒ Auger Boring ☐ Pit ☐ Cut  
Type of Wastewater: ☒ Sewage ☐ Industrial Process ☐ Mixed

[illegible]

Description	Initial System	Repair System	Other Factors (.1946):
Available Space (.1945)	✓	✓	Site Classification (.1948):
System Type(s)		✓	Evaluated By: <i>[Signature]</i>
Site LTAR		✓	Others Present:

COMMENTS: \_\_\_\_\_

LANDSCAPE POSITIONS	GROUP	TEXTURES	.1955 LTAR	CONSISTENCE MOIST	WET
R-RIDGE	I	S-SAND	1.2 - 0.8	VFR-VERY FRIABLE FR-FRIABLE	NS-NON-STICKY
S-SHOULDER SLOPE		LS-LOAMY SAND			SS-SLIGHTLY STICKY
L-LINEAR SLOPE	II	SL-SANDY LOAM	0.8 - 0.6	FI-FIRM VFI-VERY FIRM	S-STICKY
FS-FOOT SLOPE		L-LOAM			VS-VERY STICKY
N-NOSE SLOPE	III	SI-SILT	0.6 - 0.3	EFI-EXTREMELY FIRM	NP-NON-PLASTIC
H-HEAD SLOPE		SIL-SILT LOAM			SP-SLIGHTLY STICKY
CC-CONCLAVE SLOPE		CL-CLAY LOAM			P-PLASTIC
CV-CONVEX SLOPE		SCL-SANDY CLAY LOAM			VP-VERY PLASTIC
T-TERRACE	IV	SIC-SILTY CLAY	0.4 - 0.1		
FP-FLOOD PLAN		C-CLAY			
		SC-SANDY CLAY			

STRUCTURE

SG-SINGLE GRAIN  
M-MASSIVE  
CR-CRUMB  
GR-GRANULAR  
SBK-SUBANGULAR BLOCKY  
ABK-ANGULAR BLOCKY  
PL-PLATY  
PR-PRISMATIC

MINERALOGY

SLIGHTLY EXPANSIVE  
EXPANSIVE

Show profile locations and other site features (dimensions, references or benchmark, and North)

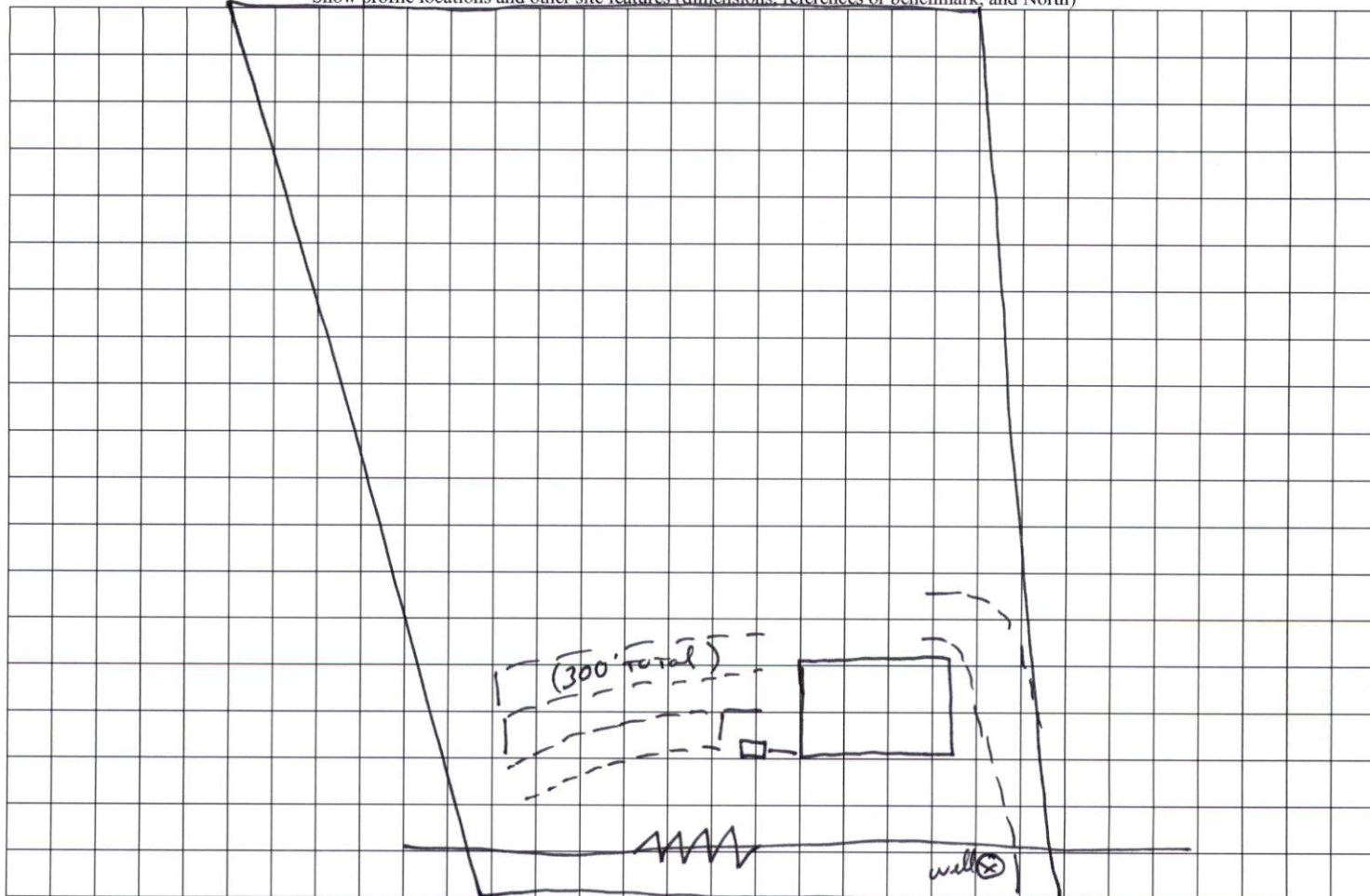

← NC 27 →