

**SOIL/SITE EVALUATION**  
**for ON-SITE WASTEWATER SYSTEM**

Owner: *Shelby West*

Applicant: *Bethel Baptist*  
 Address: *2195 Bethel Baptist*  
 Proposed Facility: *DWMT*

Date Evaluated: *360 GPD*  
 Design Flow (.1949):

Property Size:

Location of Site:

Property Recorded:

Water Supply:

Public  Individual  Well  Spring  Other

Evaluation Method:  Auger Boring

Pit  Cut

Type of Wastewater:

Sewage  Industrial Process  Mixed

P R O F I L E #	.1940 Landscape Position/ Slope %	Horizon Depth (In.)	SOIL MORPHOLOGY .1941		OTHER PROFILE FACTORS				Profile Class & LTAR
			.1941 Structure/ Texture	.1941 Consistence Mineralogy	.1942 Soil Wetness/ Color	.1943 Soil Depth (IN.)	.1956 Sapro Class	.1944 Restr Horiz	
①	L 2-5%	0-10 10-48	LS SCI	Fr Fi	10YR 6/1 ≥ 36"	> 48"	—	—	S.4
2	L 2-5%	0-10 10-48	LS SCI	Fr Fi	10YR 6/1 ≥ 36"	> 48"	—	—	S.4
3	L 2-5%	0-12 12-48	LS SCI	Fr Fi	10YR 6/1 ≥ 34"	> 48"	—	—	S.4

Description	Initial System	Repair System	Other Factors (.1946): Site Classification (.1948): Evaluated By: <i>ML REHS</i> Others Present:
Available Space (.1945)		<i>✓</i>	
System Type(s)		<i>✓</i>	
Site LTAR		<i>.4</i>	

COMMENTS: \_\_\_\_\_

LANDSCAPE POSITIONS	GROUP	TEXTURES	.1955 LTAR	CONSISTENCE MOIST	WET
R-RIDGE	I	S-SAND	1.2 - 0.8	VFR-VERY FRIABLE	NS-NON-STICKY
S-SHOULDER SLOPE		LS-LOAMY SAND		FR-FRIABLE	SS-SLIGHTLY STICKY
L-LINEAR SLOPE	II	SL-SANDY LOAM	0.8 - 0.6	FI-FIRM	S-STICKY
FS-FOOT SLOPE		L-LOAM		VFI-VERY FIRM	VS-VERY STICKY
N-NOSE SLOPE	III	SI-SILT	0.6 - 0.3	EFI-EXTREMELY FIRM	NP-NON-PLASTIC
H-HEAD SLOPE		SIL-SILT LOAM		SP-SLIGHTLY STICKY	
CC-CONCLAVE SLOPE		CL-CLAY LOAM		P-PLASTIC	
CV-CONVEX SLOPE		SCL-SANDY CLAY LOAM		VP-VERY PLASTIC	
T-TERRACE	IV	SIC-SILTY CLAY	0.4 - 0.1		
FP-FLOOD PLAN		C-CLAY			
		SC-SANDY CLAY			

STRUCTURE  
 SG-SINGLE GRAIN  
 M- MASSIVE  
 CR-CRUMB  
 GR-GRANULAR  
 SBK-SUBANGULAR BLOCKY  
 ABK-ANGULAR BLOCKY  
 PL-PLATY  
 PR-PRISMATIC

MINERALOGY  
 SLIGHTLY EXPANSIVE  
 EXPANSIVE

10.01  
Acre

Show profile locations and other site features (dimensions, references or benchmark, and North)

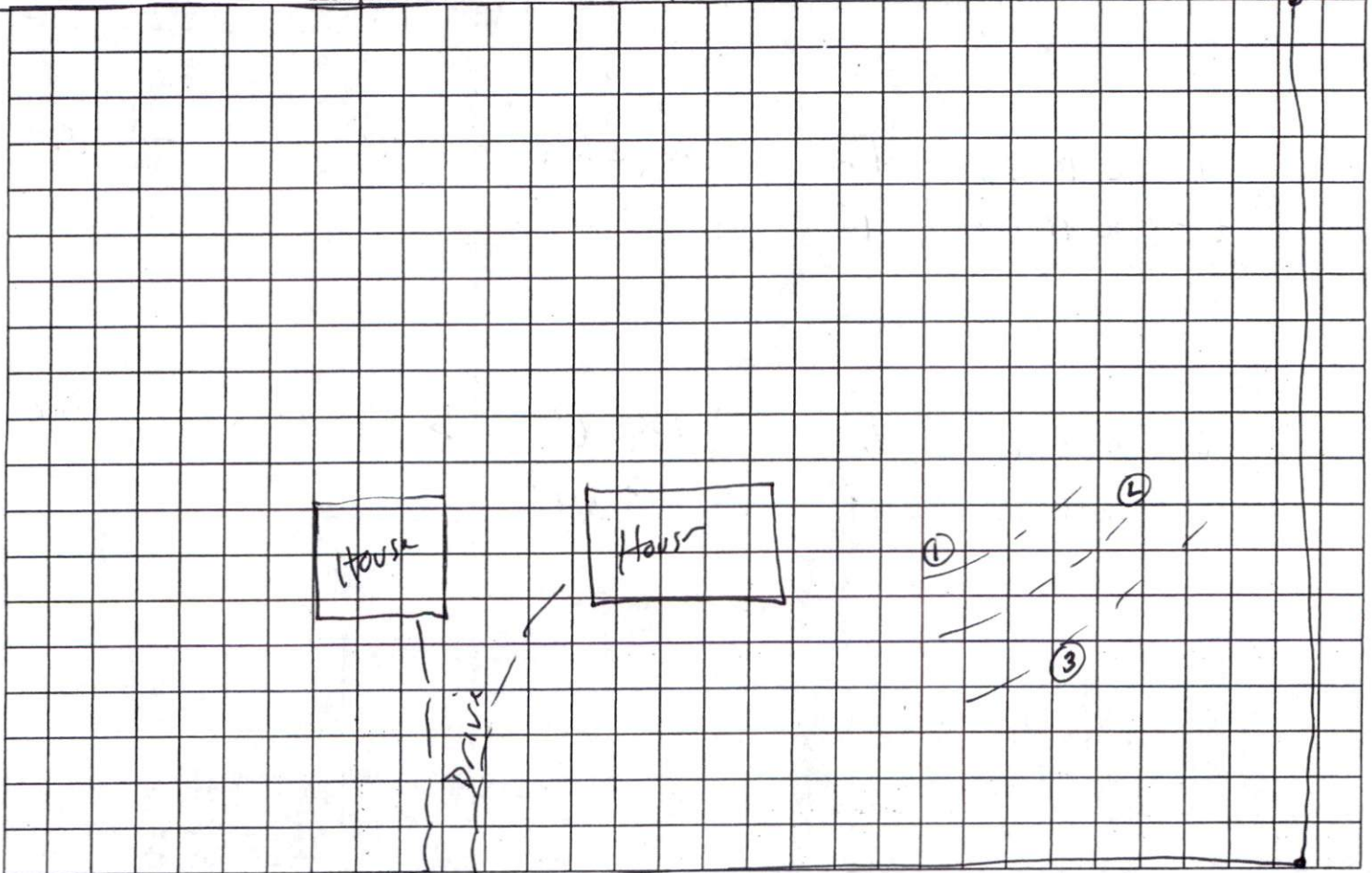

Bethel Baptist