

# Harnett County Department of Public Health

PERMIT # EH2411-0002

**Operation Permit**      Curtain Drain

New Installation    Septic Tank    Nitrification Line    Repair    Expansion

PROPERTY LOCATION: 1130 Fair Barn Rd (SR 1386)

Name: (owner) Jeff Anderson      SUBDIVISION \_\_\_\_\_      LOT # \_\_\_\_\_

System Installer: Wastewater Solutions

Basement with plumbing:     Garage     Number of Bedrooms \_\_\_\_\_

Type of Water Supply:  Community    Public    Well    Distance from well \_\_\_\_\_ feet

System Type: \_\_\_\_\_      Types V and VI Systems expire in 5 years.

(In accordance with Table V a)      Owner must contact Health Department 6 months prior to expiration for permit renewal.

This system has been installed in compliance with applicable North Carolina General Statutes, Rules for Sewage Treatment and Disposal, and all conditions of the Improvement Permit and Construction Authorization.

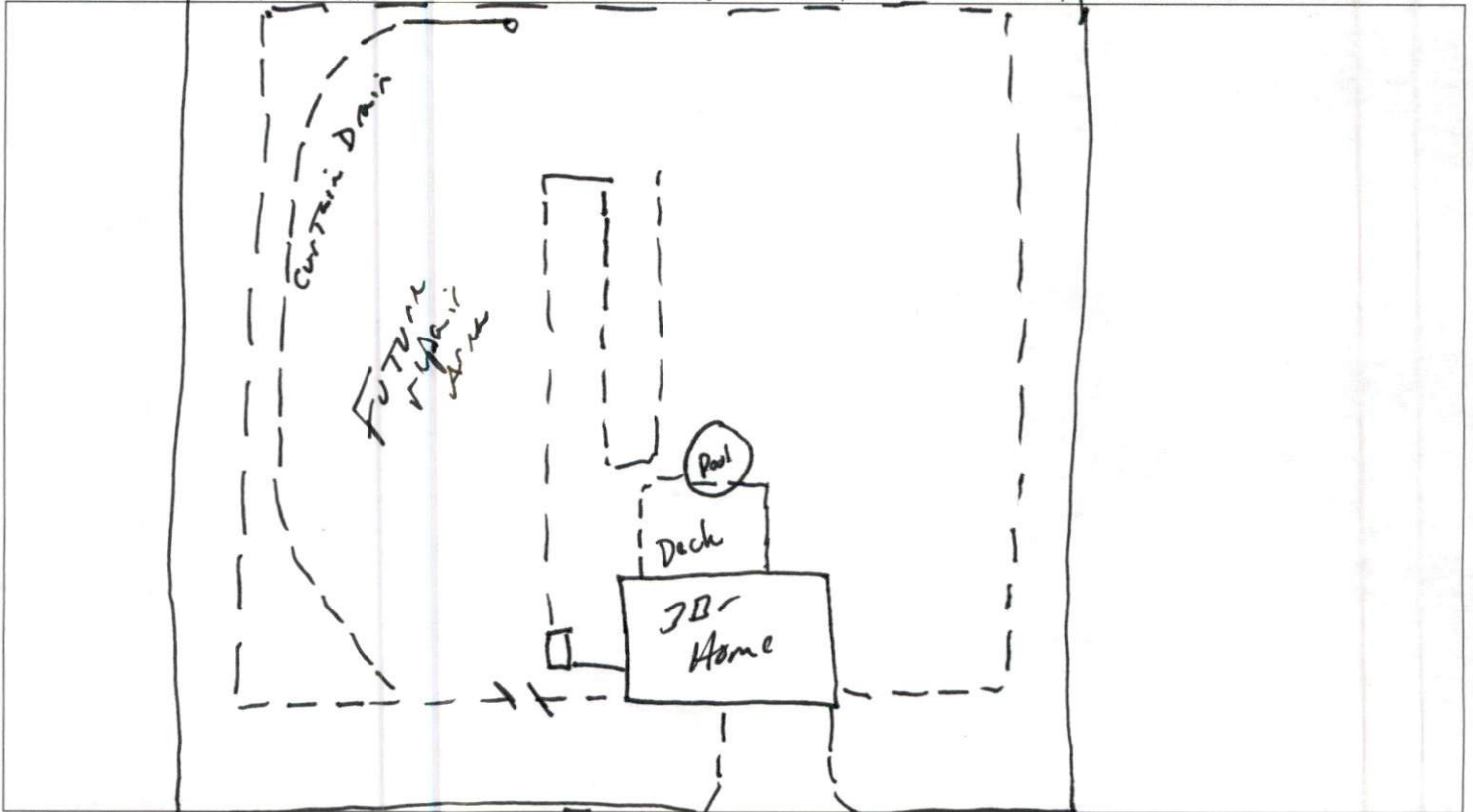

**PERMIT CONDITIONS:**

- I. Performance: System shall perform in accordance with Rule .1961.
- II. Monitoring: As required by Rule .1961.
- III. Maintenance: As required by Rule .1961. Other: \_\_\_\_\_  
 Subsurface system operator required? Yes  No   
 If yes, see attached sheet for additional operation conditions, maintenance and reporting.

IV. Operation: \_\_\_\_\_  
 \_\_\_\_\_

V. Other: \_\_\_\_\_  
 \_\_\_\_\_

\_\_\_\_\_ D-Box    \_\_\_\_\_ Pump    \_\_\_\_\_ Alarm    \_\_\_\_\_ H2Oline    \_\_\_\_\_ PWR Line

Following are the specifications for the sewage disposal system on the above captioned property.

Type of system:  Conventional    Other CURTAIN DRAIN INSTALLED    Septic Tank: \_\_\_\_\_ gallons    Pump Tank: \_\_\_\_\_ gallons

Subsurface      No. of      exact length      width of      depth of

Drainage Field      ditches \_\_\_\_\_      of each ditch \_\_\_\_\_ feet      ditches \_\_\_\_\_ feet      ditches \_\_\_\_\_ inches

French Drain Required: \_\_\_\_\_ Linear feet

Authorized State Agent: [Signature]      Date: 11-21-24