

HARNETT COUNTY HEALTH DEPARTMENT
ENVIRONMENTAL HEALTH SECTION
307 W. CORNELIUS HARNETT BLVD.
LILLINGTON, NC 27546
910-893-7547 PHONE
910-893-9371 FAX

Application for Repair

OWNER NAME TONY McNeill EMAIL ADDRESS: _____
PHONE NUMBER 910 536-4094 PHONE _____
PHYSICAL ADDRESS 1051 TIM CURRIN RD LILLINGTON NC
MAILING ADDRESS (IF DIFFERENT THAN PHYSICAL) SAME
IF RENTING, LEASING, ETC., LIST PROPERTY OWNER NAME _____

SUBDIVISION NAME _____ LOT #/TRACT # _____ STATE RD/HWY _____ SIZE OF LOT/TRACT _____

Type of Dwelling: Modular Mobile Home Stick built Other _____

Number of bedrooms 3 Basement

Garage: Yes No Dishwasher: Yes No Garbage Disposal: Yes No

Water Supply: Private Well Community System County

Directions from Lillington to your site: _____

In order for Environmental Health to help you with your repair, you will need to comply by completing the following:

1. A "surveyed and recorded map" and "deed to your property" must be attached to this application. Please inform us of any wells on the property by showing on your survey map.
2. The outlet end of the tank and the distribution box will need to be uncovered and property lines flagged. After the tank is uncovered, property lines flagged, underground utilities marked, and the orange sign has been placed, you will need to call us at 910-893-7547 to confirm that your site is ready for evaluation.

Your system must be repaired within 30 days of issuance of the Improvement Permit or the time set within receipt of a violation letter. (Whichever is applicable.)

By signing below, I certify that all of the above information is correct to the best of my knowledge. False information will result in the denial of the permit. The permit is subject to revocation if the site plan, intended use, or ownership changes.

Tony McNeill
Owner Signature

5-28-24
Date

HOMEOWNER INTERVIEW FORM

It is important that you answer the following questions for our inspectors. Please do not leave any blanks if possible, and answer all questions to the best of your ability. Thank You.

Have you received a violation letter for a failing system from our office? YES NO
Also, within the last 5 years have you completed an application for repair for this site? YES NO

Year home was built (or year of septic tank installation) 1994
Installer of system _____
Septic Tank Pumper _____
Designer of System _____

1. Number of people who live in house? 3 # adults 1 # children 4 # total
2. What is your average estimated daily water usage? _____ gallons/month or day _____ county water. If HCPU please give the name the bill is listed in _____
3. If you have a garbage disposal, how often is it used? daily weekly monthly
4. When was the septic tank last pumped? 2 week How often do you have it pumped? _____
5. If you have a dishwasher, how often do you use it? daily every other day weekly
6. If you have a washing machine, how often do you use it? daily every other day weekly monthly
7. Do you have a water softener or treatment system? YES NO Where does it drain?

8. Do you use an "in tank" toilet bowl sanitizer? YES NO
9. Are you or any member in your household using long term prescription drugs, antibiotics or chemotherapy? YES NO If yes please list _____
10. Do you put household cleaning chemicals down the drain? YES NO If so, what kind?

11. Have you put any chemicals (paints, thinners, etc.) down the drain? YES NO
12. Have you installed any water fixtures since your system has been installed? YES NO If yes, please list any additions including any spas, whirlpool, sinks, lavatories, bath/showers, toilets _____
13. Do you have an underground lawn watering system? YES NO
14. Has any work been done to your structure since the initial move into your home such as, a roof, gutter drains, basement foundation drains, landscaping, etc? If yes, please list _____
15. Are there any underground utilities on your lot? Please check all that apply:
 Power Phone Cable Gas Water
16. Describe what is happening when you are having problems with your septic system, and when was this first noticed?
DAMP SPOT ON GROUND
17. Do you notice the problem as being patterned or linked to a specific event (i.e., wash clothes, heavy rains, and household guests?) YES NO If Yes, please list
WASHING CLOTHES

CERTIFICATE OF COMPLETION / OPERATIONAL PERMIT

Name: (owner) Tony Canero New Installation Septic Tank
Property Location: SR# 1250 Repairs Nitrification Line
Subdivision _____ Lot # _____
TAX ID# _____ Quadrant # _____
Contractor: Mike Ray Registration # 64
Basement with Plumbing: Garage:
Water Supply: Well Public Community
Distance From Well: 50+ ft.

Following are the specifications for the sewage disposal system on above captioned property.

Type of system: Conventional Other _____
Size of tank: Septic Tank: 1000 gallons Pump Tank: _____ gallons
Subsurface Drainage Field No. of ditches 3 exact length of each ditch 120 ft. width of ditches 3 ft. depth of ditches 24 in.
French Drain: _____ Linear feet

PERMIT NO. 09053

Date: 7-8-94

Inspected by: Jan E. Walker
Environmental Health Specialist

Property line: Old Woods Lane

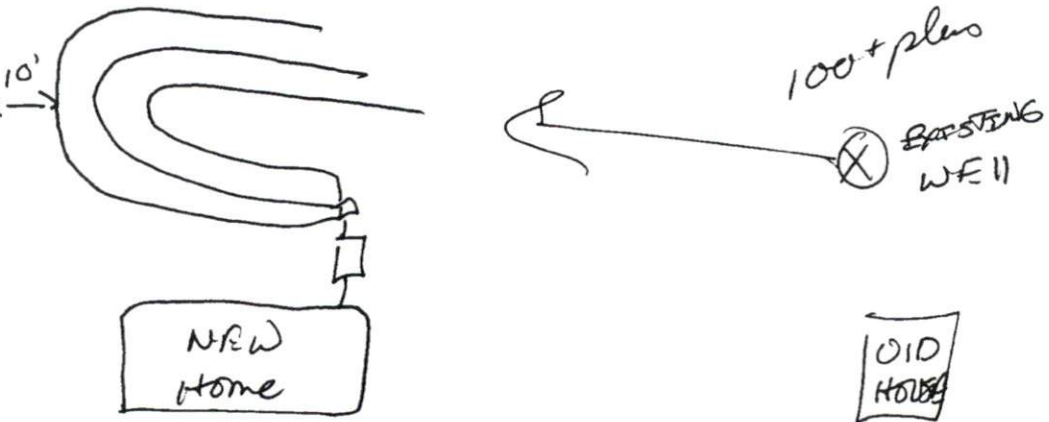

← Tim Curran Rd SR1250

FOR REGISTRATION
Kimberly S. Hargrove
REGISTER OF DEEDS
Harnett County, NC
2014 DEC 04 11:55:51 AM
BK: 3265 PG: 186-188
FEE: \$26.00
EXCISE TAX: \$124.00
INSTRUMENT # 2014016239
TWESTER

HARNETT COUNTY TAX ID#
13.0529.0048



2014016239

11-17-14 BY 88

NORTH CAROLINA NON-WARRANTY DEED

Excise Tax: \$124.00

Parcel Identifier No. 0528-48-2658.000 Verified by _____ County on the _____ day of _____, 20____
By: _____

Mail/Box to: Green Tree Servicing LLC, Attn: REO Dept., P.O. Box 31601, Tampa, FL 33631-3601

This instrument was prepared by: Sellers, Ayers, Dortch & Lyons, P.A., 301 S. McDowell St., Ste. 410, Charlotte, NC 28204
WITHOUT TITLE EXAM

Brief description for the Index: Containing 2 acres more or less

THIS DEED made this 21st day of October, 2014, by and between

GRANTOR

GRANTEE

Green Tree Servicing LLC, as successor by merger to
Walter Mortgage Company LLC
Post Office Box 31601
Tampa, FL 33631-3601

Tony and Rachel McNeill (husband and wife)
1051 Tim Currin Road
Lillington, NC 27546

Enter in appropriate block for each Grantor and Grantee: name, mailing address, and, if appropriate, character of entity, e.g. corporation or partnership.

The designation Grantor and Grantee as used herein shall include said parties, their heirs, successors, and assigns, and shall include singular, plural, masculine, feminine or neuter as required by context.

WITNESSETH, that the Grantor, for a valuable consideration paid by the Grantee, the receipt of which is hereby acknowledged, has and by these presents does grant, bargain, sell and convey unto the Grantee in fee simple, all that certain lot or parcel of land situated in the City of Lillington, Upper Little River Township, Harnett County, North Carolina and more particularly described as follows:

SEE ATTACHED LEGAL DESCRIPTION

The property hereinabove described was acquired by Grantor by instrument recorded in Book 3213, Page 781-783.

All or a portion of the property herein conveyed ___ includes or x does not include the primary residence of a Grantor.

A map showing the above described property is recorded in Plat Book n/a, Page n/a.

TO HAVE AND TO HOLD the aforesaid lot or parcel of land and all privileges and appurtenances thereto belonging to the Grantee in fee simple.

Grantor makes no warranty, expressed or implied, as to title to the property hereinabove described.

IN WITNESS WHEREOF, the Grantor has duly executed the foregoing as of the day and year first above written.

Green Tree Servicing LLC, as successor by merger to Walter Mortgage Company LLC

By: _____

(SEAL)

Print/Type Name & Title: Joseph H. Kelly Jr. Vice President

(Attest) Christina Tribble, Assistant Secretary

State of Florida - County Hillsborough

I, the undersigned Notary Public of the County of Hillsborough and State aforesaid, certify that Joseph H. Kelly Jr. personally came before me this day and acknowledged that (s)he is the Vice President of Green Tree Servicing LLC, as successor by merger to Walter Mortgage Company LLC, and that by authority duly given and as the act of the corporation, the foregoing instrument was signed by its Vice President, sealed with its corporate seal and attested by him/her as its Assist. Secretary.

Witness my hand and Notarial stamp or seal, this 21st day of October, 2014.

My Commission Expires: (Affix Seal)

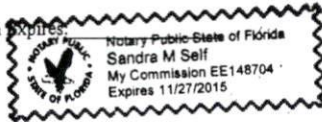

Sandra M. Self
Notary Public
Notary's Printed or Typed Name

Exhibit A

BEING all that certain lot, tract, or parcel of real estate in the County of Harnett, State of North Carolina, and is more particularly described as follows:

Beginning in the center of the Northington Road or Highway, and runs thence South 60 degrees West with the line of the Roy Morrison land and passing his corner 420 feet to an iron stake corner; thence North 22 degrees 30' West 210 feet to an iron stake corner; thence North 60 degrees East 420 feet to the center of the Northington Road or highway; thence with the center line of said road or highway, south 22 degrees 30' east 210 feet to the beginning, and containing 2 acres, more or less, according to an actual survey made November 4, 1948.

Being the same property conveyed by Trustees Deed to Green Tree Servicing LLC recorded on May 9, 2014 in Book 3213 Page 781-783.

Less and except any road right of ways of record. Grantor does not assume liability for unpaid taxes.

This deed is given subject to that certain Deed of Trust from the Grantee herein to the Grantor herein dated October 21, 2014.

NORTH CAROLINA HARNETT COUNTY
 I, Mickey R. Bennett, PLS do certify that this plat was drawn under my supervision and description recorded in Book SEE, Page SEE, etc) that the boundaries not surveyed are clearly indicated as drawn from information found in Book SEE, Page SEE, that the ratio of precision as calculated is 1:7500:1 that this plat was prepared in accordance with G.S. 47-30 as amended, Witness my original signature, registration number and seal this 3RD day of March, A.D. 2010.

Mickey R. Bennett
 MICKEY R. BENNETT
 L - 1514



I, MICKEY R. BENNETT PLS DO HEREBY CERTIFY THAT THIS IS AN EXISTING PARCEL OR PARCELS OF LAND AND DOES NOT CREATE A NEW STREET OR CHANGE ANY EXISTING STREETS.

VICKIE MORRISON WEAVER
 KAREN MORRISON KELLY
 DB:2417,PG:851
 TRACT TWO
 MAP BOOK 14,PAGE 80

DEED REFERENCE
 DEED BOOK 1525,PAGE 106
 DEED BOOK 1635,PAGE 288

MAP REFERENCE
 MAP BOOK 14,PAGE 80
 MAP NO. 2004-1024



FOR REGISTRATION REGISTER OF DEEDS
 KIMBERLY S. HARROVE
 HARNETT COUNTY, NC
 2010 MAR 03 10:46:51 AM
 BK 2010 PG 136-139 FEE: \$21.00

INSTRUMENT # 2010002864

VICKIE MORRISON WEAVER
 KAREN MORRISON KELLY
 DB:2417,PG:851
 TRACT TWO
 MAP BOOK 14,PAGE 80

PEARLIE CAMPBELL
 DB:2010,PG:582
 MAP NO. 2004-1024

NO APPROVAL NECESSARY

Sheila Cameron
 REVIEW OFFICER

LEGEND
 LINES NOT SURVEYED-----
 LINES SURVEYED-----
 EIP-----EXISTING IRON PIPE
 ECM-----EXISTING CONCRETE MONUMENT
 EIS-----EXISTING IRON STAKE
 EPKN-----EXISTING P.K.NAIL
 ELS-----EXISTING LIGHTWOOD STAKE
 NIS--NEW IRON STAKE NIP--NEW IRON PIPE
 PKNS-----P.K.NAIL SET
 ERMS-----EXISTING RAILROAD SPIKE
 NIRS-----NEW RAILROAD SPIKE
 EMN-----EXISTING MAGNETIC NAIL
 NMN-----NEW MAGNETIC NAIL
 ECS-----EXISTING COTTON SPINDLE
 NCS-----NEW COTTON SPINDLE
 EIP/ES--(CONTROL CORNERS)
 ECM/PKN/ECS (CONTROL CORNERS)
 C/L--CENTER LINE N/T--NOW OR FORMALLY
 CP--CALCULATED POINT
 DBAD--CHORD BEARING AND DISTANCE
 D.E.--DRAINAGE EASEMENT; R/W--RIGHT OF WAY
 EX-----EXISTING AC.--ACRES

NORTH CAROLINA
 HARNETT COUNTY

This Map/Plat was presented for registration and recorded in this office of Map Number 2010-138

This 9th day of March, 2010.
 at 10:46 o'clock a. M.

KIMBERLY S. HARROVE Register of Deeds
 By: *Sheila Cameron*
 Assistant County Register of Deeds

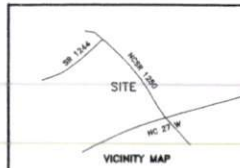

TOWNSHIP UPPER LITTLE RIVER		COUNTY HARNETT	
STATE: NORTH CAROLINA		DATE: MARCH 3, 2010	
ZONE RA-30	WATERSHED DISTRICT N/A	TAX PARCEL IDR: 130529 0048	PIN # 0528-48-2658.000

BENNETT SURVEYS, INC. C-1080 1662 CLARK RD., LILLINGTON, N.C. 27546 (910) 893-5252		SURVEYED BY: JRM		FIELD BOOK
SCALE: 1" = 40'		DRAWN BY: MRB		DRAWING NO.
CHECKED & CLOSURE BY: MRB		10051		

Map# 2010-138

NORTH REFERENCE MAP NO. 2004-1024