

# Harnett County Environmental Health

File/Permit Number: EH2406-0001

## CONSTRUCTION AUTHORIZATION

County: Harnett PIN/Lot Identifier: 0517-25-7612  
Owner: George reed Applicant: George reed  
Property Location: 4871 Darroch Rd (SR 1128)  
Facility Type: Existing DWMH

Number of bedrooms: 4 Number of Occupants: 8 Other: \_\_\_\_\_  
 New  Expansion  Repair  System Relocation  Change of Use  
Basement?  Yes  No Basement Fixtures?  Yes  No  
Crawl Space?  Yes  No Slab Foundation?  Yes  No  
Type of Wastewater System\* \_\_\_\_\_ (Initial) 25% reduction (Repair)

\*Please include system classification for proposed wastewater system types in accordance with Rule .1301 Table XXXII

Design Daily Flow: 480 GPD Wastewater Strength:  Domestic  High Strength  Industrial Process Wastewater  
Rule .0403(e) Engineering Design Utilizing Low-flow Fixtures and Low-flow Technologies (S.L. 2013-413 and 2014-120)?  Yes  No  
(if yes, please provide engineering documentation)  
Effluent Standard:  DSE  HSE  NSF/ANSI 40  TS-I  TS-II  RCW  
Type of Water Supply:  Private well  Public well  Shared well  Municipal Supply  Spring  Other: \_\_\_\_\_

### Installation Requirements/Conditions

Septic Tank Size: Existing gallons Total Trench/Bed Length: 250 feet Trench/Bed Spacing: 9 feet on center  
Trench/Bed Width: 36 inches LTAR: .45 gpd/ft<sup>2</sup> Usable Depth to LC (Initial)\*: 30 <sup>Limiting condition</sup>  
Soil Cover: 6 inches Slope Corrected Maximum Trench/Bed Depth†: 18 inches \* **Measured on the downhill side of the trench**  
Pump Tank Size (if applicable): existing gallons Requires more than one pump?  Yes  No  
Pump Requirements: \_\_\_\_\_ ft. TDH vs. \_\_\_\_\_ GPM Grease Trap Size (if applicable): \_\_\_\_\_ gallons  
Distribution Method:  Serial  D-Box or Parallel  Pressure Manifold(s)  LPP  Other: \_\_\_\_\_  
Artificial Drainage Required: Yes  No  If yes, please specify details: \_\_\_\_\_

### Legal Agreements (If the answer is "Yes" to any type of legal agreements, please attach a copy of the agreement.)

Multi-party Agreement Required [Rule .0204(g)]:  Yes  No  
Easement, Right-of-Way, or Encroachment Agreement Required [Rule .0204(d)]:  Yes  No  
Declaration of Restrictive Covenants:  Yes  No Pre-Construction Conference Required: Yes  No   
Management Entity Required:  Yes  No Minimum O&M Requirements: \_\_\_\_\_  
Conditions: \_\_\_\_\_

The requirements of 15A NCAC 18E are incorporated by reference into this permit and shall be met. Systems shall be installed in accordance with the attached site sketch. ***This Construction Authorization is subject to revocation if the site plan, plat, or the intended use changes.*** The Construction Authorization shall not be affected by a change in ownership of the site. This Construction Authorization is subject to compliance with the provisions of 15A NCAC 18E, or 15A NCAC 18A .1900, as applicable, and to the conditions of this permit.

Authorized Agent's Printed Name: Mark Osborne REHS Expiration Date: 11-19-29  
Authorized Agent's Signature:  Date: 11-19-24

**\*See attached site sketch\***

# Harnett County Environmental Health

## SITE SKETCH

PIN 0517-25-7612

Permit Number EH2406-0001

George reed

Applicant's Name

Mark Osborne REHS

Authorized State Agent

Subdivision/Section/Lot Number

11-19-24

Date

System components represent approximate contours only. The contractor must flag the system prior to beginning the installation to ensure that the proper grade is maintained.

Scale = NTS

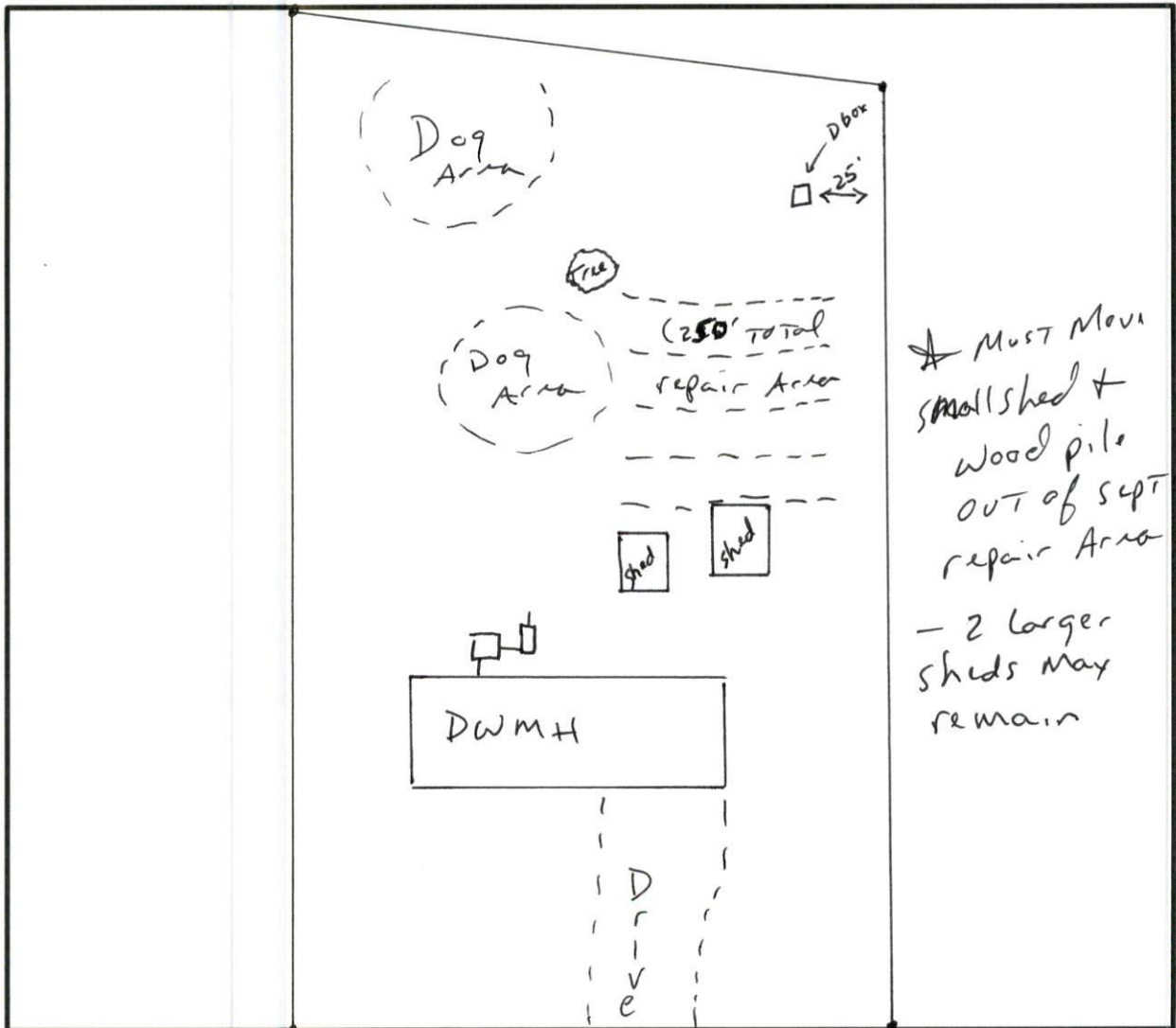

\* Must Move small shed + wood pile out of septic repair Area  
- 2 larger sheds may remain