

Harnett County Department of Public Health

PERMIT # EH2404-0011

Operation Permit

New Installation Septic Tank Nitrification Line Repair Expansion

PROPERTY LOCATION: Hwy 27 S

Name: (owner) Richard Mele

SUBDIVISION _____

LOT # _____

System Installer: JUNION Landscapes

Basement with plumbing: Garage Number of Bedrooms 5

Type of Water Supply: Community Public Well Distance from well _____ feet

System Type: TANK AND D-BOX

Types V and VI Systems expire in 5 years.

(In accordance with Table V a)

Owner must contact Health Department 6 months prior to expiration for permit renewal.

This system has been installed in compliance with applicable North Carolina General Statutes, Rules for Sewage Treatment and Disposal, and all conditions of the Improvement Permit and Construction Authorization.

* OWNER OWNS BOTH PARCELS OF LAND.
* ESMT DOCUMENTATION IS INCLUDED.

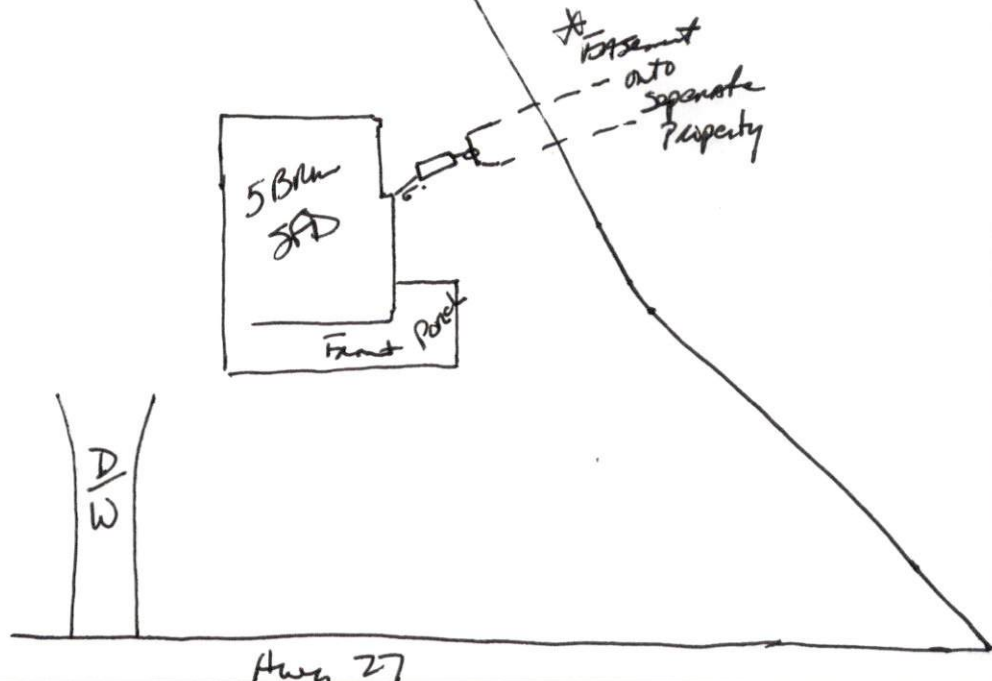

PERMIT CONDITIONS:

- I. Performance: System shall perform in accordance with Rule .1961.
- II. Monitoring: As required by Rule .1961.
- III. Maintenance: As required by Rule .1961. Other: _____
Subsurface system operator required? Yes No
If yes, see attached sheet for additional operation conditions, maintenance and reporting.
- IV. Operation: _____
- V. Other: _____

D-Box Pump Alarm H2O Line PWR Line

Following are the specifications for the sewage disposal system on the above captioned property.

Type of system: Conventional Other Tank + D-Box Septic Tank: 1250 gallons Pump Tank: _____ gallons

Subsurface No. of _____ exact length _____ width of _____ depth of _____

Drainage Field ditches _____ of each ditch _____ feet ditches _____ feet ditches _____ inches

French Drain Required: _____ Linear feet

Authorized State Agent James E. Manhart

Date 5-6-24