

Harnett County Department of Public Health

PERMIT # EH 2402-0014

Operation Permit

- New Installation
 Septic Tank
 Nitrification Line
 Repair
 Expansion

PROPERTY LOCATION: SR 1802 Lane RD

Name: (owner) Brawdon + Christy Louvick SUBDIVISION _____ LOT # _____

System Installer: Eastern Splic

Basement with plumbing: Garage Number of Bedrooms 2

Type of Water Supply: Community Public Well Distance from well 50'+ feet

System Type: 25% REDUCTION SYSTEM III G Types V and VI Systems expire in 5 years.

(In accordance with Table V a)

Owner must contact Health Department 6 months prior to expiration for permit renewal.

Chamber Outlet

This system has been installed in compliance with applicable North Carolina General Statutes, Rules for Sewage Treatment and Disposal, and all conditions of the Improvement Permit and Construction Authorization.

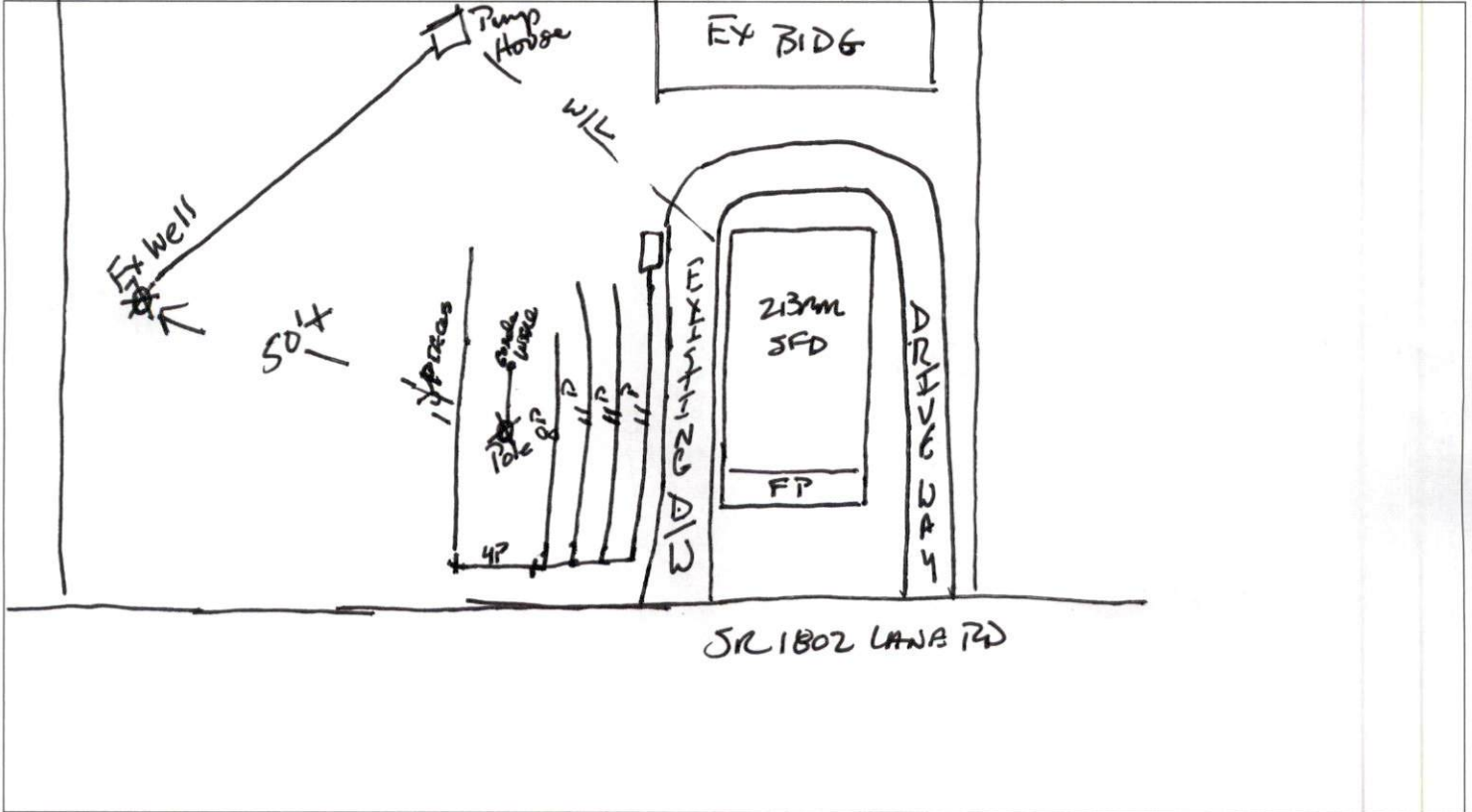

PERMIT CONDITIONS:

- I. Performance: System shall perform in accordance with Rule .1961.
- II. Monitoring: As required by Rule .1961.
- III. Maintenance: As required by Rule .1961. Other: _____
 Subsurface system operator required? Yes No
 If yes, see attached sheet for additional operation conditions, maintenance and reporting.
- IV. Operation: _____
- V. Other: _____

_____ D-Box
 _____ Pump
 _____ Alarm
 _____ H2O Line
 _____ PWR Line

Following are the specifications for the sewage disposal system on the above captioned property.

Type of system: Conventional
 Other 25% REDUCTION
 Septic Tank: 1000 gallons
 Pump Tank: _____ gallons
 Subsurface Drainage Field: No. of ditches 1
 exact length of each ditch 248' total
 width of ditches 3 feet
 depth of ditches 18"-16" inches
 French Drain Required: _____ Linear feet

Authorized State Agent: James E. Markham FOR 2885
 Date: 4-16-24