

Harnett County Department of Public Health

PERMIT # EH 2310-0007

Operation Permit

New Installation Septic Tank Nitrification Line Repair Expansion

PROPERTY LOCATION: Hwy 401N

Name: (owner) Sara Whittington Young SUBDIVISION _____ LOT # _____

System Installer: Clint Adams

Basement with plumbing: Garage Number of Bedrooms 2

Type of Water Supply: Community Public Well Distance from well _____ feet

System Type: 25% RIGIDUCROW SYSTEM Types V and VI Systems expire in 5 years.

(In accordance with Table V a) Owner must contact Health Department 6 months prior to expiration for permit renewal.

EE Flow

This system has been installed in compliance with applicable North Carolina General Statutes, Rules for Sewage Treatment and Disposal, and all conditions of the Improvement Permit and Construction Authorization.

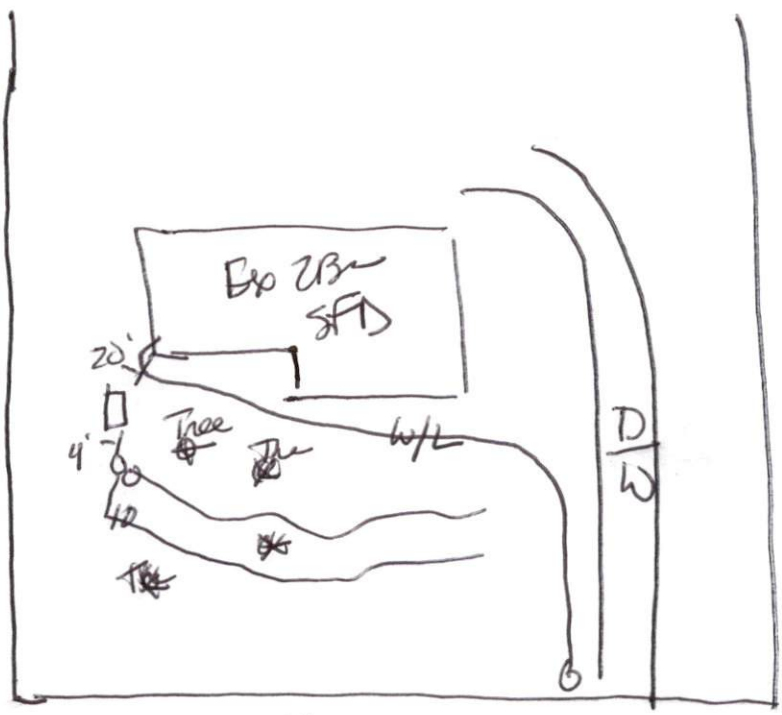

Hwy 401N

PERMIT CONDITIONS:

- I. Performance: System shall perform in accordance with Rule .1961.
- II. Monitoring: As required by Rule .1961.
- III. Maintenance: As required by Rule .1961. Other: _____
Subsurface system operator required? Yes No
If yes, see attached sheet for additional operation conditions, maintenance and reporting.
- IV. Operation: _____
- V. Other: _____

_____ D-Box _____ Pump _____ Alarm _____ H2O Line _____ PWR Line

Following are the specifications for the sewage disposal system on the above captioned property.

Type of system: Conventional Other 25% RUGD Septic Tank: 1000 gallons Pump Tank: _____ gallons
 Subsurface Drainage Field: No. of ditches 2 exact length of each ditch 100 feet width of ditches 3 feet depth of ditches 24-28 inches
 French Drain Required: _____ Linear feet

Authorized State Agent James E. ... REAS Date 10-24-23