

SOIL/SITE EVALUATION
for ON-SITE WASTEWATER SYSTEM

Owner: Applicant: **Geraldine True Love**

Address: **3164 Oak Ridge River** Date Evaluated:

Proposed Facility: **EX SFD** Design Flow (.1949): **360**

Location of Site: Property Recorded:

Water Supply: Public Individual Well

Evaluation Method: Auger Boring Pit Cut

Type of Wastewater: Sewage Industrial Process

Property Size:

Spring Other

Mixed

P R O F I L E #	.1940 Landscape Position/ Slope %	Horizon Depth (In.)	SOIL MORPHOLOGY		OTHER PROFILE FACTORS				Profile Class & LTAR
			.1941		.1942 Soil Wetness/ Color	.1943 Soil Depth (IN.)	.1956 Sapro Class	.1944 Restr Horiz	
			.1941 Structure/ Texture	.1941 Consistence Mineralogy					
1		0-12	SL	FL, GR, NS, NP					
		12-42	S Clay	FI, SBK, S, P	36"	42"			.4

Description	Initial System	Repair System	Other Factors (.1946):
Available Space (.1945)			Site Classification (.1948): PS
System Type(s)		25070	Evaluated By: [Signature]
Site LTAR		4	Others Present:

COMMENTS: _____

LANDSCAPE POSITIONS	GROUP	TEXTURES	.1955 LTAR	CONSISTENCE MOIST	WET
R-RIDGE	I	S-SAND	1.2 - 0.8	VFR-VERY FRIABLE FR-FRIABLE	NS-NON-STICKY SS-SLIGHTLY STICKY
S-SHOULDER SLOPE		LS-LOAMY SAND			
L-LINEAR SLOPE	II	SL-SANDY LOAM	0.8 - 0.6	FI-FIRM VFI-VERY FIRM EFI-EXTREMELY FIRM	S-STICKY VS-VERY STICKY
FS-FOOT SLOPE		L-LOAM			
N-NOSE SLOPE	III	SI-SILT	0.6 - 0.3		NP-NON-PLASTIC SP-SLIGHTLY STICKY
H-HEAD SLOPE		SIL-SILT LOAM			
CC-CONCLAVE SLOPE		CL-CLAY LOAM			
CV-CONVEX SLOPE		SCL-SANDY CLAY LOAM			
T-TERRACE	IV	SIC-SILTY CLAY	0.4 - 0.1		P-PLASTIC VP-VERY PLASTIC
FP-FLOOD PLAN		C-CLAY SC-SANDY CLAY			

STRUCTURE
 SG-SINGLE GRAIN
 M- MASSIVE
 CR-CRUMB
 GR-GRANULAR
 SBK-SUBANGULAR BLOCKY
 ABK-ANGULAR BLOCKY
 PL-PLATY
 PR-PRISMATIC

MINERALOGY
 SLIGHTLY EXPANSIVE
 EXPANSIVE

Show profile locations and other site features (dimensions, references or benchmark, and North)

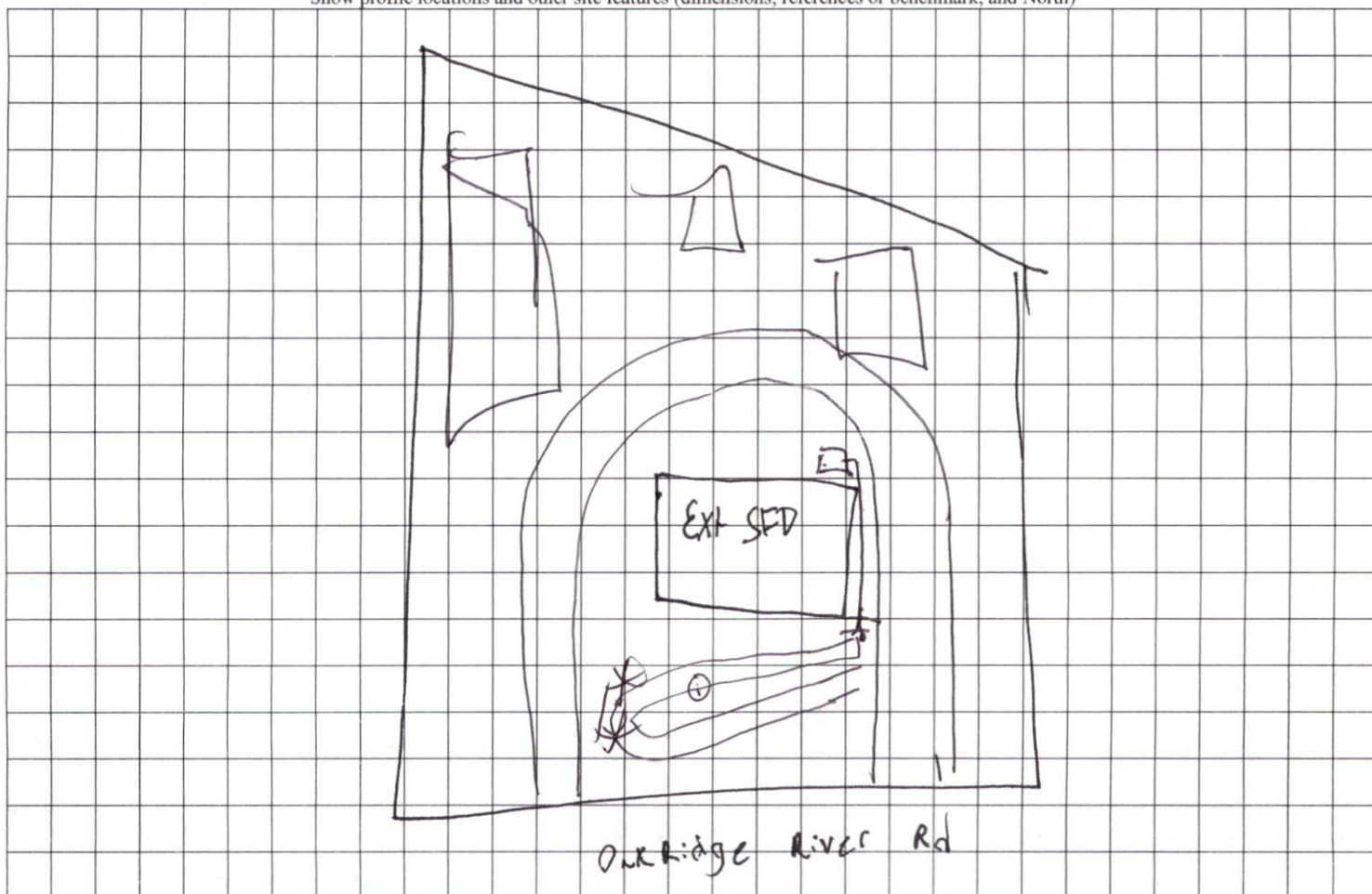



Harnett County GIS

PID: 050644 0013
PIN: 0634-98-9165.000
Account Number: 1400020220
Owner: TRUELOVE GERALDINE B
Mailing Address: 3164 OAKRIDGE RIVER ROAD FUQUAY VARINA, NC 27526-0000
Physical Address: 3164 OAKRIDGE RIVER RD FUQUAY VARINA, NC 27526 ac
Description: .67 ACRES TRUELOVE
Surveyed/Deeded Acreage: 0.67
Calculated Acreage: 0.53
Deed Date: 1095915600000
Deed Book/Page: 4E - 0538
Plat(Survey) Book/Page: -
Last Sale: 2004 - 9
Sale Price: \$0
Qualified Code: E
Vacant or Improved: I
Transfer of Split: T
Actual Year Built: 1962
Heated Area : 1265 SqFt
Building Count : 1

Building Value: \$90082
Parcel Outbuilding Value: \$4770
Parcel Land Value: 57640
Market Value: \$152492
Deferred Value: \$0
Total Assessed Value: \$152492
Zoning: RA-20M - 0.53 acres (100.0%)
Zoning Jurisdiction: Harnett County
Wetlands: No
FEMA Flood: Minimal Flood Risk
Within 1mi of Agriculture District: Yes
Elementary School: Northwest Harnett Elementary
Middle School: Harnett Central Middle
High School: Harnett Central High
Fire Department: Northwest Harnett
EMS Department: Medic 14
Law Enforcement: Harnett County Sheriff
Voter Precinct: Northwest Harnett
County Commissioner : Lewis Weatherspoon
School Board Member: Duncan Jagers



0-12 SL FR @ 2ND
 12-425 CING FR @ S.B.K.S.P.
 OUT AT 36'