

Harnett County Department of Public Health

PERMIT # EH 2305-0009

Operation Permit

New Installation Septic Tank Nitrification Line Repair Expansion

PROPERTY LOCATION: SR 1841 George Penny Lee RD

Name: (owner) EHC Properties SUBDIVISION _____ LOT # _____

System Installer: Thomas Cooper

Basement with plumbing: Garage Number of Bedrooms 5 Employees

Type of Water Supply: Community Public Well Distance from well _____ feet

System Type: Septic Tank + Pump Tank to BVS System Types V and VI Systems expire in 5 years.

(In accordance with Table V a) Owner must contact Health Department 6 months prior to expiration for permit renewal.

This system has been installed in compliance with applicable North Carolina General Statutes, Rules for Sewage Treatment and Disposal, and all conditions of the Improvement Permit and Construction Authorization.

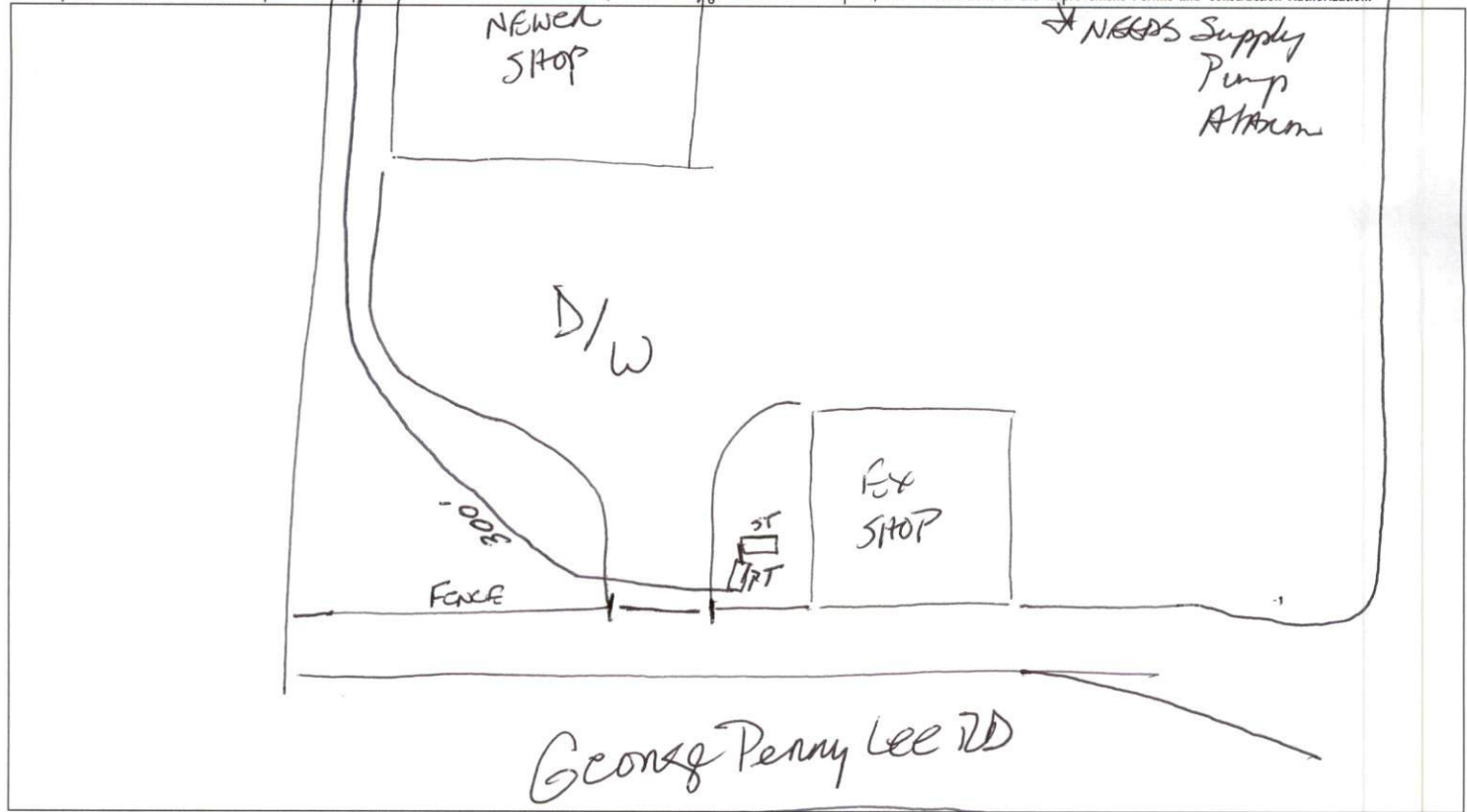

PERMIT CONDITIONS:

- I. Performance: System shall perform in accordance with Rule .1961.
- II. Monitoring: As required by Rule .1961.
- III. Maintenance: As required by Rule .1961. Other: _____
Subsurface system operator required? Yes No ON RAMP to I-95
If yes, see attached sheet for additional operation conditions, maintenance and reporting.
- IV. Operation: _____
- V. Other: _____

D-Box Pump Alarm H2O Line PWR Line

Following are the specifications for the sewage disposal system on the above captioned property.

Type of system: Conventional Other Septic + Pump Tank Septic Tank: 1,000 gallons Pump Tank: 1,000 gallons

Subsurface No. of exact length width of depth of

Drainage Field ditches EX of each ditch EX feet ditches EX feet ditches EX inches

French Drain Required: _____ Linear feet

Authorized State Agent Mah [Signature] REHS Date 7-14-23