

App# EH2305-0004

# Harnett County Department of Public Health Improvement Permit

Repair  
Drain Lines

A building permit cannot be issued with only an Improvement Permit

PROPERTY LOCATION: 970 Creekview Ln (SR 2039)

ISSUED TO: John Coats Jr

SUBDIVISION \_\_\_\_\_

LOT # \_\_\_\_\_

NEW  REPAIR  EXPANSION

Site Improvements required prior to Construction Authorization Issuance: \_\_\_\_\_

Type of Structure: existing home

Proposed Wastewater System Type: 25% reduction

Projected Daily Flow: 480 GPD

Number of bedrooms: 4 Number of Occupants: 8 max

Basement  Yes  No

Pump Required:  Yes  No

May be required based on final location and elevations of facilities

Type of Water Supply:  Community  Public  Well Distance from well \_\_\_\_\_ feet

Permit valid for:  Five years  
 No expiration

Permit conditions: \_\_\_\_\_

Authorized State Agent: Mel A REHS

Date: 6-9-23

SEE ATTACHED SITE SKETCH

The issuance of this permit by the Health Department in no way guarantees the issuance of other permits. The permit holder is responsible for checking with appropriate governing bodies in meeting their requirements. This site is subject to revocation if the site plan, plat, or the intended use changes. The Improvement Permit shall not be affected by a change in ownership of the site. This permit is subject to compliance with the provisions of the Laws and Rules for Sewage Treatment and Disposal and to conditions of this permit.

## Construction Authorization

(Required for Building Permit)

The construction and installation requirements of Rules 1950, 1952, 1954, 1955, 1956, 1957, 1958 and 1959 are incorporated by references into this permit and shall be met. Systems shall be installed in accordance with the attached system layout.

ISSUED TO: John Coats Jr

PROPERTY LOCATION: 970 Creekview Ln (SR 2039)

SUBDIVISION \_\_\_\_\_

LOT # \_\_\_\_\_

Facility Type: existing home  New  Expansion  Repair

Basement?  Yes  No Basement Fixtures?  Yes  No

Type of Wastewater System\*\* \_\_\_\_\_ (Initial) Wastewater Flow: 480 GPD

(See note below, if applicable )

25% reduction (Repair)

Installation Requirements/Conditions

Septic Tank Size Existing gallons

Pump Tank Size \_\_\_\_\_ gallons

Number of trenches 3

Exact length of each trench 50 feet

Trenches shall be installed on contour at a

Maximum Trench Depth of: 18-30 inches

(Trench bottoms shall be level to +/- 1/4"

in all directions)

Trench Spacing: 9 Feet on Center

Soil Cover: 6 inches

(Maximum soil cover shall not exceed

36" above the trench bottom)

Pump Requirements: \_\_\_\_\_ ft TDH vs. \_\_\_\_\_ GPM

Aggregate Depth: \_\_\_\_\_ inches below pipe  
\_\_\_\_\_ inches above pipe  
\_\_\_\_\_ inches total

Conditions: Reconnect tank and new dbx to existing drain lines

Run lines to make sure no root blockage

**WATER LINES (INCLUDING IRRIGATION) MUST BE 10FT. FROM ANY PART OF SEPTIC SYSTEM OR REPAIR AREA.**

**NO UTILITIES ALLOWED IN INITIAL OR REPAIR DRAIN FIELD AREA.**

\*\*If applicable: I understand the system type specified is different from the type specified on the application. I accept the specifications of this permit.

Owner/Legal Representative Signature: \_\_\_\_\_

Date: \_\_\_\_\_

This Construction Authorization is subject to revocation if the site plan, plat, or the intended use changes. The Construction Authorization shall not be transferred when there is a change in ownership of the site. This Construction Authorization is subject to compliance with the provisions of the Laws and Rules for Sewage Treatment and Disposal and to the conditions of this permit.

SEE ATTACHED SITE SKETCH

Authorized State Agent: Mel A REHS

Date: 6-9-23

Construction Authorization Expiration Date: 12-9-23

Application # EH2305-0004

## Harnett County Department of Public Health Site Sketch

Property Location: 970 Creekview Ln (SR 2039)

Issued To: John Coats Jr

Subdivision \_\_\_\_\_

Lot # \_\_\_\_\_

Authorized State Agent: *[Signature]*

Date: 6-9-23

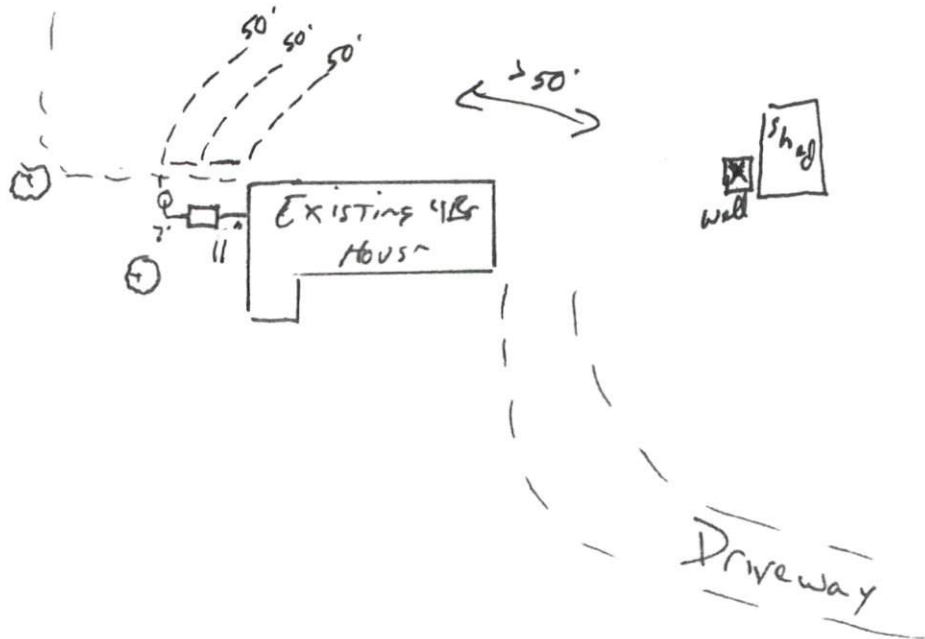

This drawing is for illustrative purposes only. System installation must meet all pertinent laws, rules, and regulations.