

# Harnett County Department of Public Health Improvement Permit

*Repair*

A building permit cannot be issued with only an Improvement Permit

ISSUED TO: Carl Zabel PROPERTY LOCATION: 12558 McDougald Rd (SR 1229)  
 SUBDIVISION \_\_\_\_\_ LOT # \_\_\_\_\_  
 NEW  REPAIR  EXPANSION  Site Improvements required prior to Construction Authorization Issuance: \_\_\_\_\_  
 Type of Structure: Existing  
 Proposed Wastewater System Type: Existing  
 Projected Daily Flow: 240 GPD  
 Number of bedrooms: \_\_\_\_\_ Number of Occupants: \_\_\_\_\_ max  
 Basement  Yes  No  
 Pump Required:  Yes  No  May be required based on final location and elevations of facilities  
 Type of Water Supply:  Community  Public  Well Distance from well \_\_\_\_\_ feet Permit valid for:  Five years  
 No expiration  
 Permit conditions: \_\_\_\_\_

Authorized State Agent: *Moh A. REHS* Date: 04-27-23 SEE ATTACHED SITE SKETCH  
 The issuance of this permit by the Health Department in no way guarantees the issuance of other permits. The permit holder is responsible for checking with appropriate governing bodies in meeting their requirements. This site is subject to revocation if the site plan, plat, or the intended use changes. The Improvement Permit shall not be affected by a change in ownership of the site. This permit is subject to compliance with the provisions of the Laws and Rules for Sewage Treatment and Disposal and to conditions of this permit.

## Construction Authorization

(Required for Building Permit)

The construction and installation requirements of Rules .1950, .1952, .1954, .1955, .1956, .1957, .1958, and .1959 are incorporated by references into this permit and shall be met. Systems shall be installed in accordance with the attached system layout.

ISSUED TO: Carl Zabel PROPERTY LOCATION: 12558 McDougald Rd (SR 1229)  
 SUBDIVISION \_\_\_\_\_ LOT # \_\_\_\_\_  
 Facility Type: Existing  New  Expansion  Repair  
 Basement?  Yes  No Basement Fixtures?  Yes  No  
 Type of Wastewater System\*\* (Initial) Wastewater Flow: 240 GPD  
 (See note below, if applicable )

Tank and dbox (Repair)

Installation Requirements/Conditions  
 Septic Tank Size 1000 gallons Exact length of each trench Existing feet Trench Spacing: Existing Feet on Center  
 Pump Tank Size \_\_\_\_\_ gallons Trenches shall be installed on contour at a Soil Cover: Existing inches  
 Maximum Trench Depth of: Existing inches (Maximum soil cover shall not exceed 36" above the trench bottom)  
 (Trench bottoms shall be level to +/-1/4" in all directions)  
 Pump Requirements: \_\_\_\_\_ ft. TDH vs. \_\_\_\_\_ GPM \_\_\_\_\_ inches below pipe  
 Aggregate Depth: \_\_\_\_\_ inches above pipe  
 \_\_\_\_\_ inches total  
 Conditions: Set New Septic Tank & Dbox. Run Drain Line & Clear root blockage. Tie New Dbox into lines

WATER LINES (INCLUDING IRRIGATION) MUST BE 10FT. FROM ANY PART OF SEPTIC SYSTEM OR REPAIR AREA.  
NO UTILITIES ALLOWED IN INITIAL OR REPAIR DRAIN FIELD AREA.

\*\*If applicable: I understand the system type specified is different from the type specified on the application. I accept the specifications of this permit.

Owner/Legal Representative Signature: \_\_\_\_\_ Date: \_\_\_\_\_

This Construction Authorization is subject to revocation if the site plan, plat, or the intended use changes. The Construction Authorization shall not be transferred when there is a change in ownership of the site. This Construction Authorization is subject to compliance with the provisions of the Laws and Rules for Sewage Treatment and Disposal and to the conditions of this permit. SEE ATTACHED SITE SKETCH

Authorized State Agent: *Moh A. REHS* Date: 04-27-23  
 Construction Authorization Expiration Date: 10-27-23

Application # EH2304-0008

*Repair*

Harnett County Department of Public Health  
Site Sketch

Property Location: 12558 McDougald Rd (SR 1229)

Issued To: Carl Zabel

Subdivision \_\_\_\_\_

Lot # \_\_\_\_\_

Authorized State Agent: \_\_\_\_\_

*Mohammed RETH*

Date: 04-27-23

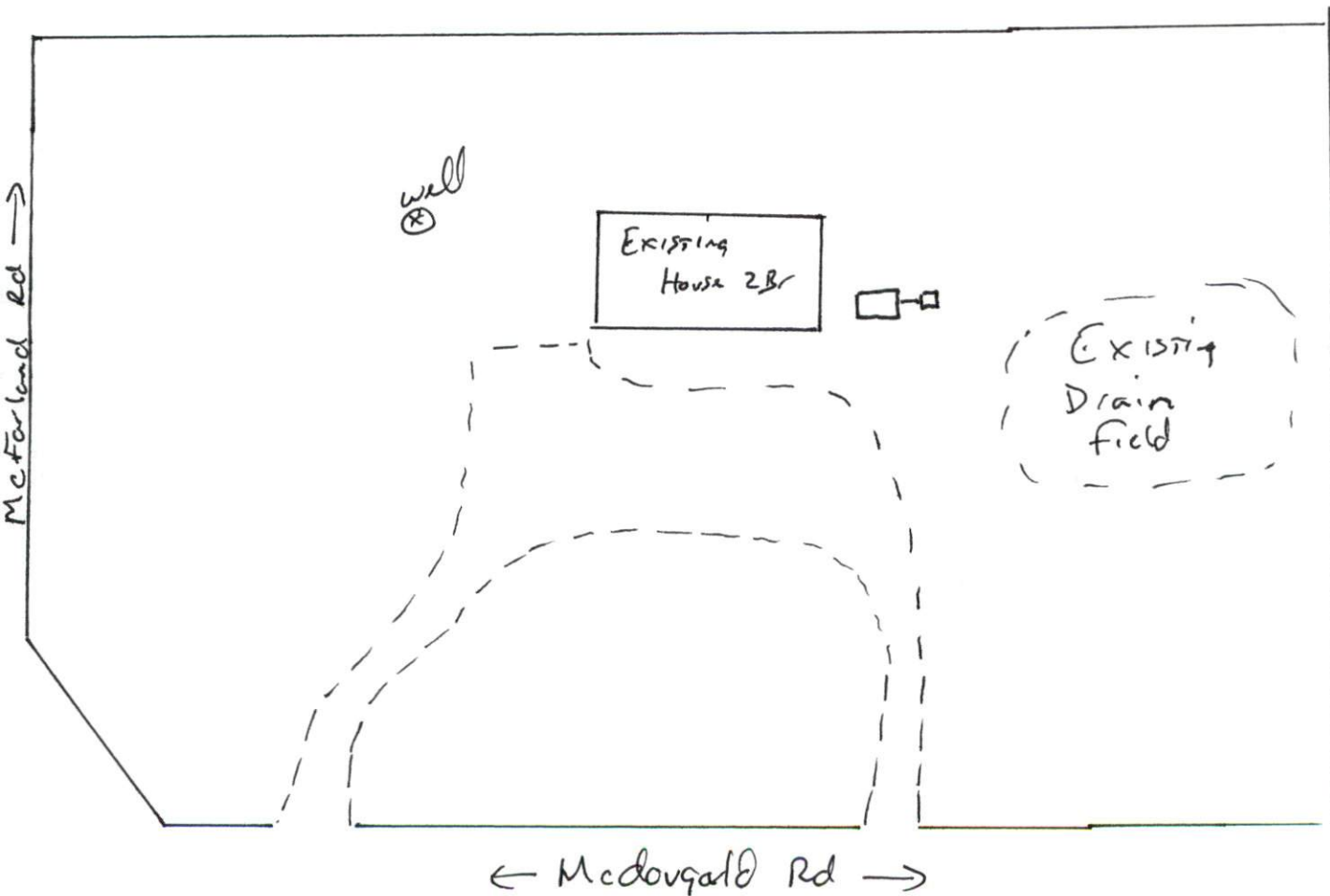

This drawing is for illustrative purposes only. System installation must meet all pertinent laws, rules, and regulations.