

## Harnett County Department of Public Health Improvement Permit

A building permit cannot be issued with only an Improvement Permit

ISSUED TO: Gwenn Glotnis PROPERTY LOCATION: 80 Starlight Dr (SR 1265)  
 SUBDIVISION New Horizons LOT # 4  
 NEW  REPAIR  EXPANSION  Site Improvements required prior to Construction Authorization Issuance:  
 Type of Structure: Existing Home  
 Proposed Wastewater System Type: \_\_\_\_\_  
 Projected Daily Flow: \_\_\_\_\_ GPD  
 Number of bedrooms: \_\_\_\_\_ Number of Occupants: \_\_\_\_\_ max  
 Basement  Yes  No  
 Pump Required:  Yes  No  May be required based on final location and elevations of facilities  
 Type of Water Supply:  Community  Public  Well Distance from well \_\_\_\_\_ feet Permit valid for:  Five years  
 Permit conditions: \_\_\_\_\_  No expiration

**Curtain drain needed to divert lateral around water**

Authorized State Agent: *Mph [Signature] REHS* Date: 1-30-23 SEE ATTACHED SITE SKETCH  
 The issuance of this permit by the Health Department in no way guarantees the issuance of other permits. The permit holder is responsible for checking with appropriate governing bodies in meeting their requirements. This site is subject to revocation if the site plan, plat, or the intended use changes. The Improvement Permit shall not be affected by a change in ownership of the site. This permit is subject to compliance with the provisions of the Laws and Rules for Sewage Treatment and Disposal and to conditions of this permit.

### Construction Authorization (Required for Building Permit)

The construction and installation requirements of Rules .1950, .1952, .1954, .1955, .1956, .1957, .1958, and .1959 are incorporated by references into this permit and shall be met. Systems shall be installed in accordance with the attached system layout.

ISSUED TO: Gwenn Glotnis PROPERTY LOCATION: 80 Starlight Dr (SR 1265)  
 SUBDIVISION New Horizons LOT # 4  
 Facility Type: Existing Home  New  Expansion  Repair  
 Basement?  Yes  No Basement Fixtures?  Yes  No  
 Type of Wastewater System\*\* \_\_\_\_\_ (Initial) Wastewater Flow: \_\_\_\_\_ GPD  
 (See note below, if applicable ) \_\_\_\_\_ (Repair)

**Installation Requirements/Conditions**

Septic Tank Size <u>Existing</u> gallons	Number of trenches _____	Trench Spacing: _____ Feet on Center
Pump Tank Size _____ gallons	Exact length of each trench _____ feet	Soil Cover: _____ inches
	Trenches shall be installed on contour at a	(Maximum soil cover shall not exceed
	Maximum Trench Depth of: _____ inches	36" above the trench bottom)
	(Trench bottoms shall be level to +/-1/4"	
	in all directions)	
Pump Requirements: _____ ft. TDH vs. _____ GPM		_____ inches below pipe
		Aggregate Depth: _____ inches above pipe
Conditions: <u>Curtain drain needed to divert lateral ground water</u>		_____ inches total

**WATER LINES (INCLUDING IRRIGATION) MUST BE 10FT. FROM ANY PART OF SEPTIC SYSTEM OR REPAIR AREA.  
 NO UTILITIES ALLOWED IN INITIAL OR REPAIR DRAIN FIELD AREA.**

\*\*If applicable: I understand the system type specified is different from the type specified on the application. I accept the specifications of this permit.

Owner/Legal Representative Signature: \_\_\_\_\_ Date: \_\_\_\_\_

This Construction Authorization is subject to revocation if the site plan, plat, or the intended use changes. The Construction Authorization shall not be transferred when there is a change in ownership of the site. This Construction Authorization is subject to compliance with the provisions of the Laws and Rules for Sewage Treatment and Disposal and to the conditions of this permit. SEE ATTACHED SITE SKETCH

Authorized State Agent: *Mph [Signature] REHS* Date: 1-30-23  
 Construction Authorization Expiration Date: 6-30-23

Application # EH2301-0019

## Harnett County Department of Public Health Site Sketch

Property Location: 80 Starlight Dr (SR 1265)

Issued To: Gwenn Glotnis

Subdivision New Horizons

Lot # 4

Authorized State Agent: Mah [Signature] REIT

Date: 1-30-23

(upslope)  
A 36" Deep Curtain Drain will be required above the EXISTING septic system. Plastic must cover bottom of the Drain Ditch and entire Downslope wall. Plastic must be unbroken/continuous from end to end of Curtain Drain. Daylight both sides of Drain on bottom of the lot.  
\* Tie in EXISTING Downspout Drains to the new Curtain Drain

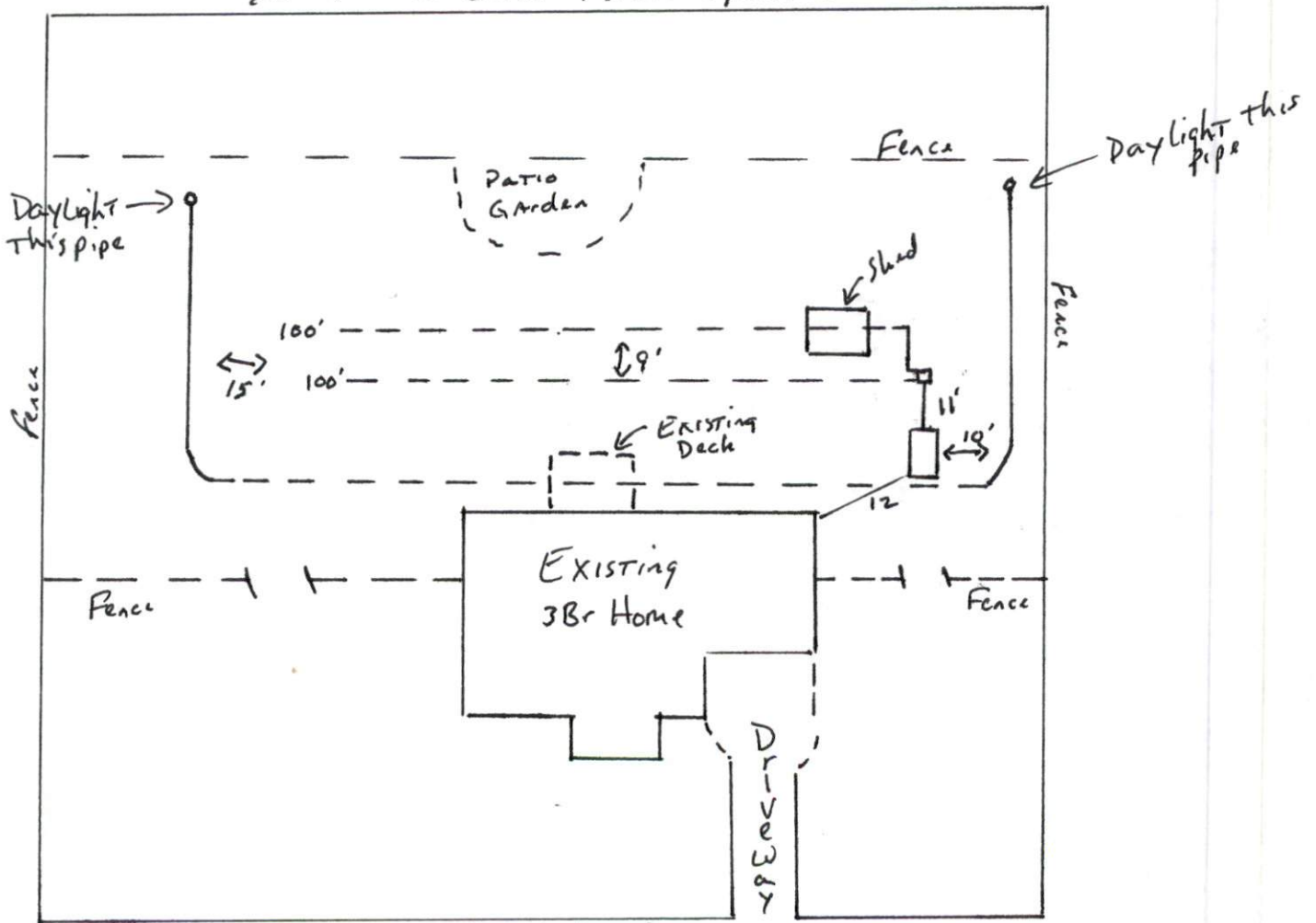

This drawing is for illustrative purposes only. System installation must meet all pertinent laws, rules, and regulations.