

# Harnett County Department of Public Health

## Improvement Permit

A building permit cannot be issued with only an Improvement Permit

ISSUED TO: JOHN WALSH PROPERTY LOCATION: 266 YOUNG ROAD (S21546)  
 SUBDIVISION \_\_\_\_\_ LOT # \_\_\_\_\_  
 NEW  REPAIR  EXPANSION   
 Type of Structure: EXT 3-BED ROOM STD  
 Proposed Wastewater System Type: EXT SYSTEM  
 Projected Daily Flow: 360 GPD  
 Number of bedrooms: 3 Number of Occupants: 6 max  
 Basement  Yes  No  
 Pump Required:  Yes  No  May be required based on final location and elevations of facilities  
 Type of Water Supply:  Community  Public  Well Distance from well 50+ feet  
 Permit conditions: \_\_\_\_\_ Permit valid for:  Five years  No expiration

Authorized State Agent: [Signature] Date: 07/15/2022 SEE ATTACHED SITE SKETCH  
 The issuance of this permit by the Health Department in no way guarantees the issuance of other permits. The permit holder is responsible for checking with appropriate governing bodies in meeting their requirements. This site is subject to revocation if the site plan, plat, or the intended use changes. The Improvement Permit shall not be affected by a change in ownership of the site. This permit is subject to compliance with the provisions of the Laws and Rules for Sewage Treatment and Disposal and to conditions of this permit.

## Construction Authorization

(Required for Building Permit)

The construction and installation requirements of Rules .1950, .1952, .1954, .1955, .1956, .1957, 1958, and .1959 are incorporated by references into this permit and shall be met. Systems shall be installed in accordance with the attached system layout.

ISSUED TO: JOHN WALSH PROPERTY LOCATION: 266 YOUNG ROAD (S21546)  
 SUBDIVISION \_\_\_\_\_ LOT # \_\_\_\_\_  
 Facility Type: EXT 3-BED STD  New  Expansion  Repair  
 Basement?  Yes  No Basement Fixtures?  Yes  No  
 Type of Wastewater System\*\* EXISTING SYSTEM (Initial) Wastewater Flow: 360 GPD  
 (See note below, if applicable   
25% REDUCTION (FRONT YARD) (Repair)  
 Installation Requirements/Conditions  
 Septic Tank Size 1000 gallons  
 Pump Tank Size \_\_\_\_\_ gallons  
 Number of trenches EXT  
 Exact length of each trench EXT feet  
 Trenches shall be installed on contour at a  
 Maximum Trench Depth of: EXT inches  
 (Trench bottoms shall be level to +/-1/4"  
 in all directions)  
 Trench Spacing: EXT Feet on Center  
 Soil Cover: EXT inches  
 (Maximum soil cover shall not exceed  
 36" above the trench bottom)  
 Pump Requirements: \_\_\_\_\_ ft. TDH vs. \_\_\_\_\_ GPM  
 Aggregate Depth: NA inches below pipe  
NA inches above pipe  
NA inches total  
 Conditions: TANK REPLACEMENT ONLY (PER REPORT)

**WATER LINES (INCLUDING IRRIGATION) MUST BE 10FT. FROM ANY PART OF SEPTIC SYSTEM OR REPAIR AREA.  
 NO UTILITIES ALLOWED IN INITIAL OR REPAIR DRAIN FIELD AREA.**

*\*\*If applicable: I understand the system type specified is different from the type specified on the application. I accept the specifications of this permit.*

Owner/Legal Representative Signature: \_\_\_\_\_ Date: \_\_\_\_\_

This Construction Authorization is subject to revocation if the site plan, plat, or the intended use changes. The Construction Authorization shall not be transferred when there is a change in ownership of the site. This Construction Authorization is subject to compliance with the provisions of the Laws and Rules for Sewage Treatment and Disposal and to the conditions of this permit. SEE ATTACHED SITE SKETCH

Authorized State Agent: [Signature] Date: 07/15/2022  
ANDREW CURRIN Construction Authorization Expiration Date: 07/15/2027

Application # EH 2207-0001

### Harnett County Department of Public Health Site Sketch

Property Location: 206 YONK ROAD (S21546)

Issued To: SOLIN WALSH Subdivision \_\_\_\_\_ Lot # \_\_\_\_\_

Authorized State Agent: *Andrew Corbin* Date: 07/15/2022  
ANDREW CORBIN

\* TANK REPLACEMENT ONLY

- ↳ PER SEPTIC REPORT [WIN HOME INSPECTIONS] ONLY TANK + D-BOX REPLACEMENT ONLY - TO CLOSE TO HOME
- ↳ DRAINFIELD AND FLOW INSPECTION ADVISED PRE-INSTALL
- ↳ RISERS LIKELY REQUIRED [CHECK PLUMBING]

UNSUITABLE  
SOILS

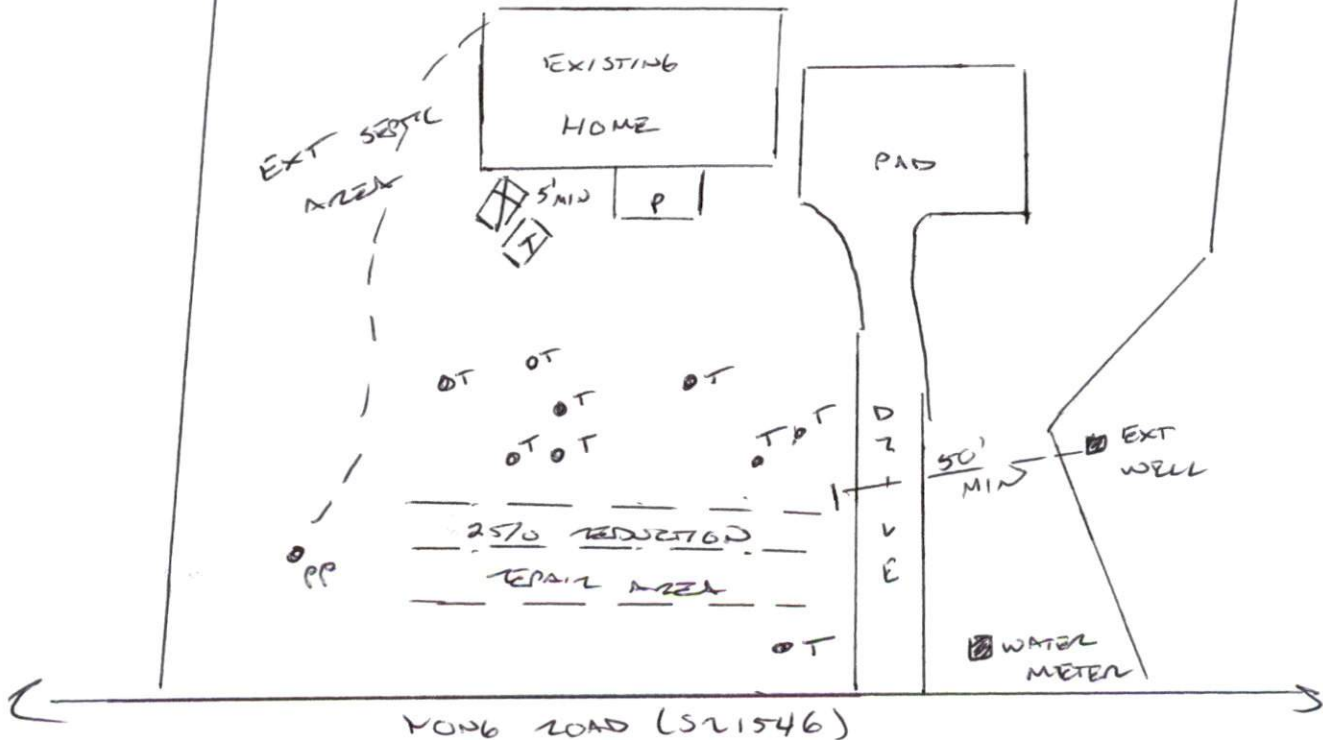

This drawing is for illustrative purposes only. System installation must meet all pertinent laws, rules, and regulations.