

# Harnett County Department of Public Health

## Improvement Permit

A building permit cannot be issued with only an Improvement Permit

SL 1446

ISSUED TO: MARK + TARA DOULTON

PROPERTY LOCATION: 130 WEXFORD DR. (PORTER ROAD)

SUBDIVISION: WEXFORD SID LOT # 7

NEW  REPAIR  EXPANSION

Site Improvements required prior to Construction Authorization Issuance:

Type of Structure: EXT 3-BEDROOM SID

Proposed Wastewater System Type: EXT SEPTIC AREA

Projected Daily Flow: 360 GPD

Number of bedrooms: 3 Number of Occupants: 6 max

Basement  Yes  No

Pump Required:  Yes  No  May be required based on final location and elevations of facilities

Type of Water Supply:  Community  Public  Well Distance from well NA feet

Permit valid for:  Five years  No expiration

Permit conditions:

Authorized State Agent: [Signature]

Date: 06/07/2022

SEE ATTACHED SITE SKETCH

The issuance of this permit by the Health Department in no way guarantees the issuance of other permits. The permit holder is responsible for checking with appropriate governing bodies in meeting their requirements. This site is subject to revocation if the site plan, plat, or the intended use changes. The Improvement Permit shall not be affected by a change in ownership of the site. This permit is subject to compliance with the provisions of the Laws and Rules for Sewage Treatment and Disposal and to conditions of this permit.

## Construction Authorization

(Required for Building Permit)

The construction and installation requirements of Rules .1950, .1952, .1954, .1955, .1956, .1957, .1958, and .1959 are incorporated by references into this permit and shall be met. Systems shall be installed in accordance with the attached system layout.

ISSUED TO: MARK + TARA DOULTON

PROPERTY LOCATION: 130 WEXFORD DR. (PORTER ROAD)

SUBDIVISION: WEXFORD SID LOT # 7

Facility Type: EXT 3-BED SID  New  Expansion  Repair

Basement?  Yes  No Basement Fixtures?  Yes  No

Type of Wastewater System\*\* EXISTING CONVENTIONAL SIS (Initial) Wastewater Flow: 360 GPD

(See note below, if applicable )

EXT LPP AREA (Repair)

### Installation Requirements/Conditions

Septic Tank Size 1000 gallons

Pump Tank Size \_\_\_\_\_ gallons

Number of trenches EXT

Exact length of each trench EXT feet

Trenches shall be installed on contour at a

Maximum Trench Depth of: EXT inches

(Trench bottoms shall be level to +/- 1/4"

in all directions)

Trench Spacing: EXT Feet on Center

Soil Cover: EXT inches

(Maximum soil cover shall not exceed

36" above the trench bottom)

Pump Requirements: \_\_\_\_\_ ft. TDH vs. \_\_\_\_\_ GPM

EXT inches below pipe

Aggregate Depth: EXT inches above pipe

Conditions: TANK REPLACEMENT ONLY (MAYBE D-BOX)

EXT inches total

**WATER LINES (INCLUDING IRRIGATION) MUST BE 10FT. FROM ANY PART OF SEPTIC SYSTEM OR REPAIR AREA.**

**NO UTILITIES ALLOWED IN INITIAL OR REPAIR DRAIN FIELD AREA.**

\*\*If applicable: I understand the system type specified is different from the type specified on the application. I accept the specifications of this permit.

Owner/Legal Representative Signature: \_\_\_\_\_

Date: \_\_\_\_\_

This Construction Authorization is subject to revocation if the site plan, plat, or the intended use changes. The Construction Authorization shall not be transferred when there is a change in ownership of the site. This

Construction Authorization is subject to compliance with the provisions of the Laws and Rules for Sewage Treatment and Disposal and to the conditions of this permit.

SEE ATTACHED SITE SKETCH

Authorized State Agent: [Signature]

Date: 06/07/2022

ANDREW COLEMAN

Construction Authorization Expiration Date: 06/07/2027

Application # EH 2206-001

## Harnett County Department of Public Health Site Sketch

Property Location: 130 WEXFOLD DRIVE (PULFORD RD. - SR 1446)  
Issued To: MARK + TARA BOULTON Subdivision WEXFOLD S/D Lot # 7

Authorized State Agent: *Andrew Corbin* Date: 06/07/2022  
ANDREW CORBIN

- \* TANK REPLACEMENT ONLY
- \* EXT TANK SHALL BE PUMP, CRUSHED, AND BACKFILLED ON-SITE
- \* D-BOX REPLACEMENT LIKELY REQUIRED

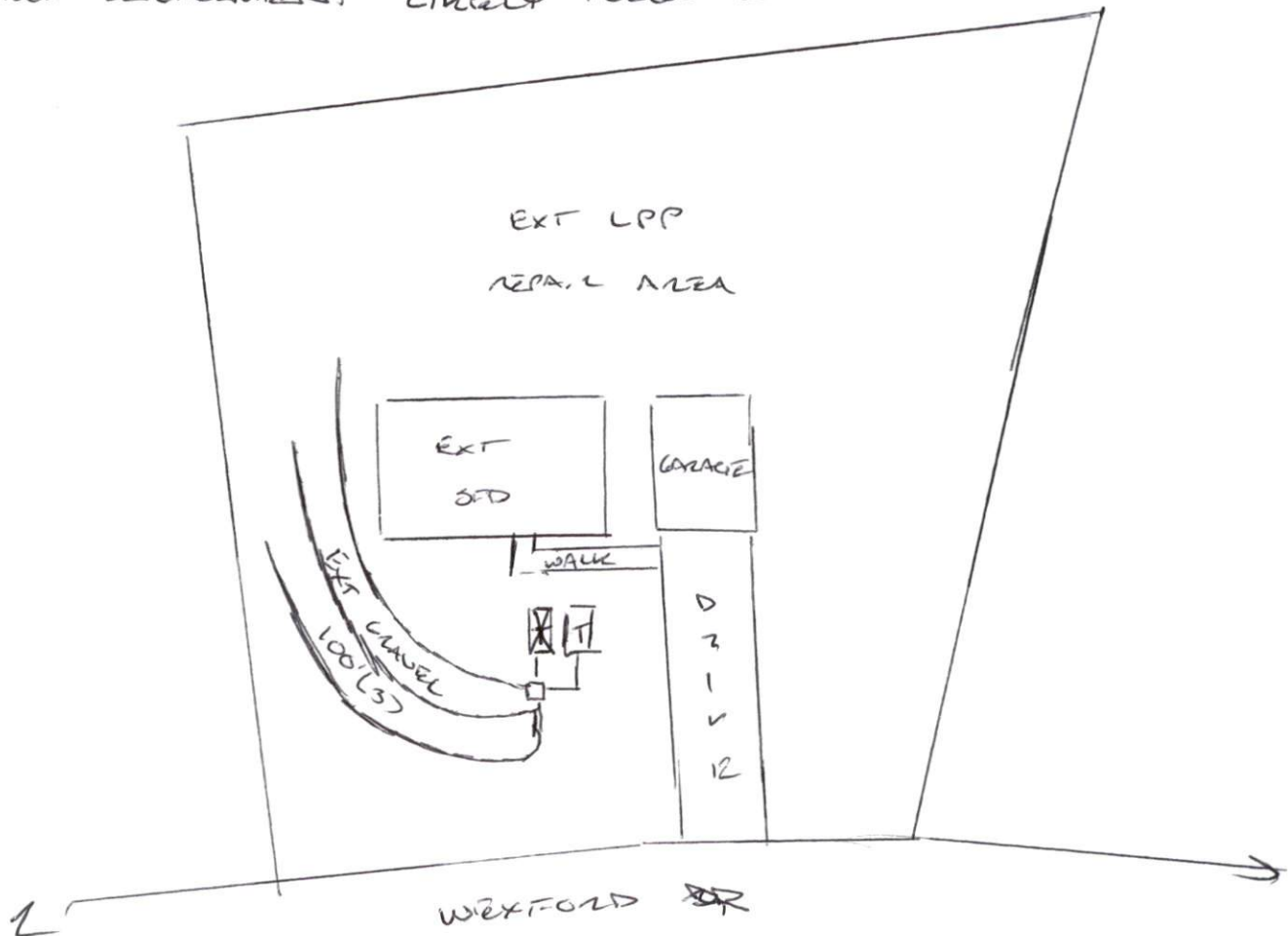

This drawing is for illustrative purposes only. System installation must meet all pertinent laws, rules, and regulations.