

Harnett County Department of Public Health Improvement Permit

A building permit cannot be issued with only an Improvement Permit

ISSUED TO: MITCHELL ALLESON PROPERTY LOCATION: 51121 Ray Rd
 SUBDIVISION: COUNTRY ACRES MHP LOT # _____

NEW REPAIR EXPANSION Site Improvements required prior to Construction Authorization Issuance: _____

Type of Structure: MH + MH IN PARK 7 sum +
 Proposed Wastewater System Type: 50% REDUCTION connected

Projected Daily Flow: 480 GPD 2 per MH
 Number of bedrooms: 4 total Number of Occupants: 8 - 4 per MH max

Basement Yes No
 Pump Required: Yes No May be required based on final location and elevations of facilities

Type of Water Supply: Community Public Well Distance from well _____ feet Permit valid for: Five years
 No expiration

Permit conditions: _____

Authorized State Agent: James E. Marshall JEM Date: 4-29-22 SEE ATTACHED SITE SKETCH

The issuance of this permit by the Health Department in no way guarantees the issuance of other permits. The permit holder is responsible for checking with appropriate governing bodies in meeting their requirements. This site is subject to revocation if the site plan, plat, or the intended use changes. The Improvement Permit shall not be affected by a change in ownership of the site. This permit is subject to compliance with the provisions of the Laws and Rules for Sewage Treatment and Disposal and to conditions of this permit.

Construction Authorization

(Required for Building Permit)

The construction and installation requirements of Rules .1950, .1952, .1954, .1955, .1956, .1957, .1958, and .1959 are incorporated by references into this permit and shall be met. Systems shall be installed in accordance with the attached system layout.

ISSUED TO: MITCHELL ALLESON PROPERTY LOCATION: 51121 Ray Rd
 SUBDIVISION: COUNTRY ACRES MHP LOT # _____

Facility Type: 2 SW MHS New Expansion Repair
 Basement? Yes No Basement Fixtures? Yes No

Type of Wastewater System** _____ (Initial) Wastewater Flow: 480 GPD
 (See note below, if applicable 240 x 240 = 480
50% REDUCTION (PPBS) Paved Block MH + MH

Installation Requirements/Conditions Septic Tank Size <u>1000</u> <u>EXF</u> gallons Pump Tank Size <u>1000</u> gallons	Number of trenches <u>4</u> Exact length of each trench <u>50</u> feet Trenches shall be installed on contour at a Maximum Trench Depth of: <u>18"-20"</u> inches (Trench bottoms shall be level to +/- 1/4" in all directions)	Trench Spacing: <u>7</u> Feet on Center Soil Cover: <u>6</u> inches (Maximum soil cover shall not exceed 36" above the trench bottom)
--	--	--

Pump Requirements: _____ ft. TDH vs. _____ GPM Aggregate Depth: 6 inches below pipe
2 inches above pipe
 Conditions: Contractor to meet ON SITE plans 12 inches total
Attempt to Repair INSTALL

**WATER LINES (INCLUDING IRRIGATION) MUST BE 10FT. FROM ANY PART OF SEPTIC SYSTEM OR REPAIR AREA.
 NO UTILITIES ALLOWED IN INITIAL OR REPAIR DRAIN FIELD AREA.**

**If applicable: I understand the system type specified is different from the type specified on the application. I accept the specifications of this permit.

Owner/Legal Representative Signature: _____ Date: _____

This Construction Authorization is subject to revocation if the site plan, plat, or the intended use changes. The Construction Authorization shall not be transferred when there is a change in ownership of the site. This Construction Authorization is subject to compliance with the provisions of the Laws and Rules for Sewage Treatment and Disposal and to the conditions of this permit. SEE ATTACHED SITE SKETCH

Authorized State Agent: James E. Marshall JEM Date: 4-29-22
 Construction Authorization Expiration Date: 4-29-27

Application # EH2204-0012

Harnett County Department of Public Health
Site Sketch

Property Location: SR 1121 Ray Rd
Issued To: Metze D Alford Subdivision Countryside MHA Lot # _____

Authorized State Agent: James E. Mankin Date: 4-29-22

- * Attempt to Repair - NO SPACES AVAILABLE - NEXT OPTION IS MHA Removal.
- * Contractor to meet ON SITE prior to INSTALL.

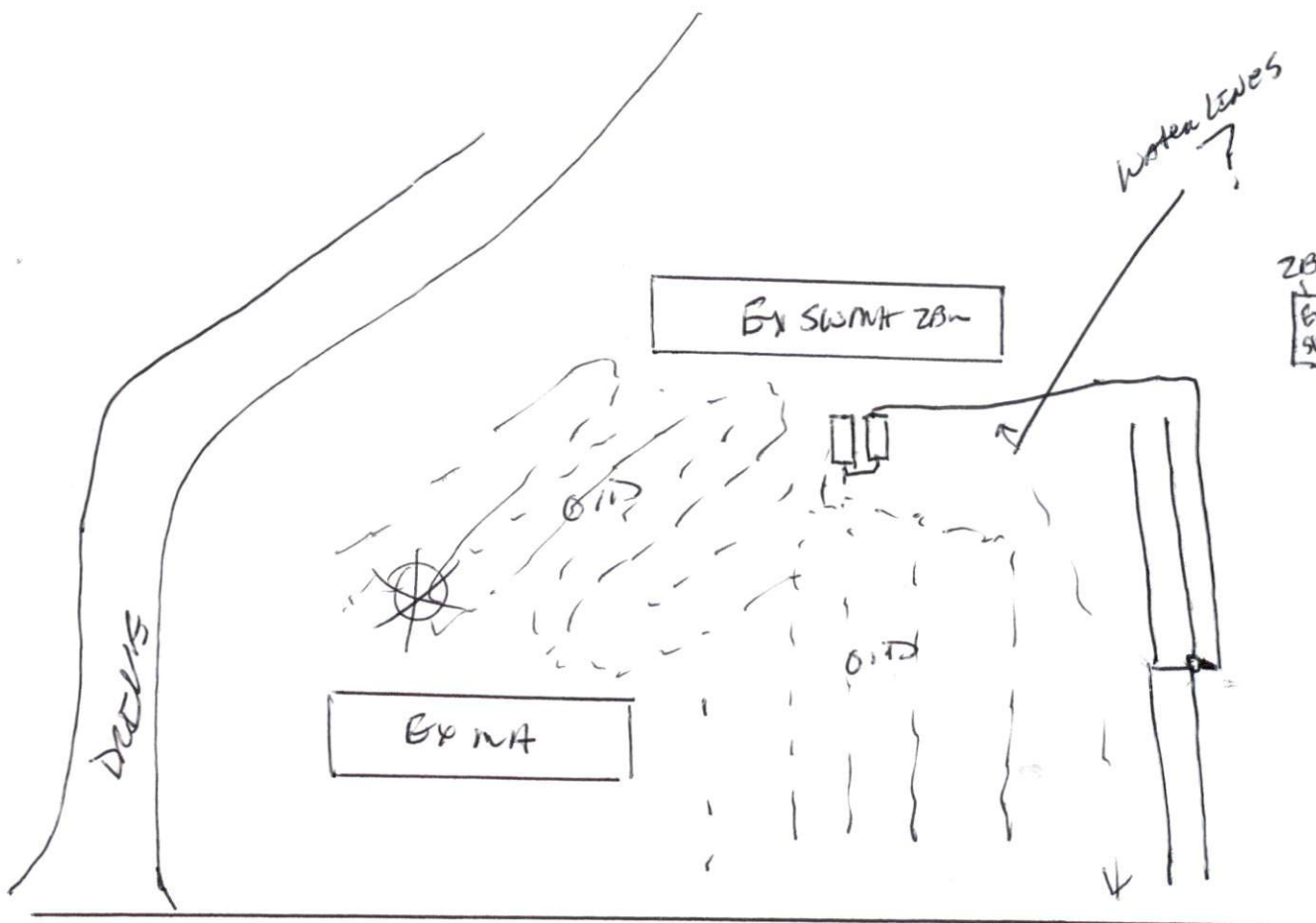

SR 1121 Ray Rd

This drawing is for illustrative purposes only. System installation must meet all pertinent laws, rules, and regulations.