

HTE# 11-5-27827

# Harnett County Department of Public Health Improvement Permit

26548

A building permit cannot be issued with only an Improvement Permit

ISSUED TO: Elizabeth BLOW / STEVE Miglicec PROPERTY LOCATION: 521418 OAKRIDGE REVER RD  
 SUBDIVISION \_\_\_\_\_ LOT # \_\_\_\_\_  
 NEW  REPAIR  EXPANSION   
 Type of Structure: DWNT Site Improvements required prior to Construction Authorization Issuance: \_\_\_\_\_  
 Proposed Wastewater System Type: CONVENTIONAL  
 Projected Daily Flow: 360 GPD  
 Number of bedrooms: 3 Number of Occupants: 6 max  
 Basement  Yes  No  
 Pump Required:  Yes  No  May be required based on final location and elevations of facilities  
 Type of Water Supply:  Community  Public  Well Distance from well \_\_\_\_\_ feet Permit valid for:  Five years  
 Permit conditions: \_\_\_\_\_  No expiration

CONTRACTOR TO MEET ON SITE PRIOR

Authorized State Agent: James E. Mark Date: 11-15-11 SEE ATTACHED SITE SKETCH  
 The issuance of this permit by the Health Department in no way guarantees the issuance of other permits. The permit holder is responsible for checking with appropriate governing bodies in meeting their requirements. This site is subject to revocation if the site plan, plat, or the intended use changes. The Improvement Permit shall not be affected by a change in ownership of the site. This permit is subject to compliance with the provisions of the Laws and Rules for Sewage Treatment and Disposal and to conditions of this permit..

## Construction Authorization

(Required for Building Permit)

The construction and installation requirements of Rules .1950, .1952, .1954, .1955, .1956, .1957, .1958, and .1959 are incorporated by references into this permit and shall be met. Systems shall be installed in accordance with the attached system layout.

ISSUED TO: Elizabeth BLOW / STEVE Miglicec PROPERTY LOCATION: 521418 OAKRIDGE REVER RD  
 SUBDIVISION \_\_\_\_\_ LOT # \_\_\_\_\_  
 Facility Type: DWNT  New  Expansion  Repair  
 Basement?  Yes  No Basement Fixtures?  Yes  No  
 Type of Wastewater System\*\* CONVENTIONAL (Initial) Wastewater Flow: 360 GPD  
 (See note below, if applicable  conventional (Repair))

<b>Installation Requirements/Conditions</b>	Number of trenches <u>3</u>	
Septic Tank Size <u>1000</u> gallons	Exact length of each trench <u>133</u> feet	Trench Spacing: <u>07</u> Feet on Center
Pump Tank Size _____ gallons	Trenches shall be installed on contour at a Maximum Trench Depth of: <u>20-7/8</u> inches (Trench bottoms shall be level to +/- 1/4" in all directions)	Soil Cover: <u>6</u> inches (Maximum soil cover shall not exceed 36" above the trench bottom)
Pump Requirements: _____ ft. TDH vs. _____ GPM		Aggregate Depth: <u>6</u> inches below pipe <u>2</u> inches above pipe <u>12</u> inches total
Conditions: <u>Contractor to meet on site prior to install.</u>		

**WATER LINES (INCLUDING IRRIGATION) MUST BE 10FT. FROM ANY PART OF SEPTIC SYSTEM OR REPAIR AREA.  
NO UTILITIES ALLOWED IN INITIAL OR REPAIR DRAIN FIELD AREA.**

\*\*If applicable: I understand the system type specified is different from the type specified on the application. I accept the specifications of this permit.

Owner/Legal Representative Signature: \_\_\_\_\_ Date: \_\_\_\_\_

This Construction Authorization is subject to revocation if the site plan, plat, or the intended use changes. The Construction Authorization shall not be transferred when there is a change in ownership of the site. This Construction Authorization is subject to compliance with the provisions of the Laws and Rules for Sewage Treatment and Disposal and to the conditions of this permit. SEE ATTACHED SITE SKETCH

Authorized State Agent: James E. Mark Date: 11-15-11  
 Construction Authorization Expiration Date: 11-15-16

HTE# 11-5-27827

Permit # 26548

# Harnett County Department of Public Health Site Sketch

ISSUED TO: Elizabeth Blow / STEVE Mickle PROPERTY LOCATOR: SR1418 BARREDDER REVERED  
SUBDIVISION \_\_\_\_\_ LOT # \_\_\_\_\_

Authorized State Agent: Jens C. Mark Date: 11-15-11

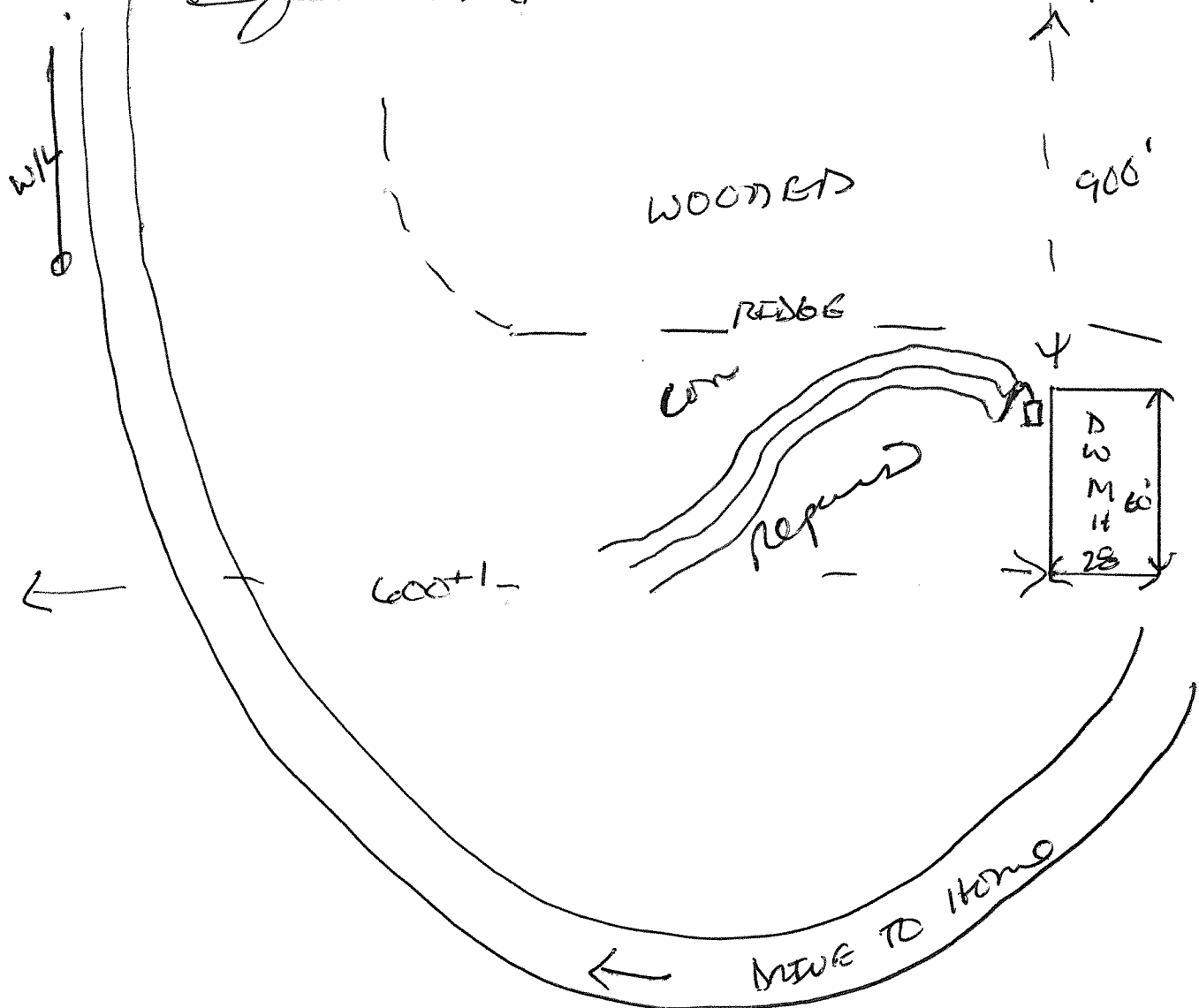

198 ACRES

OUT TO  
SR1418 BARREDDER REVERED

CONTRACTOR TO MEET  
ONSITE PRIOR  
TO INSTALL.

