

Harnett County Department of Public Health

PERMIT # E H 2203-0009

Operation Permit

New Installation Septic Tank Nitrification Line Repair Expansion

PROPERTY LOCATION: 76 RAWLS FARM LN. (CHRISTIAN CT. RD. - SUMM)

Name: (owner) KATIE CAMPBELL / KB HOMES CAROLINAS SUBDIVISION MAISON POINTE PH 2 LOT # 10

System Installer: THORNTONS PLUMBING

Basement with plumbing: Garage Number of Bedrooms 3

BEST PROFESSIONAL JUDGEMENT

Type of Water Supply: Community Public Well Distance from well NA feet

BASED ON EXT SYSTEM

System Type: 25% REDUCTION SYSTEM IIIg Types V and VI Systems expire in 5 years.

PARAMETERS

(In accordance with Table V a)

Owner must contact Health Department 6 months prior to expiration for permit renewal.

This system has been installed in compliance with applicable North Carolina General Statutes, Rules for Sewage Treatment and Disposal, and all conditions of the Improvement Permit and Construction Authorization.

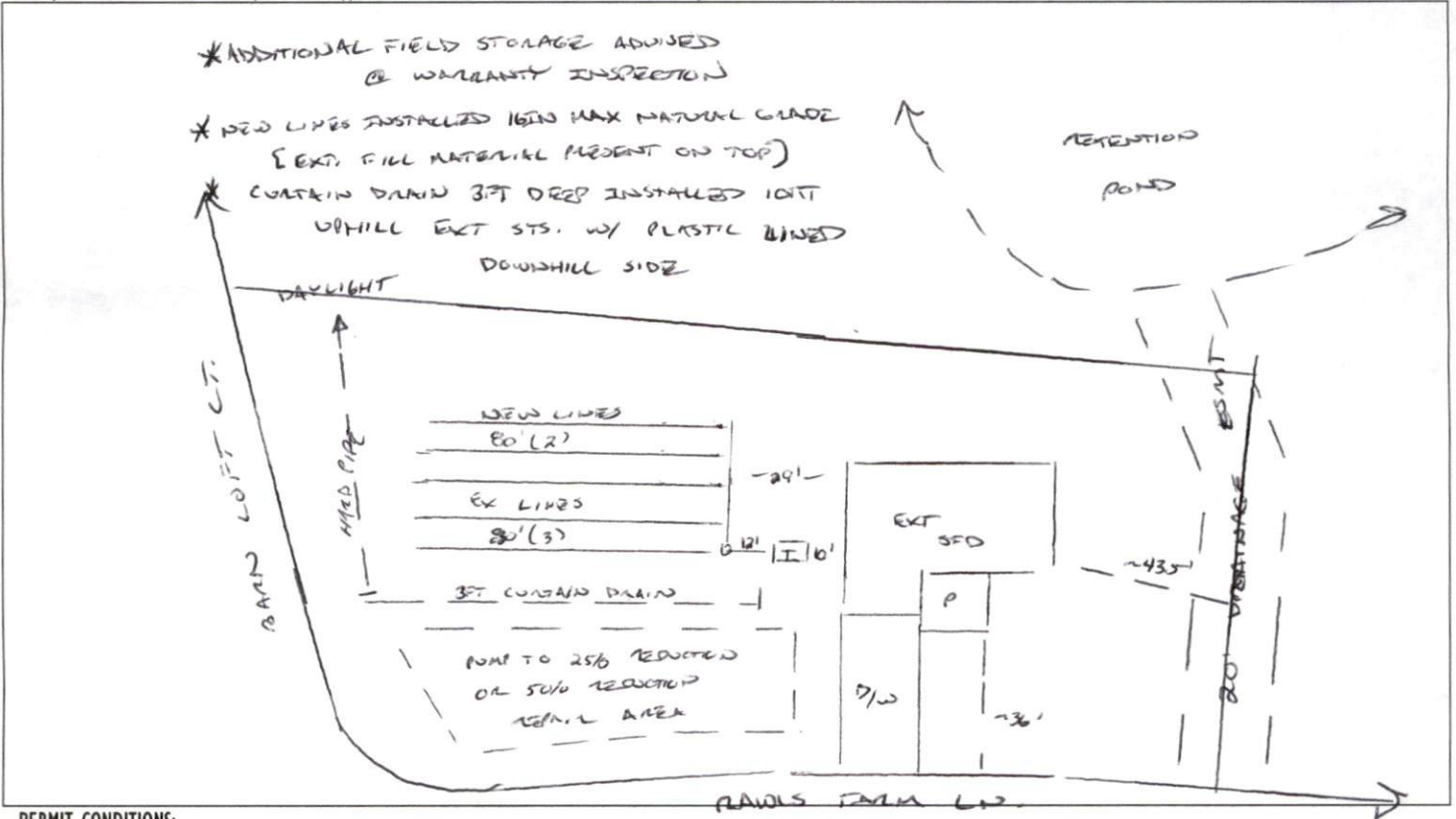

PERMIT CONDITIONS:

- I. Performance: System shall perform in accordance with Rule .1961.
- II. Monitoring: As required by Rule .1961.
- III. Maintenance: As required by Rule .1961. Other: _____
Subsurface system operator required? Yes No
If yes, see attached sheet for additional operation conditions, maintenance and reporting.

IV. Operation: _____
ORIGINAL OPERATION INSTALLED PER PROPOSAL BY CENTRAL

V. Other: _____
CAROLINA SOIL CONSULTING [REQUIRED DUE TO SOFT FIELD]

D-Box Pump Alarm H2O Line PWR Line

Following are the specifications for the sewage disposal system on the above captioned property.

Type of system: Conventional Other EE FLOW IIIg Septic Tank: [1000] EXT gallons Pump Tank: _____ gallons
Subsurface No. of _____ exact length width of _____ depth of _____
Drainage Field ditches 5 (3 EXT), 2 (REG) of each ditch 80 feet ditches 3 feet ditches 16-20 inches
French Drain Required: _____ Linear feet [EXC. FILL MAT.]

Authorized State Agent [Signature] Date 04/12/2022