

Harnett County Department of Public Health

Well Abandonment Permit Application

APPLICANT INFORMATION

Abatemaster LLC
 Applicant/Owner _____ (336-) 731-4396 _____
 Phone Number
 6022 Old US 52 Lexington NC 27107
 Street Address, City, State, Zip Code

PROPERTY INFORMATION

Street Address 389 Turnage Barefoot Ln Subdivision/Lot # _____
 Parcel # 1-5883 227 PIN # _____

Directions to the Site

Head North East to George Perry Lee Rd toward
 Turnage Barefoot Ln. In 269ft the destination is on the
 right. Well house is in the front yard.

Brief description of the well location (ex. front yard, behind out building, front yard, etc.)

***Please include a Site Plan of your property showing the location of the well. If the well is underground, it must be uncovered prior to the department's site visit.**

Please Complete the Following Information:

Date Well Was Constructed _____ Grouted: Yes No
 Above Ground or Below Ground Total Depth of Well _____
 Well Type: Drilled Bored Hand dug Diameter 26 inches

I have thoroughly read and completed this Application and certify that the information provided herein is true, complete and correct to the best of my knowledge and is give in good faith. Representatives of the Harnett County Health Department and State Officials are granted right of entry to conduct necessary inspections to determine compBance with applicable rules.

I understand that I am solely responsible for the proper identification and labeling of all property lines, underground utility lines, and making the site accessible so that a well can be properly constructed according to the permit.

Misty Teague _____ 01/19/2022
 Property Owner's or Owner's Legal Representative Signature Required Date

If you have any questions please contact Environmental Health Division at 910-893-7547

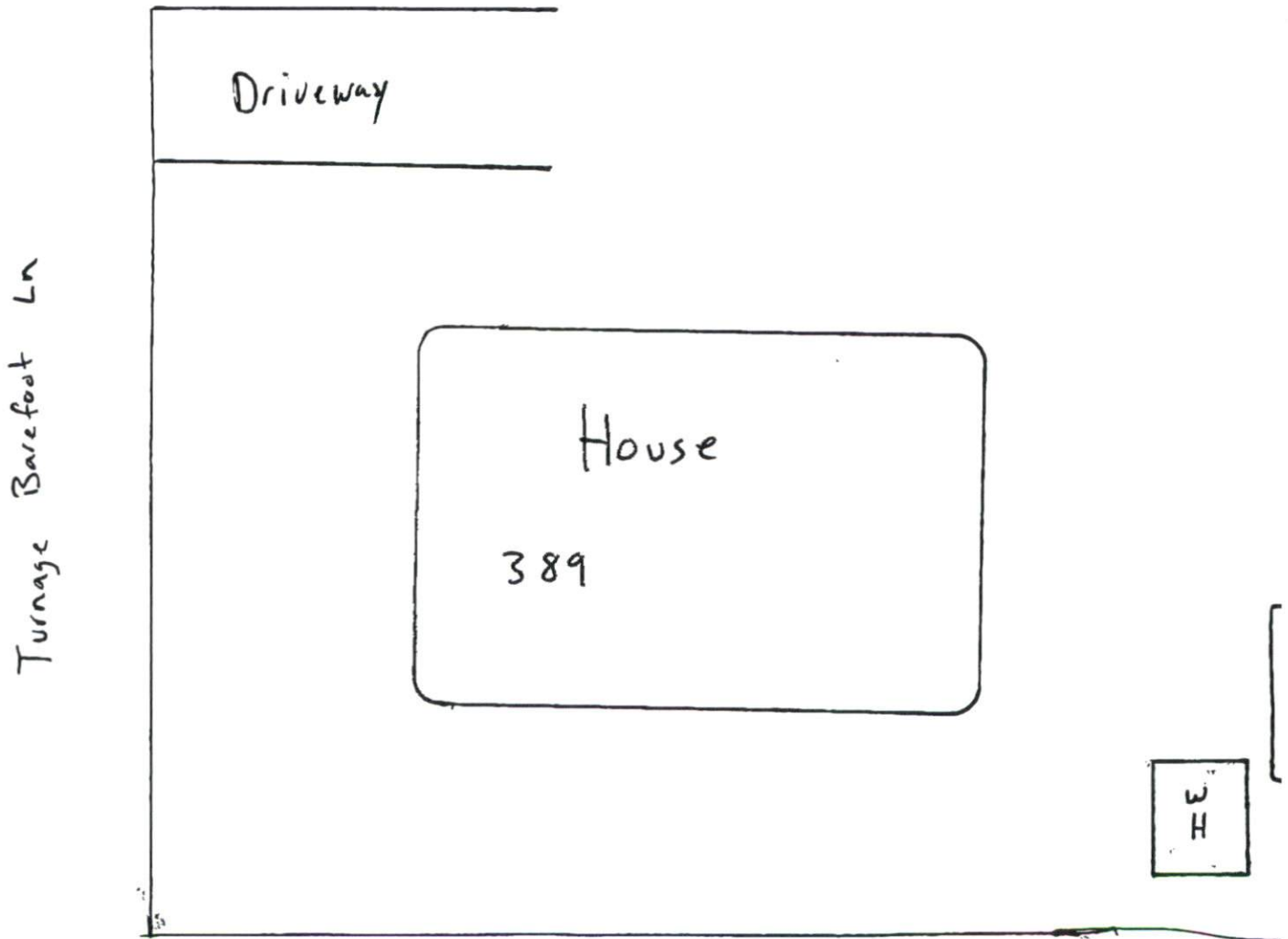

George Perry Lee Rd



