

PLOT PLAN

VICINITY MAP

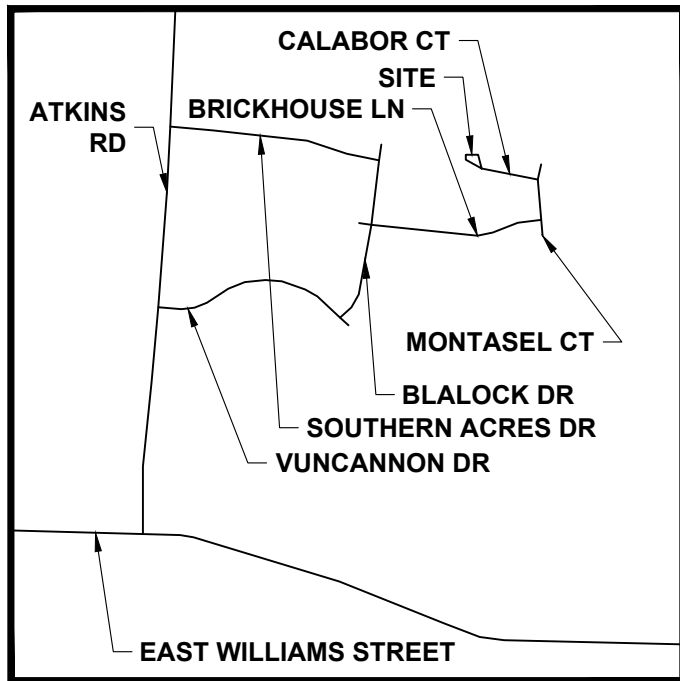

PROPERTY INFORMATION

APN: 0664-94-4917
SUBDIVISION: SOUTHERN ACRES
LOT #: 80
JURISDICTION: FUQUAY VARINA

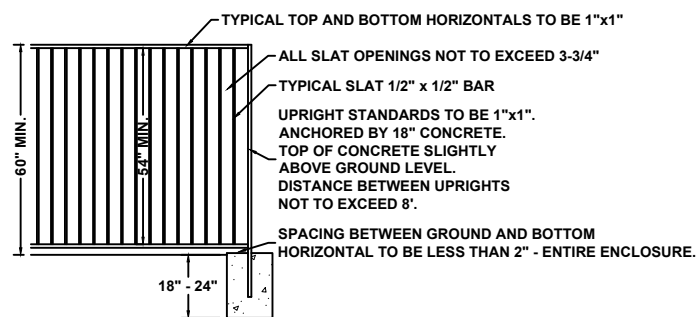

GATE NOTES:
GATES SHALL BE OF SAME CONSTRUCTION GUIDELINES AS ABOVE AND SHALL BE EQUIPPED WITH A SELF CLOSING DEVICE WHICH PERMITS SELF LATCHING OPERATION. WHEN THE LATCHING MECHANISM IS LESS THAN 54" ABOVE THE BOTTOM OF THE GATE, IT MUST BE ON THE POOL SIDE OF THE GATE AND AT LEAST 3" BELOW THE TOP OF THE GATE, WITH NO OPENING LARGER THAN 1/2" WITHIN 18" OF THE LATCHING MECHANISM. THE GROUND CLEARANCE MAY BE INCREASED TO LESS THAN 4" ONLY IF THE GROUND IS CONCRETE OR OTHER HARD SURFACE. ALL GATES SHALL OPEN AWAY FROM THE POOL.

PROPOSED POOL	13'-0" x 30'-6"
PROPOSED POOL IMPERVIOUS	85 SF
PROPOSED NEW PATIO IMPERVIOUS	258 SF
PROPOSED EQUIPMENT PAD IMPERVIOUS	25 SF
TOTAL PROPOSED IMPERVIOUS	368 SF



NOTE: PROPERTY LINE LENGTHS AND DIMENSIONS TO PROPERTY LINES ARE APPROXIMATE.

NOTE: PLANS ARE FOR REFERENCE, POOL TO BE INSTALLED ACCORDING TO MANUFACTURER'S INSTALLATION GUIDE

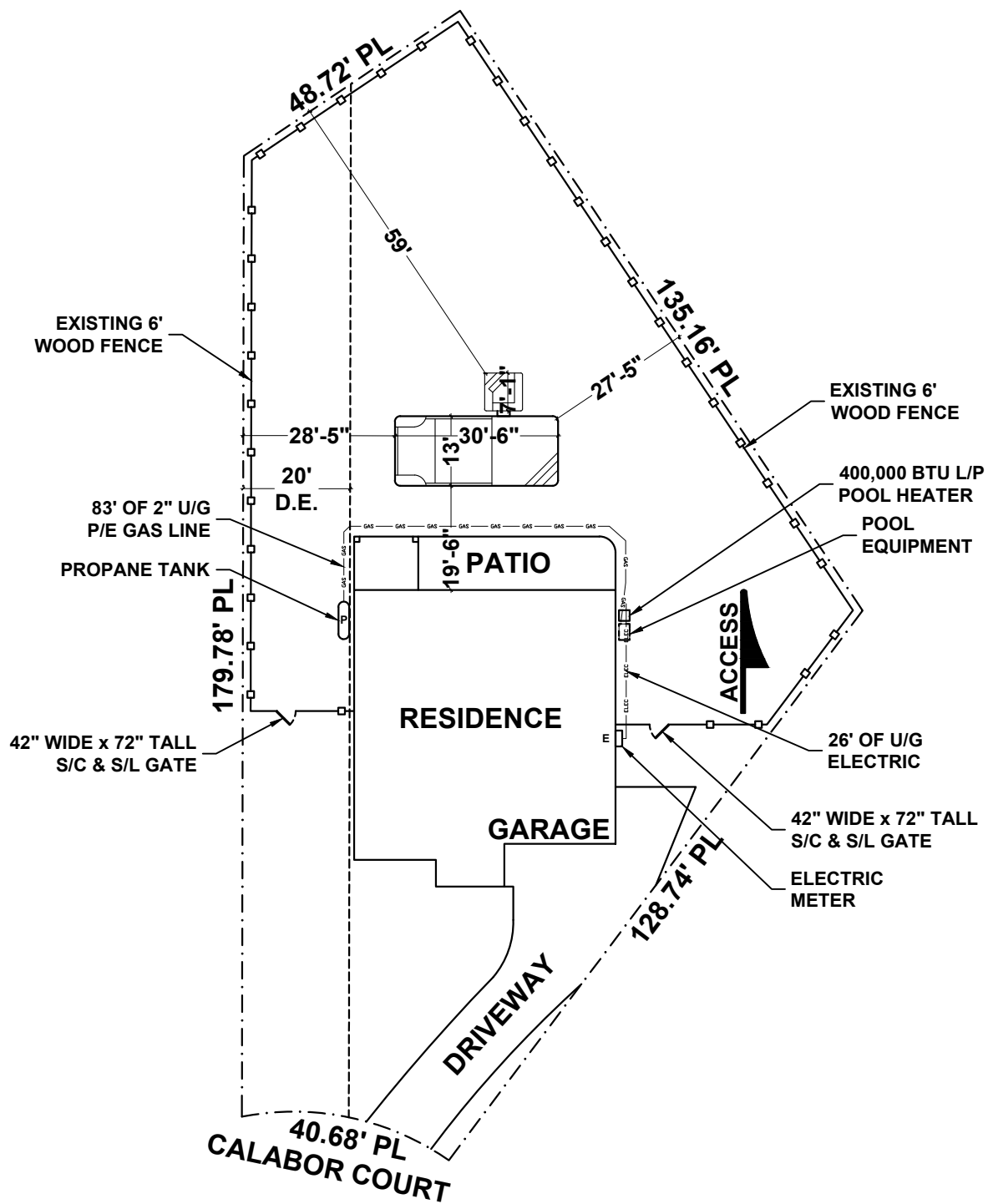

RALEIGH
2140 PAGE ROAD - SUITE 102
DURHAM, NC 27703
PHONE: (888) 400-4101
FAX: 919-594-6000
NC LICENSE # 77473



NAME: SCHROEDER, AMY
ADDRESS: 70 CALABOR COURT
CITY: FUQUAY VARINA, NC 27526
PHONE 1: 919-598-3729
PHONE 2:
CONSULTANT: DUANE HAIGHT
PHONE: 919-579-1095
SUPERVISOR:
PHONE:
DRAFTSMAN: T.B.
CONTRACT DATE: 10-17-21
CUSTOMER SIGNATURE:

ISSUE DATE:
12-9-21

JOB # 1358

SITE PLAN

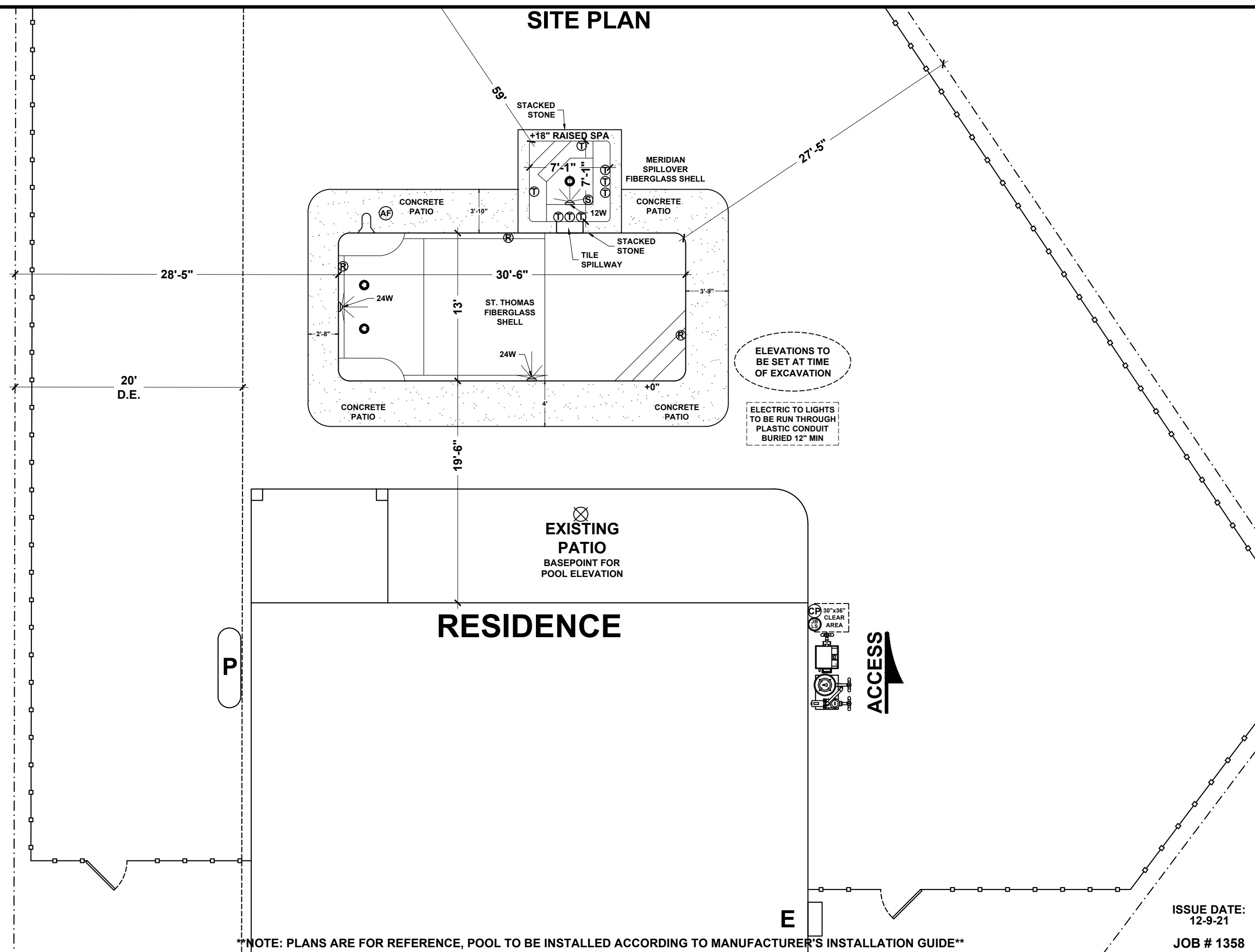

RALEIGH
2140 PAGE ROAD - SUITE 102
DURHAM, NC 27703
PHONE: (888) 400-4101
FAX: 919-594-6000
NC LICENSE # 77473

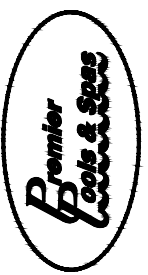

ELEVATIONS TO BE SET AT TIME OF EXCAVATION

ELECTRIC TO LIGHTS TO BE RUN THROUGH PLASTIC CONDUIT BURIED 12" MIN

EXISTING PATIO
BASEPOINT FOR POOL ELEVATION

RESIDENCE

ACCESS

P

E

NOTE: PLANS ARE FOR REFERENCE, POOL TO BE INSTALLED ACCORDING TO MANUFACTURER'S INSTALLATION GUIDE

ISSUE DATE:
12-9-21
JOB # 1358

NAME: SCHROEDER, AMY
ADDRESS: 70 CALABOR COURT
CITY: FUQUAY VARINA, NC 27526
PHONE 1: 919-698-3729
PHONE 2:
CONSULTANT: DUANE HAIGHT
PHONE: 919-579-1095
SUPERVISOR:
PHONE:
DRAFTSMAN: T. B.
CONTRACT DATE: 10-17-21
CUSTOMER SIGNATURE:

PLUMBING & SPECS.

POOL SPECIFICATIONS

SHELL NAME	ST. THOMAS	(2,820 LBS)
POOL DIMENSIONS	30'-6" x 13'-0"	
POOL DEPTHS	3'-7" x 7'-0"	
POOL SURFACE AREA	396 SF	
POOL PERIMETER	85'	
POOL VOLUME	13,700 GALLONS	

SPA SPECIFICATIONS

SHELL NAME	MERIDIAN SPILLOVER	(395 LBS)
SPA DIMENSIONS	7'-1" x 7'-1"	
SPA SURFACE AREA	45 SF	
SPA PERIMETER	24'	
SPA VOLUME	475 GALLONS	

EQUIPMENT

CIRCULATION PUMP	1.65 HP / VARIABLE / ePUMP
AUX. PUMP 1	-
FILTER	340 CARTRIDGE
HEATER	400,000 BTU PROPANE
SANITATION	FUSION SOFT 1400
CONTROLS	iAQUALINK RS-PS4
JVA	(2)
SPA BLOWER	YES
POOL RETURNS	(4)
SPA THERAPIES	(8)

ELECTRIC

POOL LIGHT	(2) 24W COLOR LEDS
SPA LIGHT	(1) 12W COLOR LED

STEEL & GUNITE

BENCHES & STEPS	-
ROCK NOTCHES	-
6" RAISED WALL	-
12" RAISED WALL	-
18" RAISED WALL	-
24" RAISED WALL	-
RAISED SPA	+18" RAISED SPA
SLEEVES	-

WATER FEATURES

SHEER DESCENTS	-
WOK POTS	-
FOUNTAINS	-
WATERFALLS	-

PATIO

PATIO MATERIAL	BROOM FINISH CONCRETE
PATIO COLOR	SEE COLOR SELECTION SHEET
COPING MATERIAL	BROOM FINISH CONCRETE
COPING COLOR	SEE COLOR SELECTION SHEET
NEW PATIO (CONTRACT)	260 SF
NEW PATIO (PLAN)	365 SF
EXISTING PATIO AREA	-
PATIO SLEEVES	-

TILE

RAISED WALL FACING	STACKED STONE - SEE COLORS
SPILLWAY TILE	-
TILE INSERTS	-

INTERIOR

INTERIOR FINISH TYPE	FIBERGLASS SHELL
INTERIOR FINISH COLOR	PER SHELL CONTRACT

MISCELLANEOUS

MISC.	-
MISC.	-
MISC.	-

BARRIERS

BARRIERS	BY OWNERS
CLOSURES	BY OWNERS

START UP

TOTAL VOLUME	14,175 GALLONS
CLEANING SYSTEM	MANUAL
POOL COVER	-
INTERIOR BRUSHING	N/A
POOL SERVICE	30 DAYS

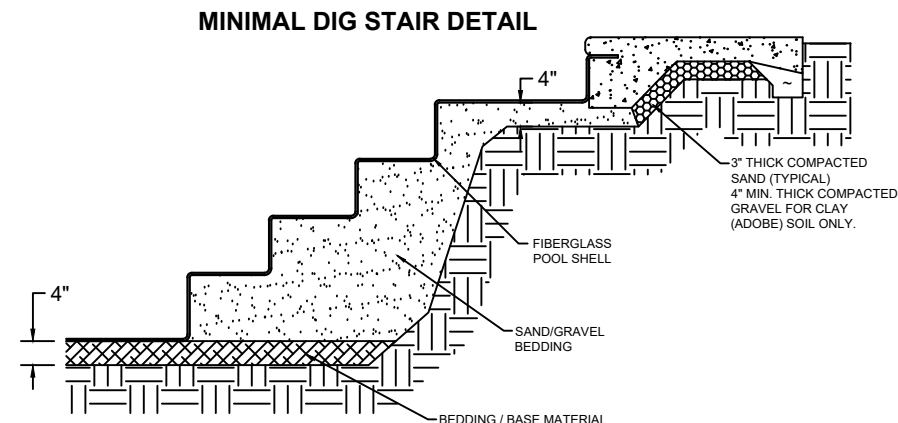
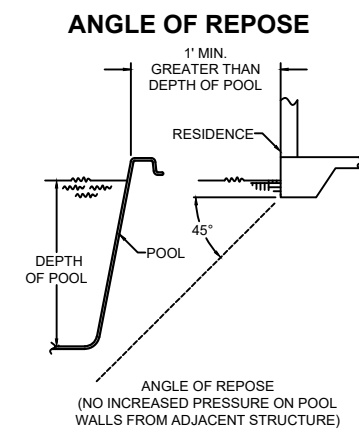
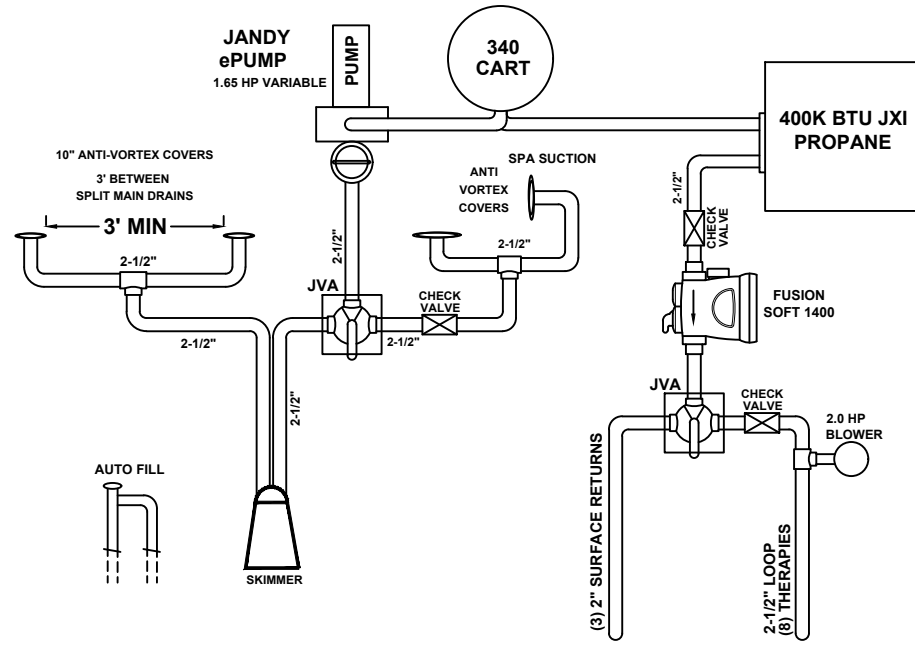

BOND BEAM WITH SPA

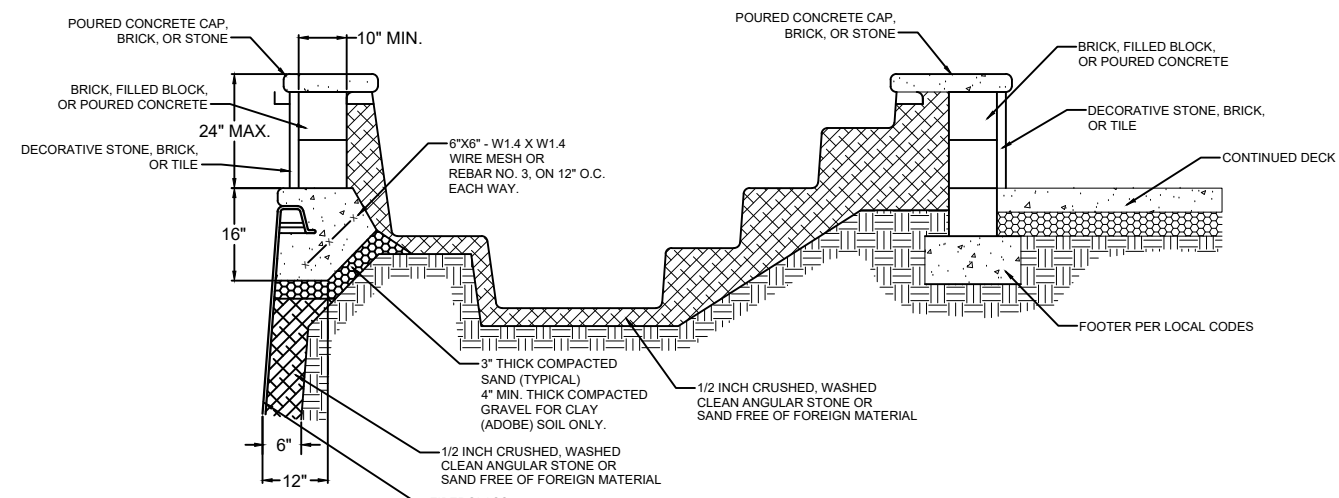

BACKFILL DETAIL

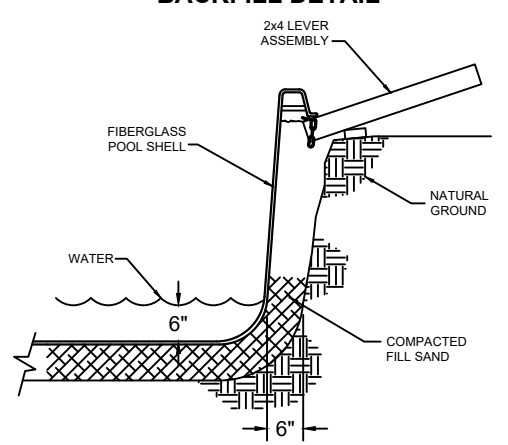

CANTILEVER CONCRETE DECK

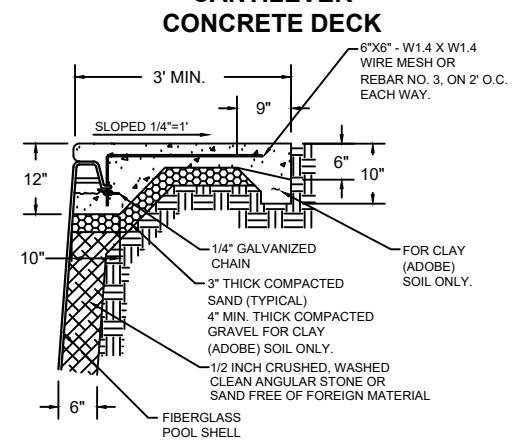

SUMP PIPE INSTALLATION

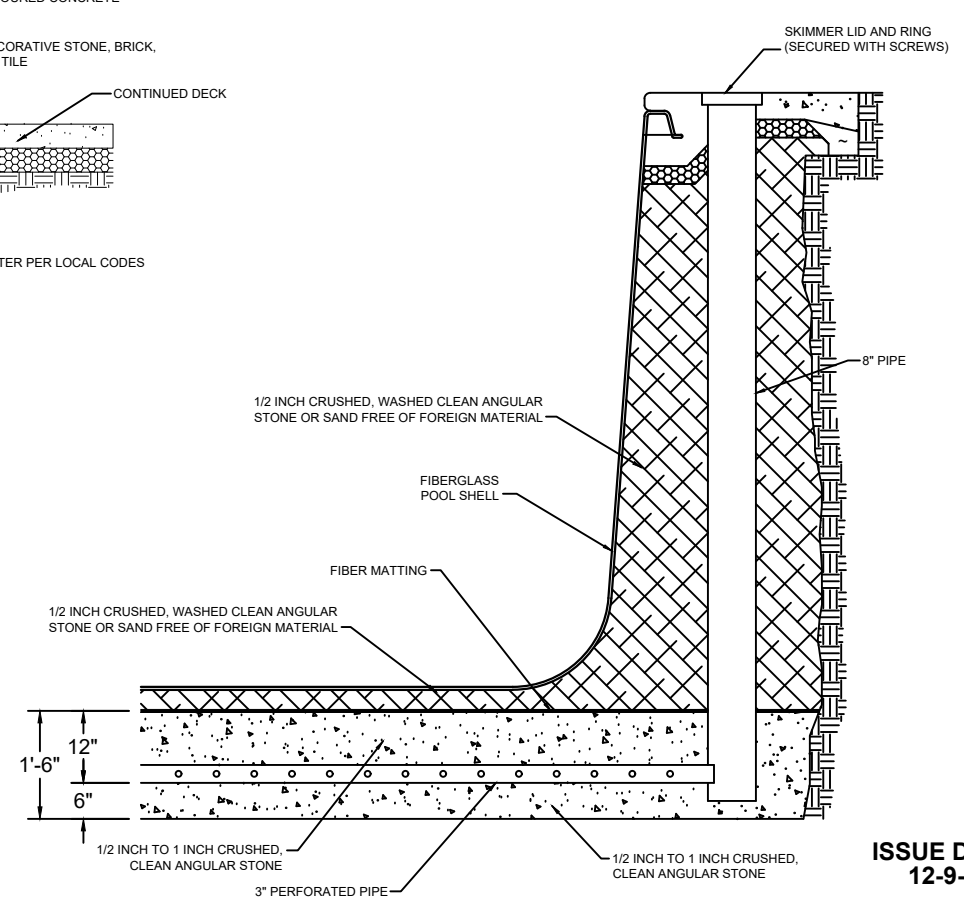

****NOTE: PLANS ARE FOR REFERENCE, POOL TO BE INSTALLED ACCORDING TO MANUFACTURER'S INSTALLATION GUIDE****

ISSUE DATE:
12-9-21

JOB # 1358

RALEIGH 2140 PAGE ROAD - SUITE 102
 DURHAM, NC 27703
 PHONE: (888) 400-4101
 FAX: 919-594-6000
 NC LICENSE # 77473
Premier
Pool & Spa
 NAME: SCHROEDER, AMY
 ADDRESS: 70 CALABOR COURT
 CITY: FUQUAY VARINA, NC 27526
 PHONE 1: 919-598-3729
 CONSULTANT: DUANE HAIGHT
 SUPERVISOR:
 DRAFTSMAN: T.B.
 CONTRACT DATE: 10-17-21
 CUSTOMER SIGNATURE:

LAYOUT PLAN

NOTE: LAYOUT DIMENSIONS
ARE TO WATERLINE

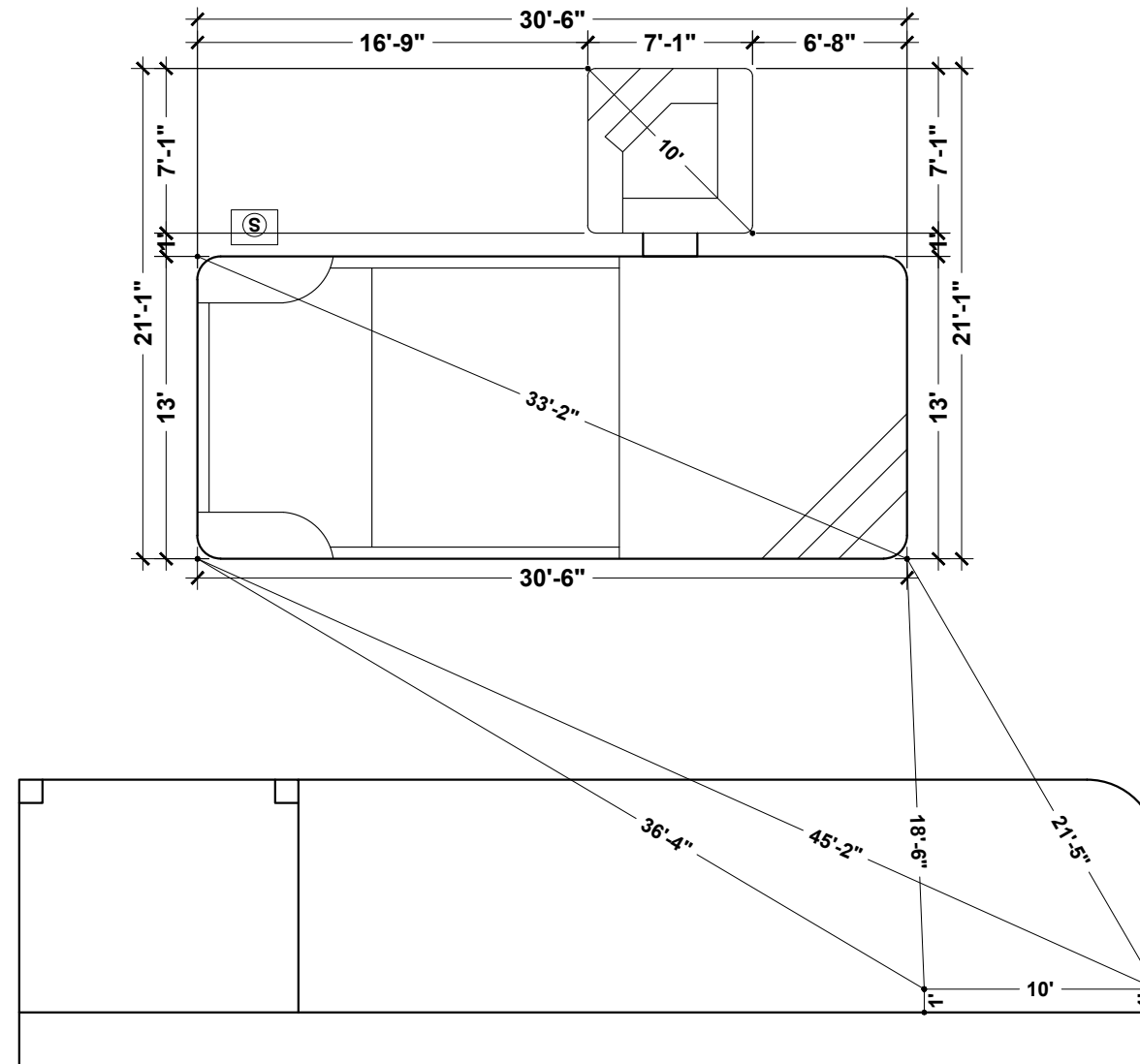

EXCAVATION DIMENSIONS

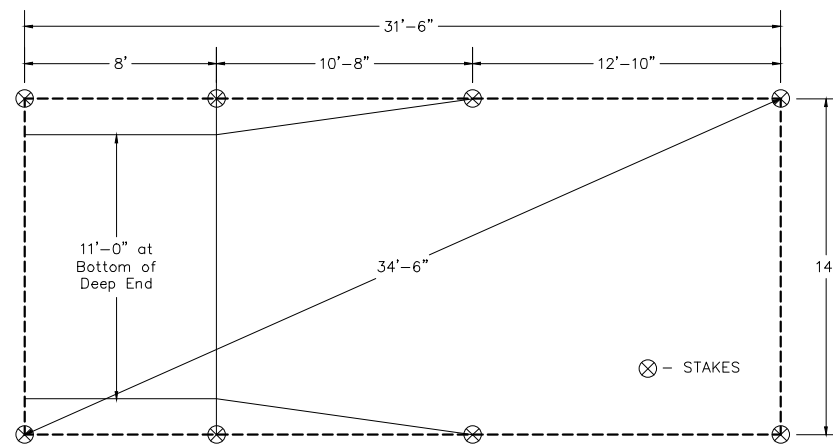

POOL SHELL DEPTH DIMENSIONS

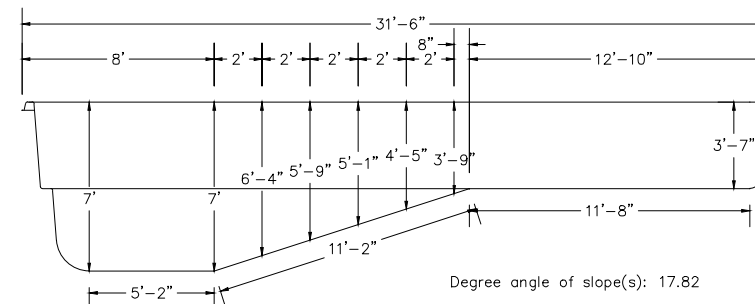

NOTE: PLANS ARE FOR REFERENCE, POOL TO BE INSTALLED ACCORDING TO MANUFACTURER'S INSTALLATION GUIDE

ISSUE DATE:
12-9-21

JOB # 1358

RALEIGH
2140 PAGE ROAD - SUITE 102
DURHAM, NC 27703
PHONE: (888) 400-4101
FAX: 919-594-6000
NC LICENSE # 77473



NAME: SCHROEDER, AMY
ADDRESS: 70 CALABOR COURT
CITY: FUQUAY VARINA, NC 27526
PHONE 1: 919-598-3729
PHONE 2:
CONSULTANT: DUANE HAIGHT
PHONE: 919-579-1095
SUPERVISOR:
DRAFTSMAN: T. B.
CONTRACT DATE: 10-17-21
CUSTOMER SIGNATURE: