

Harnett County Department of Public Health

Improvement Permit

Repair

A building permit cannot be issued with only an Improvement Permit

ISSUED TO: WILLIAM + CHRISTINE ROBERTS PROPERTY LOCATION: 34 DONNIBROOK RUN (US 401 N.)
 SUBDIVISION: DONNIBROOK PINES LOT # 25
 NEW REPAIR EXPANSION
 Type of Structure: EXT 3-GR STD Site Improvements required prior to Construction Authorization Issuance:
 Proposed Wastewater System Type: 25% REDUCTION SYS
 Projected Daily Flow: 360 GPD
 Number of bedrooms: 3 Number of Occupants: 6 max
 Basement Yes No
 Pump Required: Yes No May be required based on final location and elevations of facilities
 Type of Water Supply: Community Public Well Distance from well NA feet Permit valid for: Five years
 No expiration
 Permit conditions: _____

Authorized State Agent: [Signature] Date: 08/17/2021 SEE ATTACHED SITE SKETCH
 The issuance of this permit by the Health Department in no way guarantees the issuance of other permits. The permit holder is responsible for checking with appropriate governing bodies in meeting their requirements. This site is subject to revocation if the site plan, plat, or the intended use changes. The Improvement Permit shall not be affected by a change in ownership of the site. This permit is subject to compliance with the provisions of the Laws and Rules for Sewage Treatment and Disposal and to conditions of this permit.

Construction Authorization

(Required for Building Permit)

The construction and installation requirements of Rules .1950, .1952, .1954, .1955, .1956, .1957, .1958, and .1959 are incorporated by references into this permit and shall be met. Systems shall be installed in accordance with the attached system layout.

ISSUED TO: WILLIAM + CHRISTINE ROBERTS PROPERTY LOCATION: 34 DONNIBROOK RUN (US 401 N.)
 SUBDIVISION: DONNIBROOK PINES LOT # 25
 Facility Type: EXT 3-GR STD New Expansion Repair
 Basement? Yes No Basement Fixtures? Yes No
 Type of Wastewater System** NOT APPLICABLE (Initial) Wastewater Flow: 360 GPD
 (See note below, if applicable
25% REDUCTION SYSTEM (Repair)

Installation Requirements/Conditions

Septic Tank Size <u>EXT</u> gallons	Number of trenches <u>3</u>	Exact length of each trench <u>80</u> feet	Trench Spacing: <u>9</u> Feet on Center
Pump Tank Size _____ gallons	Trenches shall be installed on contour at a _____	Maximum Trench Depth of: <u>20</u> [max] inches	Soil Cover: <u>6</u> inches [min]
	(Trench bottoms shall be level to +/-1/4" in all directions)	(Maximum soil cover shall not exceed 36" above the trench bottom)	
Pump Requirements: _____ ft. TDH vs. _____ GPM		Aggregate Depth: <u>NA</u> inches below pipe	<u>NA</u> inches above pipe
Conditions: <u>GRAVITY TO D-BOX EQUAL DISTRIBUTION REQUIRED</u>		<u>NA</u> inches total	

**WATER LINES (INCLUDING IRRIGATION) MUST BE 10FT. FROM ANY PART OF SEPTIC SYSTEM OR REPAIR AREA.
NO UTILITIES ALLOWED IN INITIAL OR REPAIR DRAIN FIELD AREA.**

**If applicable: I understand the system type specified is different from the type specified on the application. I accept the specifications of this permit.

Owner/Legal Representative Signature: _____ Date: _____

This Construction Authorization is subject to revocation if the site plan, plat, or the intended use changes. The Construction Authorization shall not be transferred when there is a change in ownership of the site. This Construction Authorization is subject to compliance with the provisions of the Laws and Rules for Sewage Treatment and Disposal and to the conditions of this permit. SEE ATTACHED SITE SKETCH

Authorized State Agent: [Signature] Date: 08/17/2021
ANDREW CORNIO Construction Authorization Expiration Date: 08/17/2026

Application # EHA2108-0006

Harnett County Department of Public Health Site Sketch

Property Location: 34 DONNIBROOK RUN (US 401 N.)

Issued To: WILLIAM + CHRISTINE ROBERTS Subdivision DONNIBROOK PINES Lot # 25

Authorized State Agent: [Signature] Date: 08/17/2021
ANDREW CORBIN

MAINTENANCE ADVISED

- * TWO (2) CONTRACTORS REVIEWED SIS, STATING SIS WAS NOT SALVAGEABLE
- * ON-SITE EXCAVATION SHOWS REVIEW DOES NOT APPEAR TO HAVE OCCURRED GREATER THAN 20 FT FROM TANK
- * AUGER BORING IN 2ND TO LAST LINE SHOWS DRY, WHITE, ~~UNUSED~~ EZ FLOW PRODUCT
- * LIKELY CRUSH PRESENT OR BLOCKAGE PRESENT SOMEWHERE IN SYSTEM
- ↳ PERMIT APPEARS TO SHOW STEPDOWN OR STEPDOWNS WERE PRESENT
- ↳ ROOT INTRUSION MAY BE PRESENT

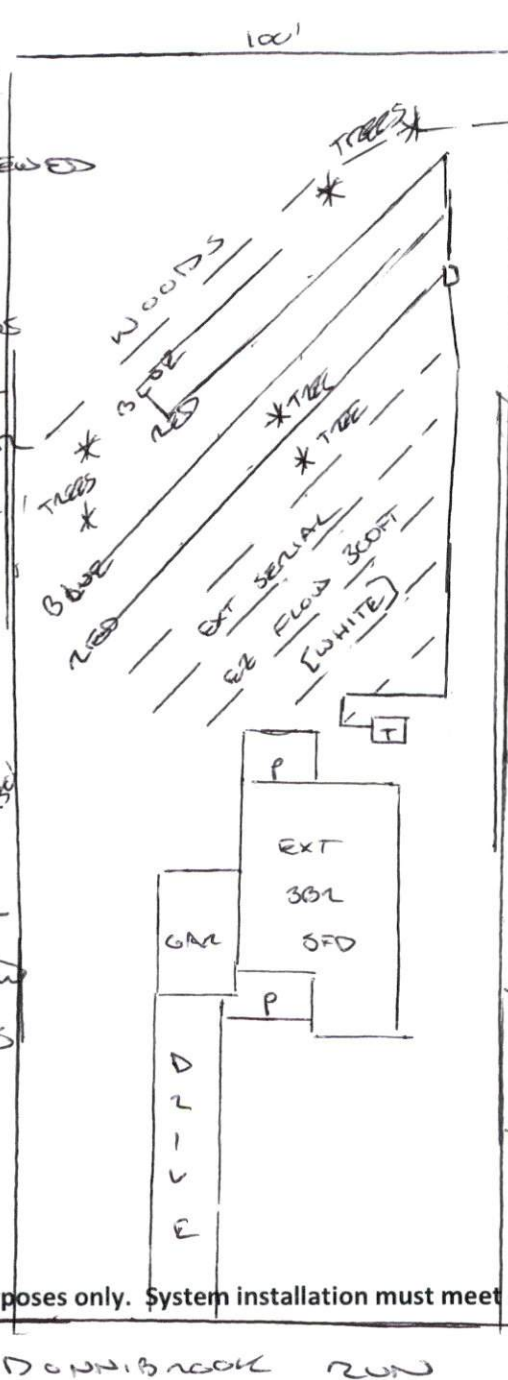

NEW INSTALL

- * GRAVITY TO D-BOX EQUAL DISTRIBUTION REQUIRED
- ↳ NO SERIAL
- ↳ NO HEADER TO HEADER CHAMBER INSTALL
- ↳ D-BOX W/ DIALS REQUIRED
- * LINES 1 + 2 INSTALL @ 20\"/>- VERY END SHOULD SHALLOW OUT AT 1\"/>- * 1/4\" FALL FROM TANK TO D-BOX LOCATION
- * TREES IN MIDDLE ADVISED TO REMOVE BUT NOT REQUIRED REMOVAL
- * SIS, FLAGGED ON-SITE
- * EZ FLOW THREE (3) 8\"/>- * CHAMBER - 8\"/>- LINE { 20 4\"/>- & 1\"/>

This drawing is for illustrative purposes only. System installation must meet all pertinent laws, rules, and regulations.