

155.15'

(or we would hire someone to remove the water if necessary)

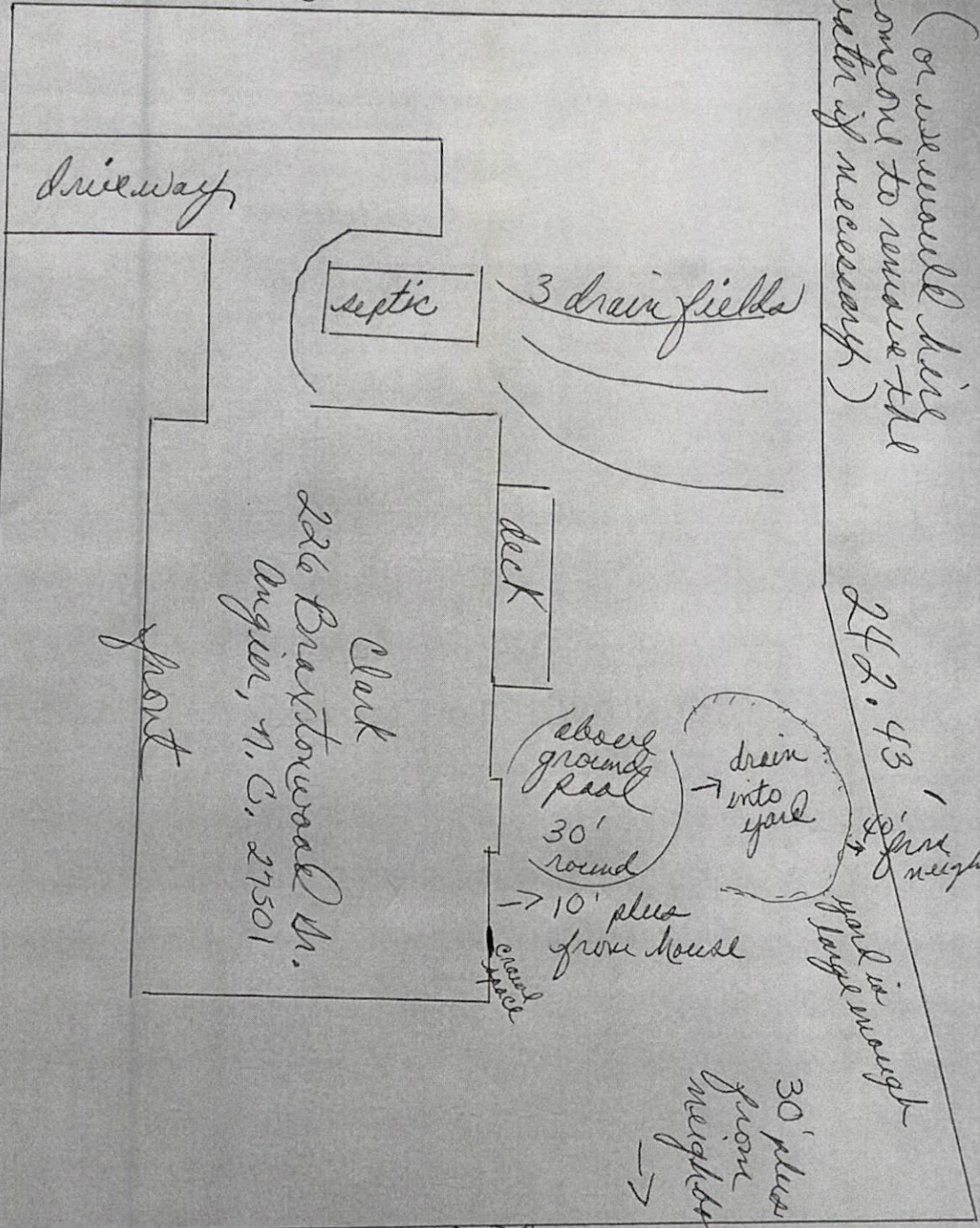

driveway

septic

3 drain fields

deck

Clark
226 Briarstone Road N.
Angier, N.C. 27501

front porch

absorb ground pad
30' round

drain into yard

→ 10' plus from house

242.43'

80' from neighbor

yard is enough

30' plus from neighbor
→

270.13'