

Harnett County Department of Public Health

Improvement Permit

A building permit cannot be issued with only an Improvement Permit

ISSUED TO: KEN DALTON PROPERTY LOCATION: 15 LIVERWOOD DR. (RAWS CH. 1D.) 521415
 SUBDIVISION: LEGACY @ RAWS LOT # 1
 NEW REPAIR EXPANSION Site Improvements required prior to Construction Authorization Issuance: _____
 Type of Structure: EXT 3-BEDROOM SFD
 Proposed Wastewater System Type: 50% REDUCTION PPBPS SIS
 Projected Daily Flow: 366 GPD
 Number of bedrooms: 3 Number of Occupants: 6 max
 Basement Yes No
 Pump Required: Yes No May be required based on final location and elevations of facilities
 Type of Water Supply: Community Public Well Distance from well NA feet Permit valid for: Five years
 Permit conditions: _____ No expiration

Authorized State Agent: [Signature] Date: 04/30/2021 SEE ATTACHED SITE SKETCH
 The issuance of this permit by the Health Department in no way guarantees the issuance of other permits. The permit holder is responsible for checking with appropriate governing bodies in meeting their requirements. This site is subject to revocation if the site plan, plat, or the intended use changes. The Improvement Permit shall not be affected by a change in ownership of the site. This permit is subject to compliance with the provisions of the Laws and Rules for Sewage Treatment and Disposal and to conditions of this permit.

Construction Authorization

(Required for Building Permit)

The construction and installation requirements of Rules .1950, .1952, .1954, .1955, .1956, .1957, .1958, and .1959 are incorporated by references into this permit and shall be met. Systems shall be installed in accordance with the attached system layout.

ISSUED TO: KEN DALTON PROPERTY LOCATION: 15 LIVERWOOD DR. (RAWS CH. 1D.) 521415
 SUBDIVISION: LEGACY @ RAWS LOT # 1
 Facility Type: EXT 3-BL SFD New Expansion Repair
 Basement? Yes No Basement Fixtures? Yes No
 Type of Wastewater System** EXT 25% REDUCTION SIS (Initial) Wastewater Flow: 360 GPD
 (See note below, if applicable)
HORIZONTAL
50% REDUCTION SIS. PPBPS (Repair)
Installation Requirements/Conditions
 Septic Tank Size EXT gallons Number of trenches 2
 Pump Tank Size _____ gallons Exact length of each trench 75 feet (GRABER FEE)
 Trenches shall be installed on contour at a Trench Spacing: 9 Feet on Center
 Maximum Trench Depth of: 16 inches Soil Cover: 6 inches [IMPORT]
 (Trench bottoms shall be level to +/- 1/4" (Maximum soil cover shall not exceed 36" above the trench bottom)
 in all directions)
 Pump Requirements: _____ ft. TDH vs. _____ GPM _____ inches below pipe
 Aggregate Depth: NA inches above pipe
 Conditions: GRAVITY TO 50% REDUCTION T+T PANEL SYSTEM _____ inches total

**WATER LINES (INCLUDING IRRIGATION) MUST BE 10FT. FROM ANY PART OF SEPTIC SYSTEM OR REPAIR AREA.
 NO UTILITIES ALLOWED IN INITIAL OR REPAIR DRAIN FIELD AREA.**

****If applicable: I understand the system type specified is different from the type specified on the application. I accept the specifications of this permit.**

Owner/Legal Representative Signature: _____ Date: _____

This Construction Authorization is subject to revocation if the site plan, plat, or the intended use changes. The Construction Authorization shall not be transferred when there is a change in ownership of the site. This Construction Authorization is subject to compliance with the provisions of the Laws and Rules for Sewage Treatment and Disposal and to the conditions of this permit. SEE ATTACHED SITE SKETCH

Authorized State Agent: [Signature] Date: 04/30/2021
ANDREW CURIN Construction Authorization Expiration Date: 04/30/2021

Application # EH 2103-0003

Harnett County Department of Public Health Site Sketch

Property Location: 15 RIVERWOOD DR. (RAWLS CH. RD. - S21415)

Issued To: VEN DALTON Subdivision LEGACY @ RAWLS Lot # 1

Authorized State Agent: [Signature] Date: 04/30/2021
ANDREW WALKIN

PER OWNER REQUEST; THE HARNETT COUNTY HEALTH DEPT. ADVISED THE CONTRACTOR HAS AUTHORITY TO CONDUCT ROUTINE SIS. MAINTENANCE (REPLACEMENT OF BROKEN PIPES, CLEANING, OR ADJUSTING TO AN EXT WASTEWATER SIS. (GS 130A-B36)). SHOULD MAINTENANCE NOT CORRECT ISSUE UTILIZE PERMITTED PPBPS SYSTEM.

HORIZONTAL 50% RED.

PPBPS SYSTEM

CONSULT W/
T+S PROVIDER

* SHOULD REQ BTW
34-35 PANELS

* DEPENDS ON
FINAL LAYOUT

* DUCTILE IRON
OR DOT EQUIVANT
REQUIRED UNDER
THE DRIVEWAY

RAWLS CHURCH RD. (S21415)

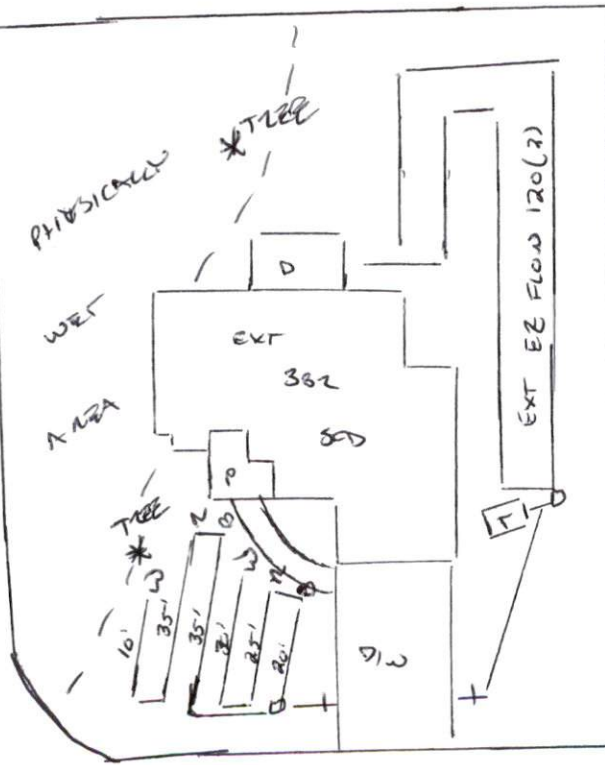

- * 16" TRENCH MAX [IMPORT SOIL REQUIRED]
- * REVIEW ON-SITE PRE-INSTALL
- * RECOMMENDED TO CENTER FEED DRAINLINE TO NOT ALLOW GRAVITY LINE TO EXCEED 6 FT [CONSULT PRE-INSTALL]
- * CONNECT LINES TO MAKE TWO (75 FT) OR THREE (50 FT) LINES
- * SIS. FLAGGED ON-SITE

This drawing is for illustrative purposes only. System installation must meet all pertinent laws, rules, and regulations.