

# Harnett County Department of Public Health Improvement Permit

A building permit cannot be issued with only an Improvement Permit

ISSUED TO: ROBERT F. NAYLON PROPERTY LOCATION: 6116 US 401 N. SUBDIVISION \_\_\_\_\_ LOT # \_\_\_\_\_

NEW  REPAIR  EXPANSION  Site Improvements required prior to Construction Authorization Issuance: \_\_\_\_\_

Type of Structure: EXT PRODUCE STAND

Proposed Wastewater System Type: CONV. OR 25% RED.

Projected Daily Flow: 100 GPD [STATE MIN]

Number of bedrooms: NA Number of Occupants: NA max

Basement  Yes  No

Pump Required:  Yes  No  May be required based on final location and elevations of facilities

Type of Water Supply:  Community  Public  Well Distance from well NA feet

Permit valid for:  Five years  No expiration

Permit conditions: \_\_\_\_\_

Authorized State Agent: [Signature] Date: 01/22/2021 SEE ATTACHED SITE SKETCH

The issuance of this permit by the Health Department in no way guarantees the issuance of other permits. The permit holder is responsible for checking with appropriate governing bodies in meeting their requirements. This site is subject to revocation if the site plan, plat, or the intended use changes. The Improvement Permit shall not be affected by a change in ownership of the site. This permit is subject to compliance with the provisions of the Laws and Rules for Sewage Treatment and Disposal and to conditions of this permit.

## Construction Authorization

(Required for Building Permit)

The construction and installation requirements of Rules .1950, .1952, .1954, .1955, .1956, .1957, .1958, and .1959 are incorporated by references into this permit and shall be met. Systems shall be installed in accordance with the attached system layout.

ISSUED TO: ROBERT F. NAYLON PROPERTY LOCATION: 6116 US 401 N. SUBDIVISION \_\_\_\_\_ LOT # \_\_\_\_\_

Facility Type: EXT PRODUCE STAND  New  Expansion  Repair

Basement?  Yes  No Basement Fixtures?  Yes  No

Type of Wastewater System\*\* CONVENTIONAL / 25% REDUCTION (Initial) Wastewater Flow: 100 GPD [STATE MIN]

(See note below, if applicable ) PUMP TO CONVENTIONAL (Repair)

<b>Installation Requirements/Conditions</b>	Number of trenches <u>2</u>	Trench Spacing: <u>9</u> Feet on Center
Septic Tank Size <u>1000</u> gallons	Exact length of each trench <u>60</u> feet	Soil Cover: <u>12</u> inches
Pump Tank Size _____ gallons	Trenches shall be installed on contour at a	(Maximum soil cover shall not exceed
	Maximum Trench Depth of: <u>24</u> inches	36" above the trench bottom)
	(Trench bottoms shall be level to +/- 1/4" in all directions)	
Pump Requirements: _____ ft. TDH vs. _____ GPM		Aggregate Depth: <u>NA</u> inches below pipe
		<u>NA</u> inches above pipe
		<u>NA</u> inches total

Conditions: REVIEWED SITE PLAN NOTES

**WATER LINES (INCLUDING IRRIGATION) MUST BE 10FT. FROM ANY PART OF SEPTIC SYSTEM OR REPAIR AREA.  
NO UTILITIES ALLOWED IN INITIAL OR REPAIR DRAIN FIELD AREA.**

\*\*If applicable: I understand the system type specified is different from the type specified on the application. I accept the specifications of this permit.

Owner/Legal Representative Signature: \_\_\_\_\_ Date: \_\_\_\_\_

This Construction Authorization is subject to revocation if the site plan, plat, or the intended use changes. The Construction Authorization shall not be transferred when there is a change in ownership of the site. This Construction Authorization is subject to compliance with the provisions of the Laws and Rules for Sewage Treatment and Disposal and to the conditions of this permit. SEE ATTACHED SITE SKETCH

Authorized State Agent: [Signature] Date: 01/22/2021

ANDREW COMIN Construction Authorization Expiration Date: 01/22/2026

Application # FH2101-0010

# Harnett County Department of Public Health Site Sketch

Property Location: 6116 US 401 N.

Issued To: ROBERT F. NAYLOR Subdivision \_\_\_\_\_ Lot # \_\_\_\_\_

Authorized State Agent: *[Signature]* Date: 01/22/2021  
ANDREW COVINO

TRAFFIC % DO NOT DRIVE ON SEPTIC AREA  
OR SEPTIC TANK. TANK WILL NEED TO  
BE TRAFFIC RATED IF SUBJECT TO  
TRAFFIC. USER ACCESS REQUIRED  
IF GREATER THAN 6IN DEPTH.

\* CONVENTIONAL GRAVEL  
OR  
25% REDUCTION

- \* PLUMBING SHALL BE INSTALLED  
SHOULD ALLOW ADEQUATE  
TRENCH DEPTH [ON PUMP]
- \* STS. FLAGGED ONSITE  
[MAINTAIN POWER SETBACK]
- \* RAKE SURFACE OF ALL SURFACE  
ROCK/GRAVEL PRE-INSTALL
- \* DITCHES SHALL BE THOROUGHLY RAKED
- \* DO NOT BACKFILL W/ LARGE ROCKS

PUMP TO 25%  
REDUCTION REPAIR  
AREA

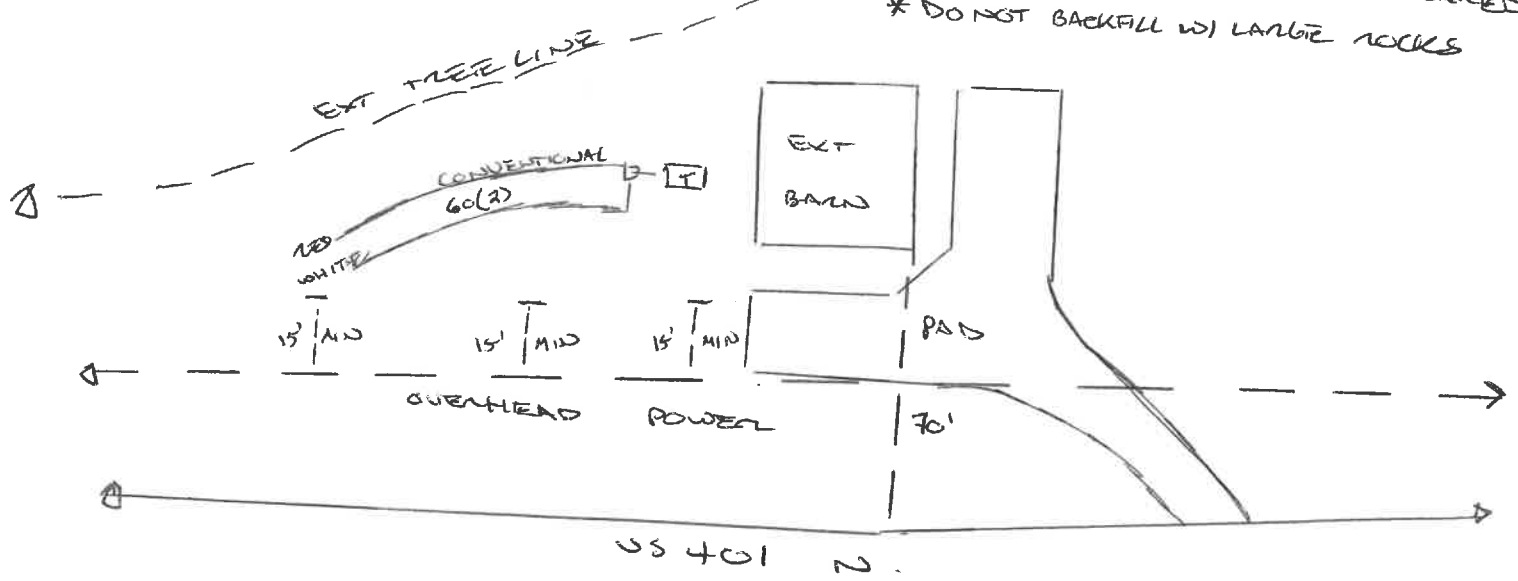

This drawing is for illustrative purposes only. System installation must meet all pertinent laws, rules, and regulations.