

Harnett County Department of Public Health Improvement Permit

A building permit cannot be issued with only an Improvement Permit

ISSUED TO: JENNIFER L SMITH MC DOUGAN PROPERTY LOCATION: 181 NEVELS ROAD (S/L H27)
 SUBDIVISION _____ LOT # _____
 NEW REPAIR EXPANSION Site Improvements required prior to Construction Authorization Issuance: _____
 Type of Structure: EXT 3-IN S/D
 Proposed Wastewater System Type: 25% REDUCTION SYS.
 Projected Daily Flow: 360 GPD
 Number of bedrooms: 3 Number of Occupants: 6 max
 Basement Yes No
 Pump Required: Yes No May be required based on final location and elevations of facilities
 Type of Water Supply: Community Public Well Distance from well 50+ feet Permit valid for: Five years
 Permit conditions: _____ No expiration

Authorized State Agent: [Signature] Date: 01/22/2021 SEE ATTACHED SITE SKETCH
 The issuance of this permit by the Health Department in no way guarantees the issuance of other permits. The permit holder is responsible for checking with appropriate governing bodies in meeting their requirements. This site is subject to revocation if the site plan, plat, or the intended use changes. The Improvement Permit shall not be affected by a change in ownership of the site. This permit is subject to compliance with the provisions of the Laws and Rules for Sewage Treatment and Disposal and to conditions of this permit.

Construction Authorization (Required for Building Permit)

The construction and installation requirements of Rules .1950, .1952, .1954, .1955, .1956, .1957, .1958, and .1959 are incorporated by references into this permit and shall be met. Systems shall be installed in accordance with the attached system layout.

ISSUED TO: JENNIFER L SMITH MC DOUGAN PROPERTY LOCATION: 181 NEVELS ROAD (S/L 1427)
 SUBDIVISION _____ LOT # _____
 Facility Type: EXT 3-IN S/D New Expansion Repair
 Basement? Yes No Basement Fixtures? Yes No
 Type of Wastewater System** NOT APPLICABLE (Initial) Wastewater Flow: 360 GPD
 (See note below, if applicable)
PUMP TO 25% REDUCTION (Repair)
 Installation Requirements/Conditions
 Septic Tank Size EXT gallons Number of trenches 4 2 [NEW]
 Pump Tank Size EXT gallons Exact length of each trench 90 feet
 Trenches shall be installed on contour at a Trench Spacing: 9 Feet on Center
 Maximum Trench Depth of: 20 inches Soil Cover: 8 inches
 (Trench bottoms shall be level to +/- 1/4" (Maximum soil cover shall not exceed 36" above the trench bottom)
 in all directions)
 Pump Requirements: _____ ft. TDH vs. _____ GPM Aggregate Depth: NA inches below pipe
 _____ inches above pipe
 _____ inches total
 Conditions: PUMP TO D-BOX EQUAL DISTRIBUTION

**WATER LINES (INCLUDING IRRIGATION) MUST BE 10FT. FROM ANY PART OF SEPTIC SYSTEM OR REPAIR AREA.
 NO UTILITIES ALLOWED IN INITIAL OR REPAIR DRAIN FIELD AREA.**

****If applicable: I understand the system type specified is different from the type specified on the application. I accept the specifications of this permit.**

Owner/Legal Representative Signature: _____ Date: _____

This Construction Authorization is subject to revocation if the site plan, plat, or the intended use changes. The Construction Authorization shall not be transferred when there is a change in ownership of the site. This Construction Authorization is subject to compliance with the provisions of the Laws and Rules for Sewage Treatment and Disposal and to the conditions of this permit. SEE ATTACHED SITE SKETCH

Authorized State Agent: [Signature] Date: 01/22/2021
ANDREW COLLIN Construction Authorization Expiration Date: 01/22/2024

Application # EH 2005-0020

Harnett County Department of Public Health Site Sketch

Property Location: 181 REVELS ROAD (521427)

Issued To: TOM MORGAN + SARAH MCDONALD Subdivision _____ Lot # _____

Authorized State Agent: *Andrew Cowan* Date: 5/28/2021
ANDREW COWAN

- * CUSTOM LINE SOLUTIONS @ PUMPING, ADDED LINES AND CAP SYSTEM FOR FUTURE USE
- * HOME SHALL BE CHECKED FOR ANY PLUMBING LEAKS [REQUIRED]
- * SHELTER GUTTERS SHALL BE ROUTED AWAY FROM SEPTIC AREA
- * REVIEW OLD WELL PLUMBING AND VERIFY IS NOT CONTRIBUTING TO WATER USAGE

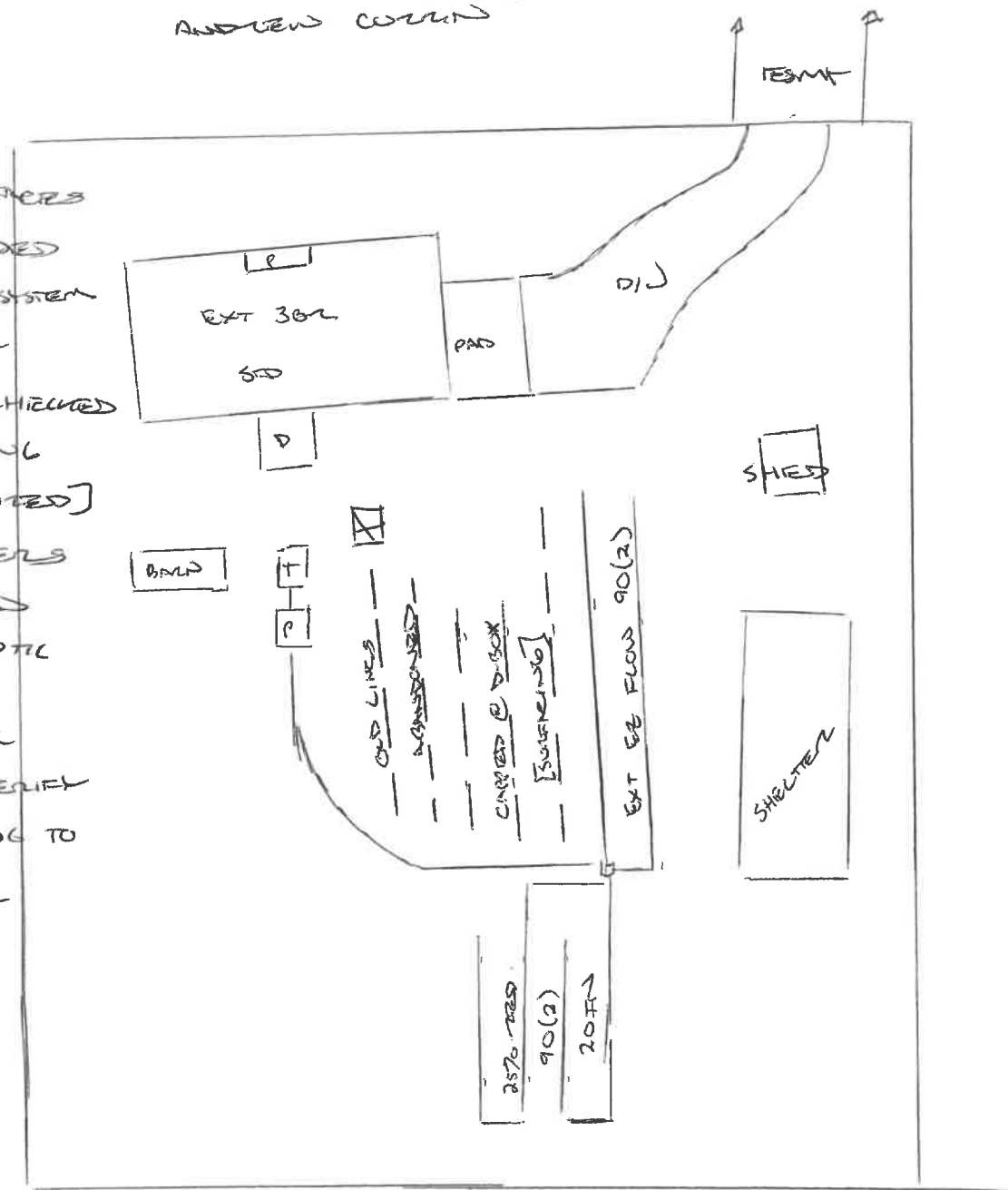

This drawing is for illustrative purposes only. System installation must meet all pertinent laws, rules, and regulations.