



LANDSCAPE POSITIONS	GROUP	TEXTURES	.1955 LTAR	CONSISTENCE MOIST	WET
R-RIDGE	I	S-SAND	1.2 - 0.8	VFR-VERY FRIABLE	NS-NON-STICKY
S-SHOULDER SLOPE		LS-LOAMY SAND		FR-FRIABLE	
L-LINEAR SLOPE	II	SL-SANDY LOAM	0.8 - 0.6	FI-FIRM	SS-SLIGHTLY STICKY
FS-FOOT SLOPE		L-LOAM		VFI-VERY FIRM	
N-NOSE SLOPE		SI-SILT		EFI-EXTREMELY FIRM	
H-HEAD SLOPE	III	SIL-SILT LOAM	0.6 - 0.3		VS-VERY STICKY
CC-CONCLAVE SLOPE		CL-CLAY LOAM			
CV-CONVEX SLOPE		SCL-SANDY CLAY LOAM			
T-TERRACE					
FP-FLOOD PLAN	IV	SIC-SILTY CLAY	0.4 - 0.1		NP-NON-PLASTIC
		C-CLAY			SP-SLIGHTLY STICKY
		SC-SANDY CLAY			P-PLASTIC
					VP-VERY PLASTIC

**STRUCTURE**  
SG-SINGLE GRAIN  
M- MASSIVE  
CR-CRUMB  
GR-GRANULAR  
SBK-SUBANGULAR BLOCKY  
ABK-ANGULAR BLOCKY  
PL-PLATY  
PR-PRISMATIC

**MINERALOGY**  
SLIGHTLY EXPANSIVE  
EXPANSIVE

Show profile locations and other site features (dimensions, references or benchmark, and North)

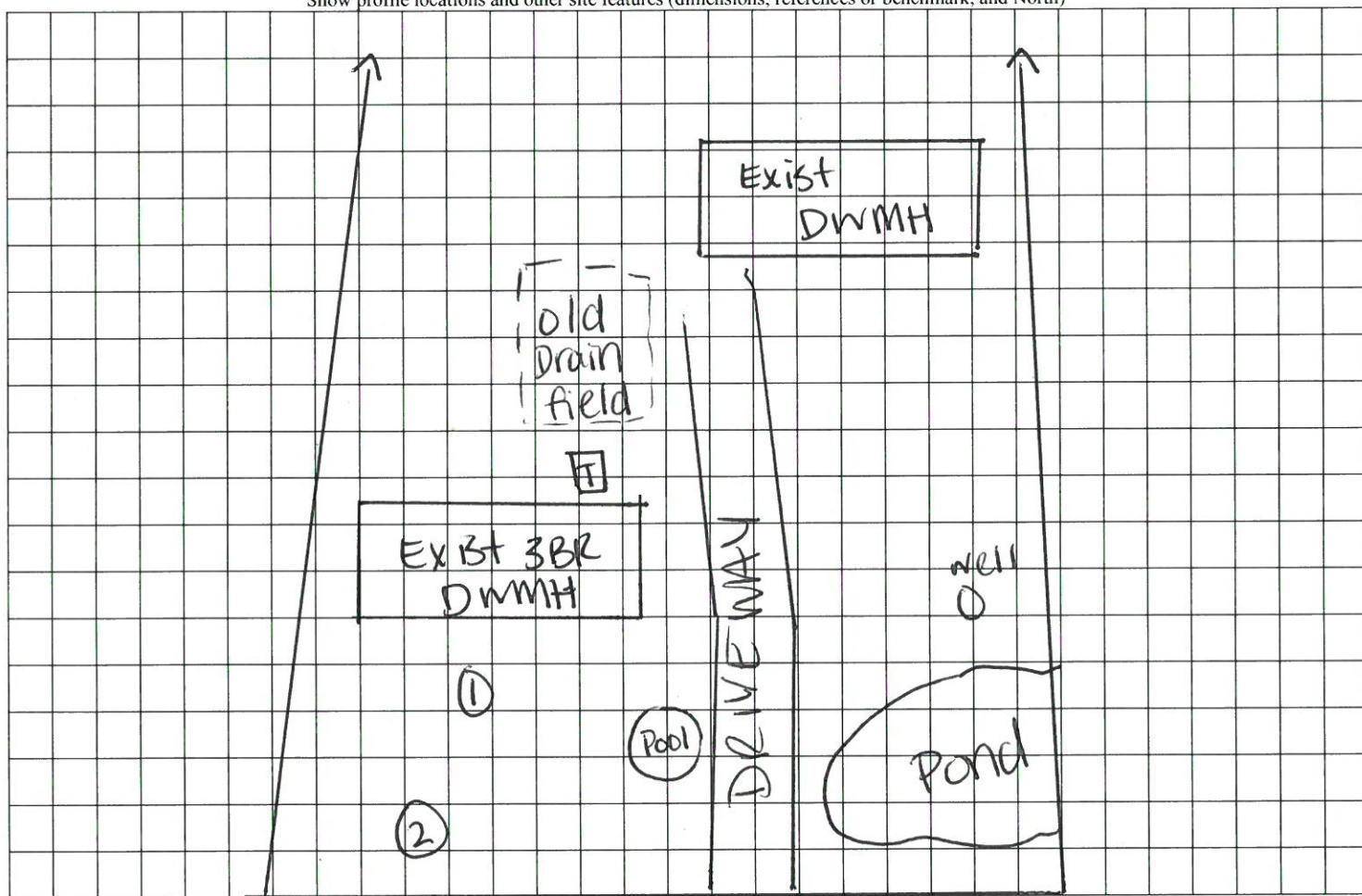

Valley Rd