

## Harnett County Department of Public Health Improvement Permit

A building permit cannot be issued with only an Improvement Permit

ISSUED TO: Millard Roberts Curran Jr. PROPERTY LOCATION: 229 Ashton Lane (NC 210 N.)  
 SUBDIVISION: Pinecroft LOT # 4  
 NEW  REPAIR  EXPANSION   
 Site Improvements required prior to Construction Authorization Issuance: \_\_\_\_\_  
 Type of Structure: Ext. 3-Bedroom SFD  
 Proposed Wastewater System Type: Ext. Conventional  
 Projected Daily Flow: 366 GPD  
 Number of bedrooms: 3 Number of Occupants: 6 max  
 Basement  Yes  No  
 Pump Required:  Yes  No  May be required based on final location and elevations of facilities  
 Type of Water Supply:  Community  Public  Well Distance from well NA feet  
 Permit valid for:  Five years  No expiration  
 Permit conditions: \_\_\_\_\_

Authorized State Agent: [Signature] Date: 12/20/2019 SEE ATTACHED SITE SKETCH  
 The issuance of this permit by the Health Department in no way guarantees the issuance of other permits. The permit holder is responsible for checking with appropriate governing bodies in meeting their requirements. This site is subject to revocation if the site plan, plat, or the intended use changes. The Improvement Permit shall not be affected by a change in ownership of the site. This permit is subject to compliance with the provisions of the Laws and Rules for Sewage Treatment and Disposal and to conditions of this permit.

## Construction Authorization (Required for Building Permit)

The construction and installation requirements of Rules .1950, .1952, .1954, .1955, .1956, .1957, .1958, and .1959 are incorporated by references into this permit and shall be met. Systems shall be installed in accordance with the attached system layout.

ISSUED TO: Millard Roberts Curran Jr. PROPERTY LOCATION: 229 Ashton Lane (NC 210 N.)  
 SUBDIVISION: Pinecroft LOT # 4  
 Facility Type: Ext. 3 BR SFD  New  Expansion  Repair  
 Basement?  Yes  No Basement Fixtures?  Yes  No  
 Type of Wastewater System\*\* Existing Conventional S/S (Initial) Wastewater Flow: 360 GPD  
 (See note below, if applicable )  
Ext. Conv. Repair (Repair)  
 Installation Requirements/Conditions  
 Number of trenches Ext  
 Septic Tank Size 1000 gallons (NEW) Exact length of each trench Ext feet Trench Spacing: Ext Feet on Center  
 Pump Tank Size \_\_\_\_\_ gallons Trenches shall be installed on contour at a Soil Cover: Ext inches  
 Maximum Trench Depth of: Ext inches (Maximum soil cover shall not exceed 36" above the trench bottom)  
 (Trench bottoms shall be level to +/- 1/4" in all directions)  
 Pump Requirements: \_\_\_\_\_ ft. TDH vs. \_\_\_\_\_ GPM Ext inches below pipe  
 Aggregate Depth: Ext inches above pipe  
 Conditions: \_\_\_\_\_ Ext inches total

**WATER LINES (INCLUDING IRRIGATION) MUST BE 10FT. FROM ANY PART OF SEPTIC SYSTEM OR REPAIR AREA.  
 NO UTILITIES ALLOWED IN INITIAL OR REPAIR DRAIN FIELD AREA.**

\*\*If applicable: I understand the system type specified is different from the type specified on the application. I accept the specifications of this permit.

Owner/Legal Representative Signature: \_\_\_\_\_ Date: \_\_\_\_\_

This Construction Authorization is subject to revocation if the site plan, plat, or the intended use changes. The Construction Authorization shall not be transferred when there is a change in ownership of the site. This Construction Authorization is subject to compliance with the provisions of the Laws and Rules for Sewage Treatment and Disposal and to the conditions of this permit. SEE ATTACHED SITE SKETCH

Authorized State Agent: [Signature] Date: 12/20/2019  
ANDREW CURRAN Construction Authorization Expiration Date: 12/20/2024

Application # EH1912-0018

## Harnett County Department of Public Health Site Sketch

Property Location: 229 Ashton Lane (NC 210 N.)

Issued To: Milford Corrin Jr. Subdivision Pinecroft Lot # 4

Authorized State Agent: *Andrew Corrin* Date: 12/20/2019  
ANDREW CORRIN

- \* EXISTING TANK SHALL BE PUMPED, CRUSHED, AND BACKFILLED ONSITE
- \* D-BOX REPLACEMENT MAY BE REQUIRED DUE TO AGE
- \* SEPTIC LINES BASED ON 4-22-76 OPERATIONAL PERMIT #8332
- \* TOP OF TANK PRESENT W/ LARGE CRACKS

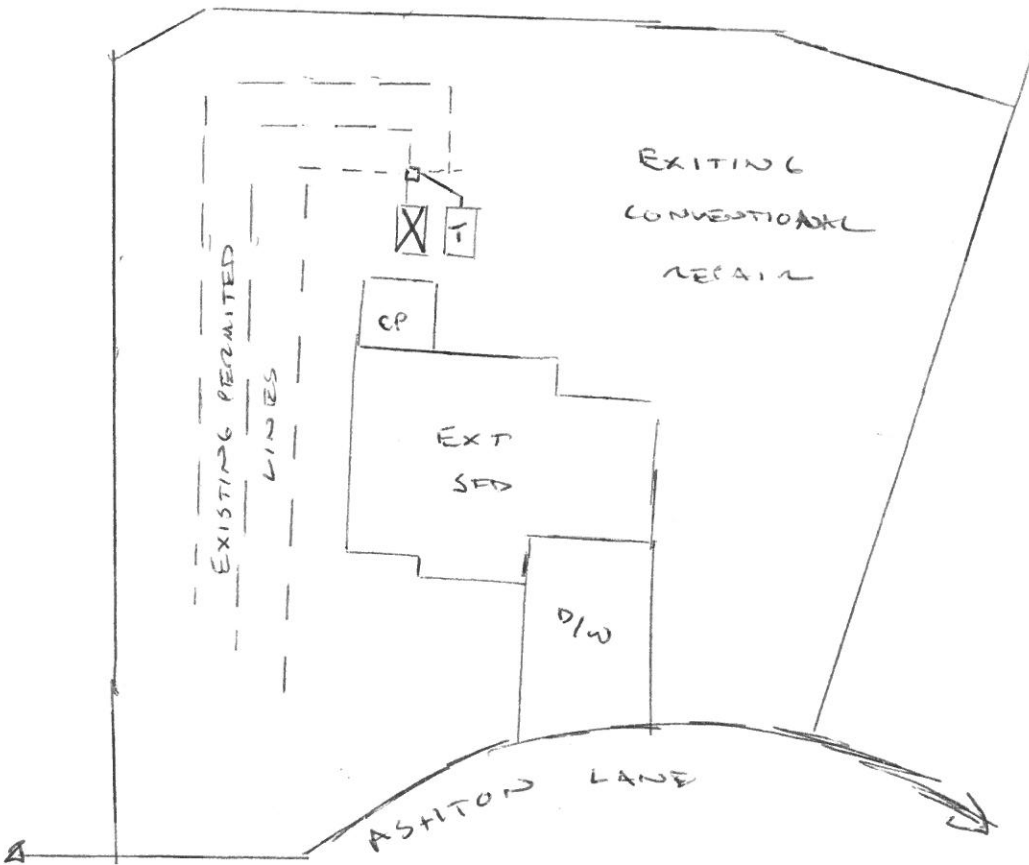

This drawing is for illustrative purposes only. System installation must meet all pertinent laws, rules, and regulations.