

HTE# EH1901-0029

Harnett County Department of Public Health

30347

Improvement Permit

A building permit cannot be issued with only an Improvement Permit

ISSUED TO: Dan Young
 NEW REPAIR EXPANSION
 Type of Structure: Existing STD
 Proposed Wastewater System Type: Existing
 Projected Daily Flow: EXT GPD
 Number of bedrooms: 3 Number of Occupants: 6 max
 Basement Yes No
 Pump Required: Yes No May be required based on final location and elevations of facilities
 Type of Water Supply: Community Public Well Distance from well NA feet
 Permit conditions: _____ Permit valid for: Five years No expiration

Authorized State Agent: [Signature] Date: 01/23/2019 SEE ATTACHED SITE SKETCH
 The issuance of this permit by the Health Department in no way guarantees the issuance of other permits. The permit holder is responsible for checking with appropriate governing bodies in meeting their requirements. This site is subject to revocation if the site plan, plat, or the intended use changes. The Improvement Permit shall not be affected by a change in ownership of the site. This permit is subject to compliance with the provisions of the Laws and Rules for Sewage Treatment and Disposal and to conditions of this permit.

Construction Authorization

(Required for Building Permit)

The construction and installation requirements of Rules .1950, .1952, .1954, .1955, .1956, .1957, .1958, and .1959 are incorporated by references into this permit and shall be met. Systems shall be installed in accordance with the attached system layout.

ISSUED TO: Dan Young PROPERTY LOCATION: 82 Ridgcrest Rd. (NC 87)
 SUBDIVISION Starwood LOT # 61
 Facility Type: Existing STD New Expansion Repair
 Basement? Yes No Basement Fixtures? Yes No
 Type of Wastewater System** Existing Conventional (Initial) Wastewater Flow: 360 GPD
 (See note below, if applicable
Pump to 25% reduction (Repair)
Installation Requirements/Conditions
 Septic Tank Size 1000 gallons (NEW) Exact length of each trench EXT feet Trench Spacing: EXT Feet on Center
 Pump Tank Size _____ gallons Trenches shall be installed on contour at a Soil Cover: EXT inches
 Maximum Trench Depth of: EXT inches (Maximum soil cover shall not exceed 36" above the trench bottom)
 (Trench bottoms shall be level to +/-1/4" in all directions)
 Pump Requirements: _____ ft. TDH vs. _____ GPM Aggregate Depth: NA inches below pipe
NA inches above pipe
NA inches total
 Conditions: NEW TANK; NEW D-BOX; ADD GWT+IMPORTED TOP SOIL; REMOVE FIRE PIT & HANDPIPE REPAIR

**WATER LINES (INCLUDING IRRIGATION) MUST BE 10FT. FROM ANY PART OF SEPTIC SYSTEM OR REPAIR AREA.
NO UTILITIES ALLOWED IN INITIAL OR REPAIR DRAIN FIELD AREA.**

**If applicable: I understand the system type specified is different from the type specified on the application. I accept the specifications of this permit.

Owner/Legal Representative Signature: _____ Date: _____

This Construction Authorization is subject to revocation if the site plan, plat, or the intended use changes. The Construction Authorization shall not be transferred when there is a change in ownership of the site. This Construction Authorization is subject to compliance with the provisions of the Laws and Rules for Sewage Treatment and Disposal and to the conditions of this permit. SEE ATTACHED SITE SKETCH

Authorized State Agent: [Signature] Date: 01/23/2019
ANDREW CURRIN Construction Authorization Expiration Date: 01/23/2024

HTE# EH1901-0029

Permit # 30347

Harnett County Department of Public Health Site Sketch

ISSUED TO: Dan Young PROPERTY LOCATION: 82 Ridgcrest Ln. (X 24-87)
SUBDIVISION: Starwood LOT # 61

Authorized State Agent: Andrew Warren Date: 01/23/2019
ANDREW WARREN

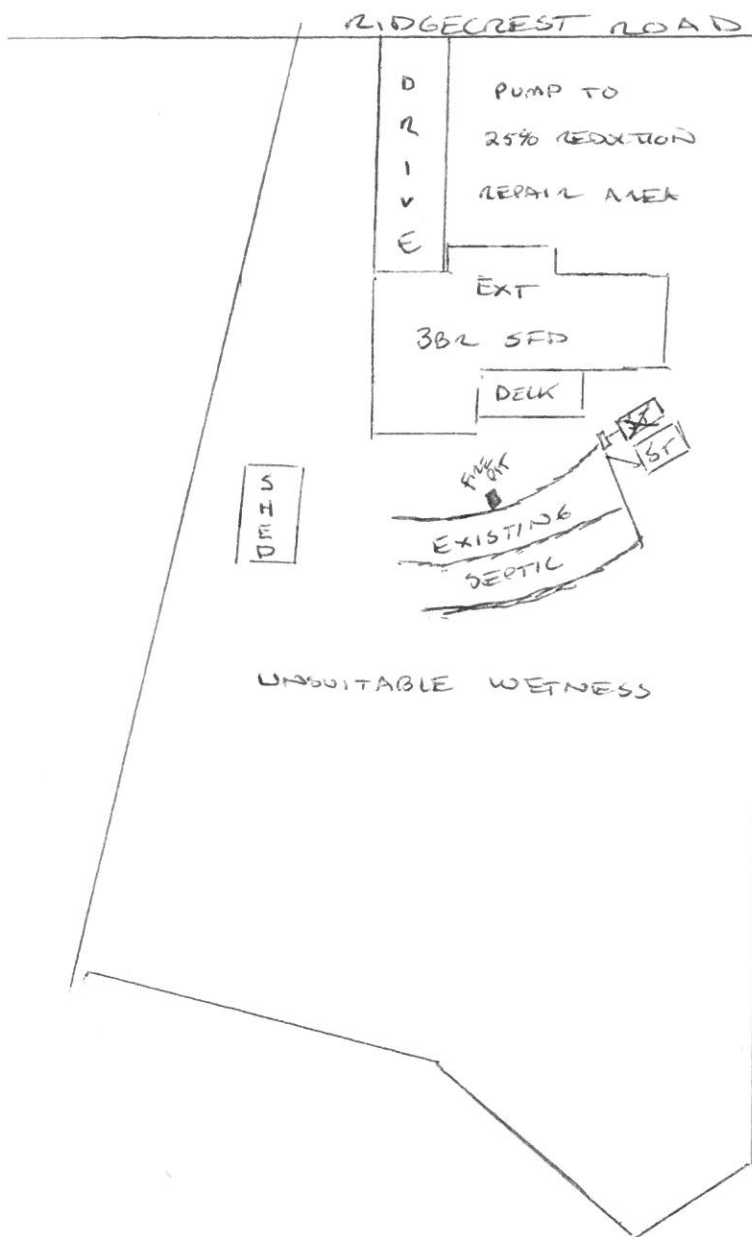

- * NEW TANK
- MAY NEED TO BE ABOVE GRADE
- EXT TANK SHALL BE PUMPED, CRUSHED AND BACKFILLED
- * D-BOX REPLACEMENT
- * ADD GINT APPROVED SOIL COVER ESPECIALLY LINES 2 & 3
- * FIRE PIT SHALL BE REMOVED AND LINE EVALUATED (#1)
- [HAUDPIPE REPAIR MAY BE REQUIRED]