

Improvement Permit

A building permit cannot be issued with only an Improvement Permit

ISSUED TO: La Mission de L'esprit Saint D'euq PROPERTY LOCATION: 7975 NC 210 N. SUBDIVISION _____ LOT # _____

NEW REPAIR EXPANSION Site Improvements required prior to Construction Authorization Issuance: _____

Type of Structure: 200 seat church w/ kitchen

Proposed Wastewater System Type: 25% reduction sys -

Projected Daily Flow: 1000 GPD

Number of bedrooms: NA Number of Occupants: NA max

Basement Yes No

Pump Required: Yes No May be required based on final location and elevations of facilities

Type of Water Supply: Community Public Well Distance from well NA feet Permit valid for: Five years No expiration

Permit conditions: _____

Authorized State Agent: [Signature] Date: 02/01/2019 SEE ATTACHED SITE SKETCH

The issuance of this permit by the Health Department in no way guarantees the issuance of other permits. The permit holder is responsible for checking with appropriate governing bodies in meeting their requirements. This site is subject to revocation if the site plan, plat, or the intended use changes. The Improvement Permit shall not be affected by a change in ownership of the site. This permit is subject to compliance with the provisions of the Laws and Rules for Sewage Treatment and Disposal and to conditions of this permit.

Construction Authorization

(Required for Building Permit)

The construction and installation requirements of Rules .1950, .1952, .1954, .1955, .1956, .1957, .1958, and .1959 are incorporated by references into this permit and shall be met. Systems shall be installed in accordance with the attached system layout.

ISSUED TO: La Mission de L'esprit Saint D'euq PROPERTY LOCATION: 7975 NC 210 N. SUBDIVISION _____ LOT # _____

Facility Type: 200 seat church w/ kitchen New Expansion Repair

Basement? Yes No Basement Fixtures? Yes No

Type of Wastewater System** 25% reduction system (Initial) Wastewater Flow: 1000 GPD

(See note below, if applicable)

Pump to 25% reduction (Repair)

Installation Requirements/Conditions

Septic Tank Size 1670 gallons (MIN) Number of trenches 8

Pump Tank Size _____ gallons Exact length of each trench 80 feet Trench Spacing: 9 Feet on Center

Trenches shall be installed on contour at a Soil Cover: 12 inches

Maximum Trench Depth of: 24 inches (Maximum soil cover shall not exceed 36" above the trench bottom)

(Trench bottoms shall be level to +/-1/4" in all directions)

Pump Requirements: _____ ft. TDH vs. _____ GPM Aggregate Depth: NA inches below pipe NA inches above pipe NA inches total

Conditions: Eight (8) 80FT lines OR Four (4) 160FT lines w/ stepdown at ends. Pump may be required

*PUMP MAY BE *
REQUIRED

WATER LINES (INCLUDING IRRIGATION) MUST BE 10FT. FROM ANY PART OF SEPTIC SYSTEM OR REPAIR AREA.
NO UTILITIES ALLOWED IN INITIAL OR REPAIR DRAIN FIELD AREA.

**If applicable: I understand the system type specified is different from the type specified on the application. I accept the specifications of this permit.

Owner/Legal Representative Signature: _____ Date: _____

This Construction Authorization is subject to revocation if the site plan, plat, or the intended use changes. The Construction Authorization shall not be transferred when there is a change in ownership of the site. This Construction Authorization is subject to compliance with the provisions of the Laws and Rules for Sewage Treatment and Disposal and to the conditions of this permit. SEE ATTACHED SITE SKETCH

Authorized State Agent: [Signature] Date: 02/01/2019
ANDREW CURRIE Construction Authorization Expiration Date: 02/01/2024

HTE# EH 1812-0018

Permit # 30455

Harnett County Department of Public Health Site Sketch

PROPERTY LOCATOR: 7975 NC 210 NW

ISSUED TO: La Mission de L'esprit -
Saint D'euq SUBDIVISION _____ LOT # _____

Authorized State Agent: *[Signature]* Date: 02/01/2019
ANDREW CURRAN

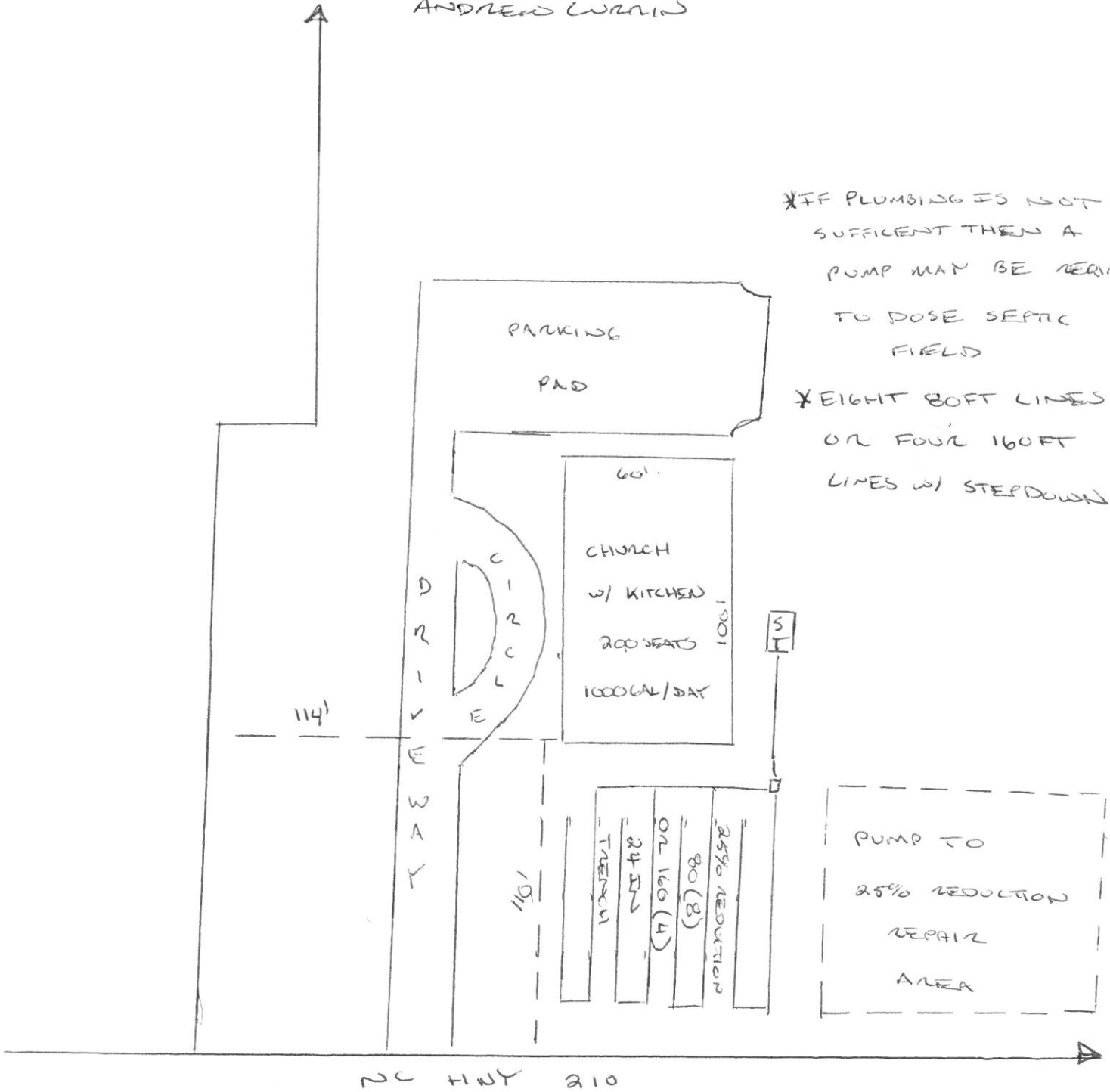

*IF PLUMBING IS NOT SUFFICIENT THEN A PUMP MAY BE REQUIRED TO DOSE SEPTIC FIELDS

*EIGHT 80FT LINES OR FOUR 160FT LINES w/ STEPDOWN

PUMP TO 25% REDUCTION REPAIR AREA

NC HWY 210

Preliminary Septic Proposal Area

1,000 gallon/day Flow Rate

LaMission Church

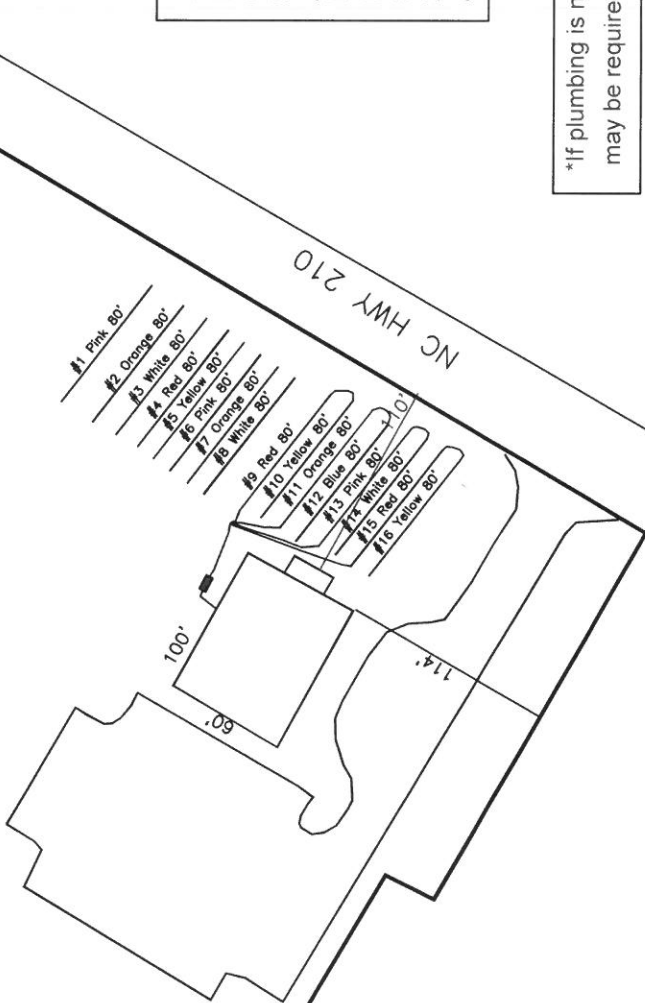

System: *Gravity to D-Box
 Lines: 9-16 (640')
 0.4 LTAR
 24" max Trench Bottom
 Accepted Status System
 Repair: *Pump to D-Box
 Lines: 1-8 (640')
 0.4 LTAR
 24" max Trench Bottom
 Accepted Status System

*if plumbing is not sufficient then a pump may be required to dose septic field.

GRAPHIC SCALE
 1" = 100'



LaMission Church

7325 NC 210N-Angier, NC

200 seat max capacity Church (1000 gal./day)

<u>LINE #</u>	<u>COLOR</u>	<u>BS</u>	<u>HI</u>	<u>FS</u>	<u>ELEVATION</u>	<u>LINE LENGTH</u>	<u>Design Length</u>
TBM		2.0		100.0		<u>in field</u>	<u>installation</u>
INST. 1			102.0				
1	Pink			1	101	80	80
2	Orange			1.4	100.6	80	80
3	White			1.7	100.3	80	80
4	Red			2	100	80	80
5	Yellow			2.3	99.7	80	80
6	Pink			2.5	99.5	80	80
7	Orange			2.9	99.1	80	80
8	White			3.3	98.7	80	80
9	<i>Red</i>			3.6	<i>98.4</i>	<i>80</i>	<i>80</i>
10	<i>Yellow</i>			4.2	<i>97.8</i>	<i>80</i>	<i>80</i>
11	<i>Orange</i>			4.8	<i>97.2</i>	<i>80</i>	<i>80</i>
12	<i>Blue</i>			5.3	<i>96.7</i>	<i>80</i>	<i>80</i>
13	<i>Pink</i>			5.6	<i>96.4</i>	<i>80</i>	<i>80</i>
14	<i>White</i>			6	<i>96</i>	<i>80</i>	<i>80</i>
15	<i>Red</i>			6.3	<i>95.7</i>	<i>80</i>	<i>80</i>
16	<i>Yellow</i>			6.7	<i>95.3</i>	<i>80</i>	<i>80</i>
Total							640

	<u>System</u>	<u>Repair</u>
	Lines 9-16	Lines 1-8
System Type	Accepted Status System EZ-FLOW	Accepted Status System EZ-FLOW
Suggested Soil LTAR	0.40	0.40
Total Line Length	640	640
Square Footage	1920	1920
Proposed Trench Bottom	24"	24"
Distribution Method	Gravity to D-Box	Pump to D-Box