

HTE# _____

Harnett County Department of Public Health

29987

Improvement Permit

A building permit cannot be issued with only an Improvement Permit

ISSUED TO: Shelton Satterfield
 NEW REPAIR EXPANSION
 Type of Structure: EX SFD
 Proposed Wastewater System Type: EX
 Projected Daily Flow: 360 GPD
 Number of bedrooms: 3 Number of Occupants: 6 max
 Basement Yes No
 Pump Required: Yes No May be required based on final location and elevations of facilities
 Type of Water Supply: Community Public Well Distance from well _____ feet
 Permit conditions: _____

PROPERTY LOCATION: 501435 Wed Dennis
 SUBDIVISION Johnson Farms I LOT # 4
 Site Improvements required prior to Construction Authorization Issuance: _____

Permit valid for: Five years
 No expiration

Authorized State Agent: James E. Marshall Date: 12-10-18 SEE ATTACHED SITE SKETCH
 The issuance of this permit by the Health Department in no way guarantees the issuance of other permits. The permit holder is responsible for checking with appropriate governing bodies in meeting their requirements. This site is subject to revocation if the site plan, plat, or the intended use changes. The Improvement Permit shall not be affected by a change in ownership of the site. This permit is subject to compliance with the provisions of the Laws and Rules for Sewage Treatment and Disposal and to conditions of this permit..

Construction Authorization

(Required for Building Permit)

The construction and installation requirements of Rules .1950, .1952, .1954, .1955, .1956, .1957, .1958, and .1959 are incorporated by references into this permit and shall be met. Systems shall be installed in accordance with the attached system layout.

ISSUED TO: Shelton Satterfield

PROPERTY LOCATION: 501435 Wed Dennis
 SUBDIVISION Johnson Farms I LOT # 4

Facility Type: EX SFD New Expansion Repair

Basement? Yes No Basement Fixtures? Yes No

Type of Wastewater System** _____ (Initial) Wastewater Flow: 360 GPD

(See note below, if applicable)

NEW TANK (Repair)

Installation Requirements/Conditions

Septic Tank Size 1000 gallons
 Pump Tank Size _____ gallons

Number of trenches _____
 Exact length of each trench _____ feet
 Trenches shall be installed on contour at a
 Maximum Trench Depth of: _____ inches
 (Trench bottoms shall be level to +/-1/4"
 in all directions)

Trench Spacing: _____ Feet on Center
 Soil Cover: _____ inches
 (Maximum soil cover shall not exceed
 36" above the trench bottom)

Pump Requirements: _____ ft. TDH vs. _____ GPM

Aggregate Depth: _____ inches below pipe
 _____ inches above pipe
 _____ inches total

Conditions: _____

**WATER LINES (INCLUDING IRRIGATION) MUST BE 10FT. FROM ANY PART OF SEPTIC SYSTEM OR REPAIR AREA.
 NO UTILITIES ALLOWED IN INITIAL OR REPAIR DRAIN FIELD AREA.**

**If applicable: I understand the system type specified is different from the type specified on the application. I accept the specifications of this permit.

Owner/Legal Representative Signature: _____ Date: _____

This Construction Authorization is subject to revocation if the site plan, plat, or the intended use changes. The Construction Authorization shall not be transferred when there is a change in ownership of the site. This Construction Authorization is subject to compliance with the provisions of the Laws and Rules for Sewage Treatment and Disposal and to the conditions of this permit. SEE ATTACHED SITE SKETCH

Authorized State Agent: James E. Marshall Date: 12-10-18

Construction Authorization Expiration Date: 12-10-23

HTE# _____

Permit # 29987

Harnett County Department of Public Health Site Sketch

ISSUED TO: Shelton Satterfield PROPERTY LOCATION: 2439 West DENNIS
SUBDIVISION: JOHNSON FARMS E LOT # 4

Authorized State Agent: James E. Marshall Date: 12-10-18

NEW TANK

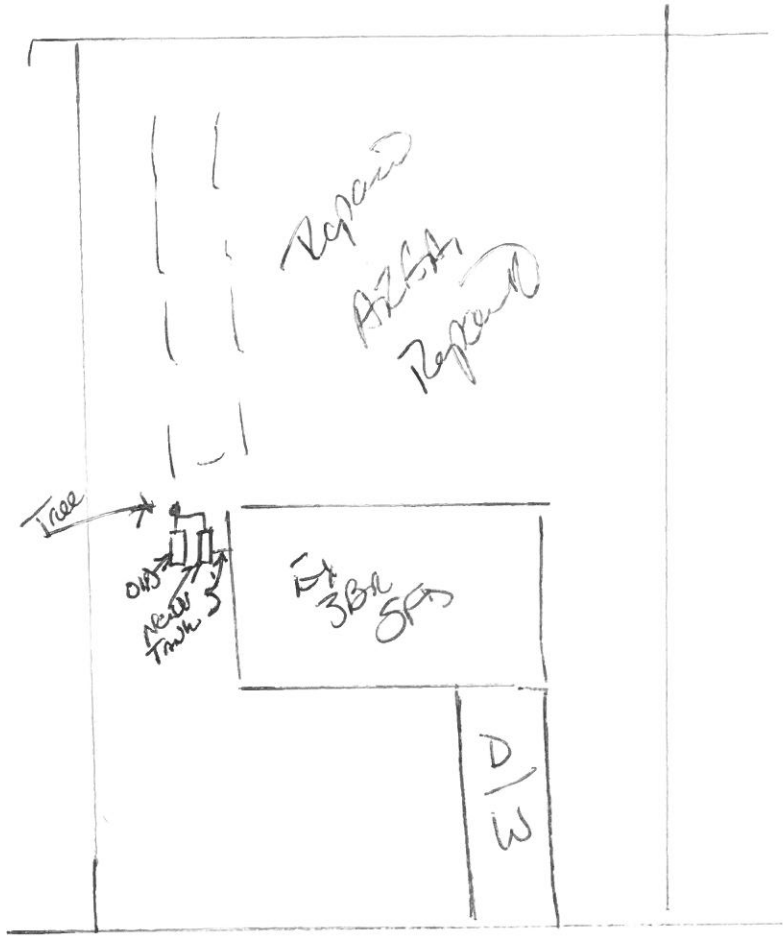

2439 WEST DENNIS