

HTE# Repair

Harnett County Department of Public Health

30215

Improvement Permit

A building permit cannot be issued with only an Improvement Permit

ISSUED TO: _____ PROPERTY LOCATION: _____
 SUBDIVISION _____ LOT # _____
 NEW REPAIR EXPANSION Site Improvements required prior to Construction Authorization Issuance: _____
 Type of Structure: _____
 Proposed Wastewater System Type: _____
 Projected Daily Flow: _____ GPD
 Number of bedrooms: _____ Number of Occupants: _____ max
 Basement Yes No
 Pump Required: Yes No May be required based on final location and elevations of facilities
 Type of Water Supply: Community Public Well Distance from well _____ feet Permit valid for: Five years
 Permit conditions: _____ No expiration

Authorized State Agent: _____ Date: _____ SEE ATTACHED SITE SKETCH
 The issuance of this permit by the Health Department in no way guarantees the issuance of other permits. The permit holder is responsible for checking with appropriate governing bodies in meeting their requirements. This site is subject to revocation if the site plan, plat, or the intended use changes. The Improvement Permit shall not be affected by a change in ownership of the site. This permit is subject to compliance with the provisions of the Laws and Rules for Sewage Treatment and Disposal and to conditions of this permit.

Construction Authorization

(Required for Building Permit)

The construction and installation requirements of Rules .1950, .1952, .1954, .1955, .1956, .1957, .1958, and .1959 are incorporated by references into this permit and shall be met. Systems shall be installed in accordance with the attached system layout.

ISSUED TO: RD Home Sales PROPERTY LOCATION: 2652 RAYNOR McLAMB RD
 SUBDIVISION _____ LOT # _____
 Facility Type: Ext SFD New Expansion Repair
 Basement? Yes No Basement Fixtures? Yes No
 Type of Wastewater System** _____ (Initial) Wastewater Flow: 360 GPD
 (See note below, if applicable)

(Repair)
Installation Requirements/Conditions
 Septic Tank Size 1000 gallons
 Pump Tank Size 1000 gallons
 Number of trenches 1
 Exact length of each trench 225 feet
 Trench Spacing: 9 Feet on Center
 Trenches shall be installed on contour at a
 Maximum Trench Depth of: 12 inches
 (Trench bottoms shall be level to +/-1/4" in all directions)
 Soil Cover: 6 inches
 (Maximum soil cover shall not exceed 36" above the trench bottom)
 Pump Requirements: _____ ft. TDH vs. _____ GPM _____ inches below pipe
 Aggregate Depth: _____ inches above pipe
 Conditions: MINIMUM OF 6" OF COVER NEEDED OVER DRAIN FIELD _____ inches total

**WATER LINES (INCLUDING IRRIGATION) MUST BE 10FT. FROM ANY PART OF SEPTIC SYSTEM OR REPAIR AREA.
NO UTILITIES ALLOWED IN INITIAL OR REPAIR DRAIN FIELD AREA.**

**If applicable: I understand the system type specified is different from the type specified on the application. I accept the specifications of this permit.
 Owner/Legal Representative Signature: _____ Date: _____

This Construction Authorization is subject to revocation if the site plan, plat, or the intended use changes. The Construction Authorization shall not be transferred when there is a change in ownership of the site. This Construction Authorization is subject to compliance with the provisions of the Laws and Rules for Sewage Treatment and Disposal and to the conditions of this permit. SEE ATTACHED SITE SKETCH

Authorized State Agent: [Signature] Date: 9/13/18
 Construction Authorization Expiration Date: 9/13/23

HTE# REPAIR

Permit # 30215

Harnett County Department of Public Health Site Sketch

ISSUED TO: R.D. HOME SALES PROPERTY LOCATOR: 2652 RAYNOR McLAMB RD
SUBDIVISION _____ LOT # _____

Authorized State Agent: ~~_____~~ DEAN OLIVER TOLKSDORF Date: 9/13/19

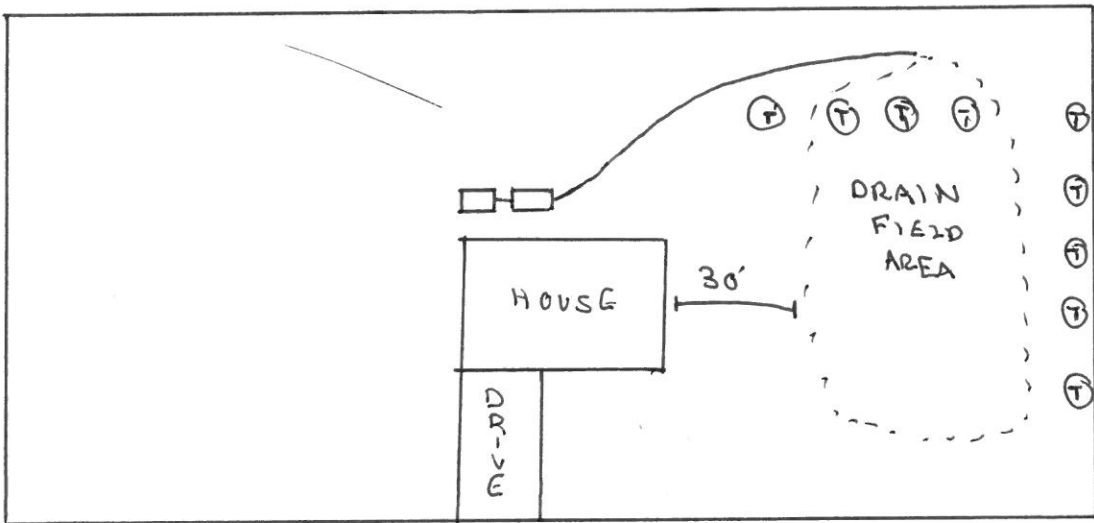

RAYNOR McLAMB RD

- * MEET ON SITE FOR FINAL DRAIN FIELD LAYOUT
- * MINIMUM OF 6" OF COVER NEEDED OVER DRAIN FIELD
- * SOME TREE REMOVAL MAY BE REQUIRED

**SOIL/SITE EVALUATION
 for ON-SITE WASTEWATER SYSTEM**

Owner: _____ Applicant: _____
 Address: _____ Date Evaluated: **9/12/78**
 Proposed Facility: _____ Design Flow (.1949): **360 yd** Property Size: _____
 Location of Site: _____ Property Recorded: _____
 Water Supply: Public Individual Well Spring Other
 Evaluation Method: Auger Boring Pit Cut
 Type of Wastewater: Sewage Industrial Process Mixed

P R O F I L E #	.1940 Landscape Position/ Slope %	Horizon Depth (In.)	SOIL MORPHOLOGY .1941		OTHER PROFILE FACTORS				Profile Class & LTAR
			.1941 Structure/ Texture	.1941 Consistence Mineralogy	.1942 Soil Wetness/ Color	.1943 Soil Depth (IN.)	.1956 Sapro Class	.1944 Restr Horiz	
1	LS 5-7	0-17	G SL	VFA NS/M					
		17-36	SBX SCL	FA SS/SP	CR2 @ 27"				PS .4
		0-17	G SL	VFA NS/M					
		17-30	SBX SCL + 1960	FA SS/SP	CR2 @ 27"				PS .4
		0-26	G SL	VFA NS/M					
		26-30	SBX SCL	FA SS/SP	CR2 @ 29"				PS .4
		0-20	G SL	VFA NS/M					
		20-36	SBX SCL	FA SS/SP	CR2 @ 28"				PS .4

Description	Initial System	Repair System	Other Factors (.1946): P2 Site Classification (.1948): P2 Evaluated By: FT Others Present: PS
Available Space (.1945)		✓	
System Type(s)		10 MP 25% QSD	
Site LTAR		.4	