



Initial Application Date: 3/13/2024

Application # _____
DRB # _____ CU # _____

COMMERCIAL

COUNTY OF HARNETT LAND USE APPLICATION

Central Permitting (Physical) 108 E. Front Street, Lillington, NC 27546 (Mailing) PO Box 65 Lillington NC 27546 Phone: (910) 893-7525 opt # 2 Fax: (910) 893-2793 www.harnett.org/permits

LANDOWNER: FULL GOSPEL TABERNACLE YOUTH CAMP Mailing Address: 3661 NC HWY 55 EAST

City: DUNN State: NC Zip: 28334 Contact # 910-237-3262 Email: pastortim@powerpointchurch.net

APPLICANT*: Parish signs & service, inc Mailing Address: PO box 766

City: Raeford State: NC Zip: 28376 Contact # Michael Bassett Email: mbass@parishsigns.com

*Please fill out applicant information if different than landowner

CONTACT NAME APPLYING IN OFFICE: Michael Bassett Phone # 910-875-6121

Address: same as above PIN: _____

Deed Book Page: /

PROPOSED USE:

- Multi-Family Dwelling No. Units: _____ No. Bedrooms/Unit: _____
- Business Sq. Ft. Retail Space: _____ Type: _____ # Employees: _____ Hours of Operation: _____
- Daycare # Preschoolers: _____ # Afterschoolers: _____ # Employees: _____ Hours of Operation: _____
- Industry Sq. Ft: _____ Type: _____ # Employees: _____ Hours of Operation: _____
- Church Seating Capacity: _____ # Bathrooms: _____ Kitchen: _____
- Accessory/Addition/Other (Size _____ x _____) Use: _____

Water Supply: County Existing Well New Well (# of dwellings using well _____) *Must have operable water before final
(Need to Complete New Well Application at the same time as New Tank)

Sewage Supply: New Septic Tank Expansion Relocation Existing Septic Tank County Sewer
(Complete Environmental Health Checklist on other side of application if Septic)

Comments:

If permits are granted I agree to conform to all ordinances and laws of the State of North Carolina regulating such work and the specifications of plans submitted. I hereby state that foregoing statements are accurate and correct to the best of my knowledge. Permit subject to revocation if false information is provided.

[Signature]
Signature of Owner or Owner's Agent

3/13/24
Date

****This application expires 6 months from the initial date if permits have not been issued****

RECORDED DEED (OR OFFER TO PURCHASE) AND PLAT ARE REQUIRED WHEN APPLYING FOR LAND USE APPLICATION

*****It is the owner/applicants responsibility to provide the county with any applicable information about the subject property, including but not limited to: boundary information, house location, underground or overhead easements, etc. The county or its employees are not responsible for any incorrect or missing information that is contained within these applications.*****

This application expires 6 months from the initial date if permits have not been issued



APPLICATION CONTINUES ON BACK

****This application expires 6 months from the initial date if permits have not been issued****

This application to be filled out when applying for a septic system inspection.

County Health Department Application for Improvement Permit and/or Authorization to Construct

IF THE INFORMATION IN THIS APPLICATION IS FALSIFIED, CHANGED, OR THE SITE IS ALTERED, THEN THE IMPROVEMENT PERMIT OR AUTHORIZATION TO CONSTRUCT SHALL BECOME INVALID. The permit is valid for either 60 months or without expiration depending upon documentation submitted. (Complete site plan = 60 months; Complete plat = without expiration)

Environmental Health New Septic System

- **All property irons must be made visible.** Place "pink property flags" on each corner iron of lot. All property lines must be clearly flagged approximately every 50 feet between corners.
- Place "orange house corner flags" at each corner of the proposed structure. Also flag driveways, garages, decks, out buildings, swimming pools, etc. Place flags per site plan developed at/for Central Permitting.
- Place orange Environmental Health card in location that is easily viewed from road to assist in locating property.
- If property is thickly wooded, Environmental Health requires that you clean out the **undergrowth** to allow the soil evaluation to be performed. Inspectors should be able to walk freely around site. **Do not grade property.**
- **All lots to be addressed within 10 business days after confirmation. \$25.00 return trip fee may be incurred for failure to uncover outlet lid, mark house corners and property lines, etc. once lot confirmed ready.**

Environmental Health Existing Tank Inspections

- Follow above instructions for placing flags and card on property.
- Prepare for inspection by removing soil over **outlet end** of tank as diagram indicates, and lift lid straight up (if possible) and then **put lid back in place.** (Unless inspection is for a septic tank in a mobile home park)
- **DO NOT LEAVE LIDS OFF OF SEPTIC TANK**

"MORE INFORMATION MAY BE REQUIRED TO COMPLETE ANY INSPECTION"

SEPTIC

If applying for authorization to construct please indicate desired system type(s): can be ranked in order of preference, must choose one.

- Accepted Innovative Conventional Any
 Alternative Other _____

The applicant shall notify the local health department upon submittal of this application if any of the following apply to the property in question. If the answer is "yes", applicant **MUST ATTACH SUPPORTING DOCUMENTATION**:

- YES NO Does the site contain any Jurisdictional Wetlands?
 YES NO Do you plan to have an irrigation system now or in the future?
 YES NO Does or will the building contain any drains? Please explain. _____
 YES NO Are there any existing wells, springs, waterlines or Wastewater Systems on this property?
 YES NO Is any wastewater going to be generated on the site other than domestic sewage?
 YES NO Is the site subject to approval by any other Public Agency?
 YES NO Are there any Easements or Right of Ways on this property?
 YES NO Does the site contain any existing water, cable, phone or underground electric lines?

If yes please call No Cuts at 800-632-4949 to locate the lines. This is a free service.

I Have Read This Application And Certify That The Information Provided Herein Is True, Complete And Correct. Authorized County And State Officials Are Granted Right Of Entry To Conduct Necessary Inspections To Determine Compliance With Applicable Laws And Rules. I Understand That I Am Solely Responsible For The Proper Identification And Labeling Of All Property Lines And Corners And Making The Site Accessible So That A Complete Site Evaluation Can Be Performed.



*Each section below must be filled out by whoever is performing the work. Must be owner or licensed contractor. Address, company name & phone must match information on state license.

Application # _____
Harnett County Central Permitting
PO Box 65 Lillington, NC 27546
910-893-7525 Fax 910-893-2793 www.harnett.org/permits

COMMERCIAL

Application for Building and Trades Permit

Owner's Name: FULL GOSPEL TABERNACLE YOUTH CAMP Date: 3/13/24

Site Address: 3661 NC HWY 55 EAST Phone: 910-237-3262

Description of Proposed Work: INSTALL NEW CHURCH SIGN

General Contractor Information: Building Cost \$ 20,000.00

PARISH SIGNS AND SERVICE, INC 910-875-6121

Building Contractor's Company Name Telephone

PO BOX 766, RAEFORD, NC 28376 MBASS@PARISHSIGNS.COM

Address Email Address

[Signature] SP-ES.31026

Signature of Owner/Contractor/Officer(s) of Corporation License #

Electrical Contractor Information: Electrical Cost \$ 4000.00

Description of Work POWER TO THE SIGN Service Size: 40 Amps #T-Poles 0

LOCKE GROUP PLLC 910-827-9195

Electrical Contractor's Company Name Telephone

PO BOX 818, PEMBROKE, NC28372

Address Email Address

[Signature] U.32506

Signature of Owner/Contractor/Officer(s) of Corporation License #

Mechanical Contractor Information: Mechanical Cost \$ _____

Description of Work _____ # Units _____

Mechanical Contractor's Company Name Telephone

Address Email Address

Signature of Owner/Contractor/Officer(s) of Corporation License #

Plumbing Contractor Information: Plumbing Cost \$ _____

Description of Work _____ # Baths _____

Plumbing Contractor's Company Name Telephone

Address Email Address

Signature of Owner/Contractor/Officer(s) of Corporation License #

Insulation Contractor Information

Insulation Contractor's Company Name & Address Telephone

***NOTE: General Contractor must fill out and sign the second page of this application**

Sprinkler Contractor Information

Sprinkler Contractor's Company Name _____	Telephone _____
Address _____	Email Address _____
Signature of Officer(s) of Corporation _____	License # _____

Fire Alarm Contractor Information

Fire Alarm Contractor's Company Name _____	Telephone _____
Address _____	Email Address _____
Signature of Officer(s) of Corporation _____	License # _____

Driveway Access - NC Department of Transportation Driveway Access/Permit? Yes No

I hereby certify that I have the authority to make necessary application, that the application is correct and that the construction will conform to the regulations in the Building, Electrical, Plumbing and Mechanical codes, and the Harnett County Zoning Ordinance. I state the information on the above contractors is correct as known to me and if **any** changes occur including listed contractors, site plan, number of bedrooms, building and trade plans, Environmental Health permit changes or proposed use changes, I certify it is my responsibility to notify the Harnett County Central Permitting Department of any and all changes.

Expired Permit Fees - 6 months to 2 years permit re-issue fee is \$150.00. After 2 years re-issue fee is charged at full price per current fee schedule.

Signature of Owner/Contractor/Officer(s) of Corporation _____

Date 3/13/24

Affidavit for Worker's Compensation N.C.G.S. 87-14

The undersigned applicant being the:

General Contractor Owner Officer/Agent of the Contractor or Owner

Do hereby confirm under penalties of perjury that the person(s), firm(s) or corporation(s) performing the work set forth in the permit:

Has three (3) or more employees and has obtained workers' compensation insurance to cover them.

Has one (1) or more subcontractors(s) and has obtained workers' compensation insurance to cover them.

Has one (1) or more subcontractors(s) who has their own policy of workers' compensation insurance covering themselves.

Has no more than two (2) employees and no subcontractors.

While working on the project for which this permit is sought it is understood that the Central Permitting Department issuing the permit may require certificates of coverage of worker's compensation insurance prior to issuance of the permit and at any time during the permitted work from any person, firm or corporation carrying out the work.

Sign w/Title: _____ Date: _____

Parish
SIGN & SERVICE
INCORPORATED
A Sign of Excellence
www.parishsigns.com

627 Laurinburg Road
Raeford, NC 28376
(910) 875-6121
(800) 622-2431
(910) 875-7100 FAX
Info@parishsigns.com

SPECIFICATIONS

TYPE OF SIGNAGE	TYPE OF FACES
INTERNALLY ILLUMINATED DOUBLE FACE PAN SIGN WITH VINYL GRAPHICS + ADDITIONAL DF PAN SIGN WITH VINYL LOGO APPLIED + 10M LED MESSAGE CENTER	MAIN ID: PAN FACE LOGO: PAN FACE LED MESSAGE CENTER

FACE MATERIAL/COLORS	CABINET COLORS/MATERIALS
MAIN ID FACES: PAN FACE BURGUNDY 3630-46 BACKGROUND WITH WHITE COPY	CABINET CONSTRUCTED OF ALUMINUM AND PAINTED TO MATCH BURGUNDY 3630-46

TYPE OF ILLUMINATION	RETURN COLORS
LEDS	MATCH BURGUNDY 3630-46

LED COLORS	TRIM COLORS
WHITE	NA

MISCELLANEOUS	RACEWAY COLORS
WIRED TO UL SPECIFICATIONS BEARING UL LABEL	NA

FONT: **Vintage SSK**

COLOR AND CLARITY MAY VARY FROM DRAWING

notes:

JOB NAME: FULL GOSPEL TABERNACLE
LOCATION: DUNN, NC
CUSTOMER: PASTOR GEORGE
SALESMAN: MICHAEL BASSETT
DRAWING #: 021524-FGT-MON
FILENAME: FULLGOSPELTABERNACLE-MONUMENT.FS

designer: MMH date: 02/16/24
revisions: MMH 02/21/24
JT 02/26/24
JT 03/11/24

COPY RIGHTS RESERVED

This drawing is the property of Parish Sign & Service Inc. Any reproduction copying exposing and/or allowing anyone to manufacture this sign is prohibited without written permission from Parish Sign & Service Incorporated.

Customer's Signature/Approval

Date



FACE VIEW OF SIGNAGE WITH DIMENSIONS

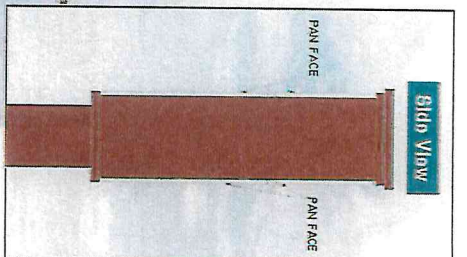
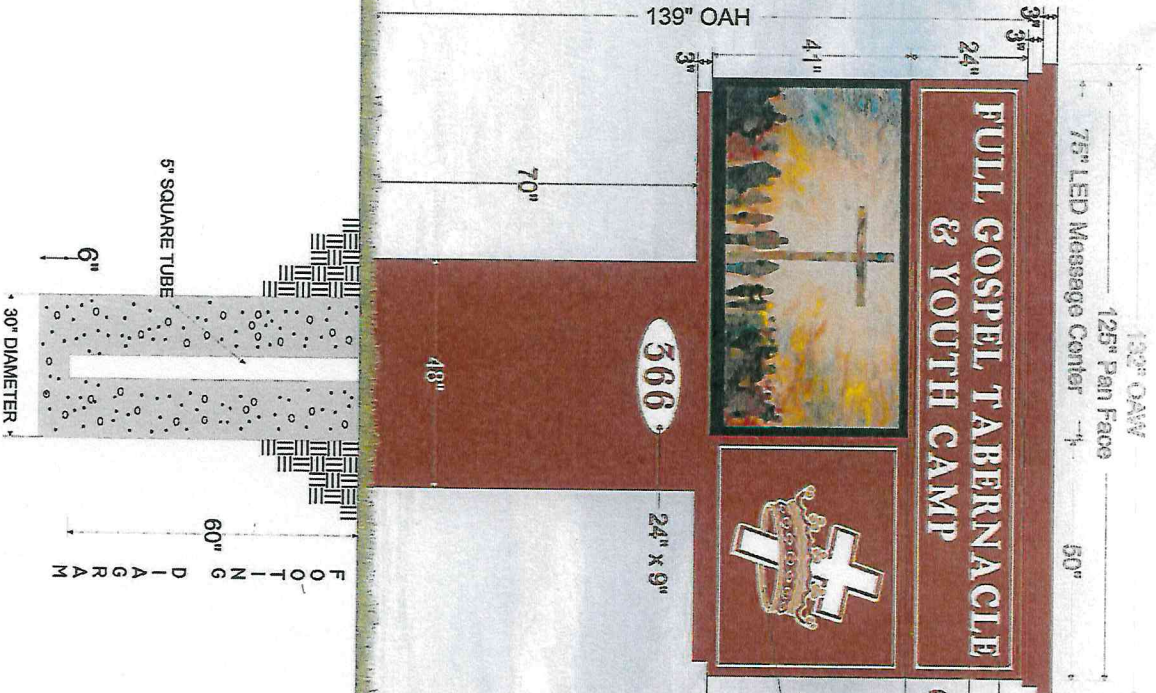



(910) 875-6121 (800) 622-2431
627 Laurinburg Rd. Raeford, NC 28376
PO Box 766 Raeford, NC 28376
www.parishsigns.com

JOB NAME: <u>FULL GOSPEL</u>	Job No.:
ADDRESS: <u>3661 HWY 55 EAST</u>	Date: <u>3/13/24</u>
<u>Dunn, NC</u>	Surveyor:
Contact: <u>Michael Bassett</u>	page: <u>1</u> of <u>1</u>

BUILDING ELEVATIONS

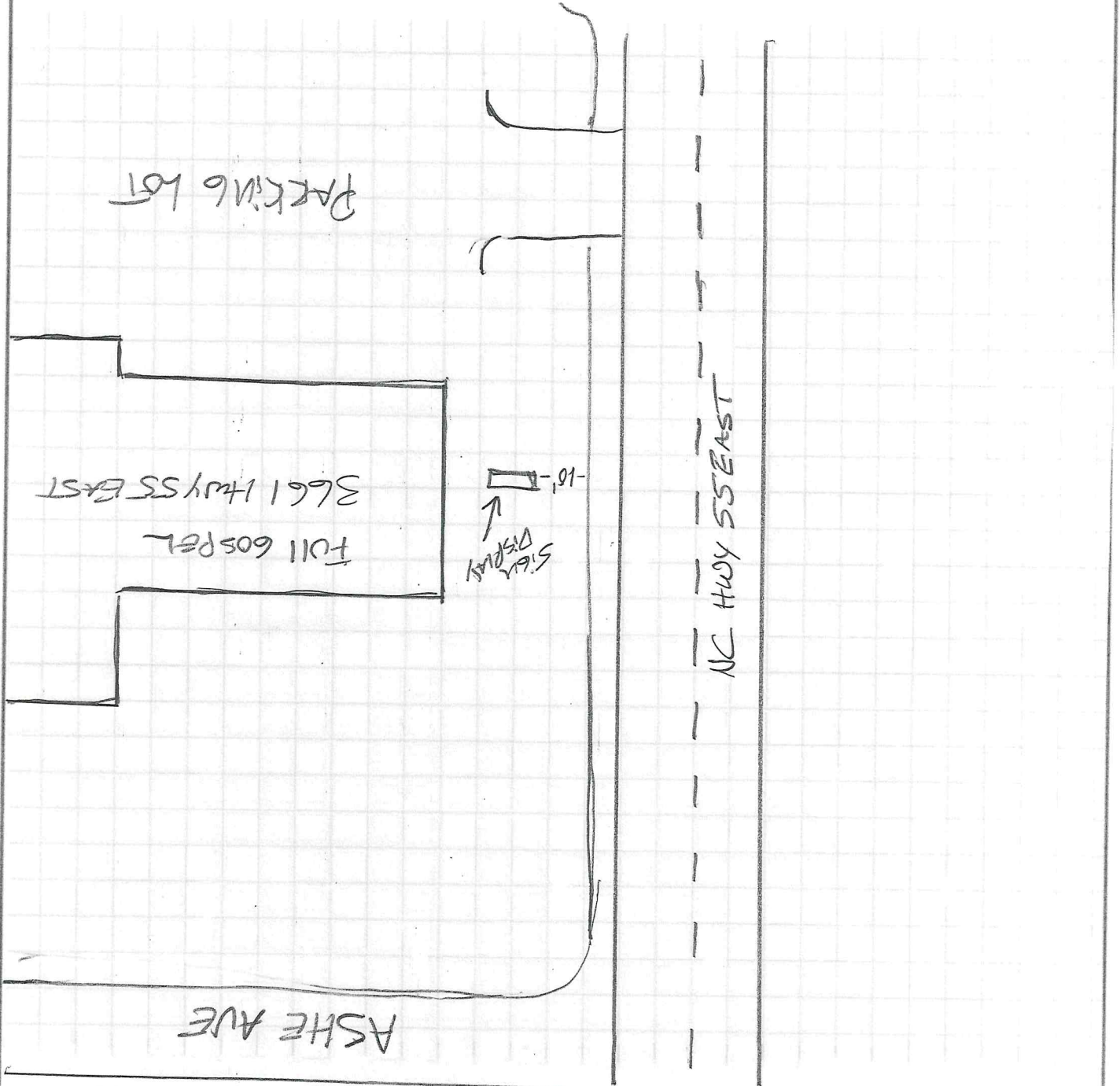

PHOTOS:

- Photos should be good, in focus and straight on, in order to create an accurate scale in future drawings.
- Include photos of all elevations. Maintain grade to roof line elevations in all photos.