

Harnett County Central Permitting

Mailing Address - PO Box 65 Lillington, NC 27546 – Physical Address – 420 McKinney PKWY Lillington NC 27546

Ph.: 910-893-7525 - Fax: 910-893-2793 - www.harnett.org/permits

Certification of Work Performed By Owner/Contractor
(Individual Trade Application)

Owner (s) of Structure: 200 W 13th LLC Phone: _____

Owner (s) Mailing Address: 200 W 13th St Fernia N.C 28339
Brooklyn NY 11211-6262

Land Owner Name (s): 200 W 13th LLC Phone: 1-928-214-9811

Construction or Site Address: 200 W 13th Suite 301

PIN # _____ Parcel # _____

Job Cost (Required): 16,000.00 Description of Work to be done New ~~SW~~, lights,
Electrical panel, Rec, Backup/Exit Lights

Mechanical: New Unit With Ductwork ___ New Unit Without Ductwork ___ Gas Piping ___ Other ___

Electrical*: 200 Amp ___ <200 Amp ___ Service Change ___ Service Reconnect ___ Other ___
* For Progress Energy customers we need the premise number

Plumbing: Water/Sewer Tap ___ Number of Baths ___ Water Heater ___

Specific Directions to Job from Lillington:

Subdivision: _____ Lot #: _____

I Kevin McMillan will provide the Electrical labor on this structure.
(Contractors Name) (Trade)

I am the building owner or my NC state license number is 28731-I, which entitles me to perform such work on the above structure legally. All work shall comply with the State Building Code and all other applicable State and local laws, ordinances and regulations.

McMillan Electric
Contractor's Company Name
2079 Old US 701 Hary Clinton N.C
Address
28731-I
License # 28328

910-385-3135
Telephone

Email Address

Structure Owner / Contractor Signature: Kevin McMillan Date: 1-22-24

By signing this application, you affirm that you have obtained permission from the above listed license holder to purchase permits on their behalf. If doing the work as owner you understand that you cannot rent, lease or sell the listed property for 12 months after completion of the listed work.

***Company name, address, & phone must match information on license**
Faxed or Mailed application could have an approximately 1-5 day process time

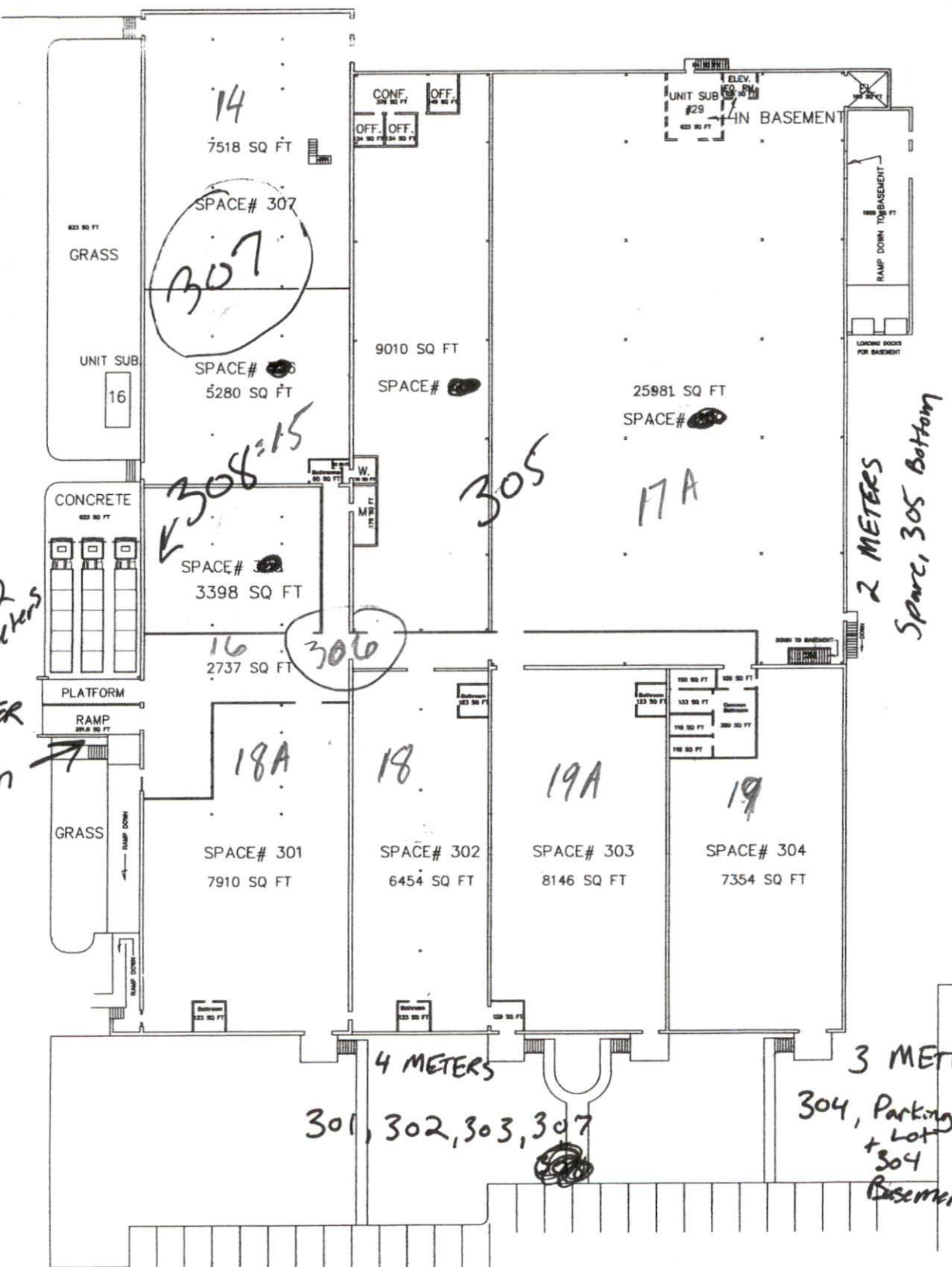

Change to 2 meters
 7 METER
 Common AREA
 + 308

308, 15

2 METERS
 Space, 305 Bottom

4 METERS
 301, 302, 303, 307

3 METERS
 304, Parking, 305 Top + 304 Basement