

# METRONET NETWORK CABINET CONSTRUCTION DRAWINGS



3701 COMMUNICATIONS WAY  
EVANSVILLE, IN 47715  
812-213-1095

THIS PRINT AND DESIGN ARE THE SOLE PROPERTY OF METRONET TECHNOLOGIES L.C. AND SHALL BE CONSIDERED CONFIDENTIAL. THIS PRINT MAY NOT BE REPRODUCED IN ANY MANNER WITHOUT THE WRITTEN CONSENT OF METRONET TECHNOLOGIES L.C. AND SHALL BE RETURNED UPON REQUEST.

2-BAY NETWORK  
CABINET  
DUNN, NC

DESIGN ENG: LWW  
DRAWN BY: SLF  
REVIEWED BY: LWW

SUBMITTALS		
DATE	DESCRIPTION	REV
9/22/22	PERMITTING	A

**SITE LOCATION MAP**  
LAT/LONG: 35.258756, -78.676368  
3856 NC-82, DUNN, NC, 28334



## TABLE OF CONTENTS

COVER PAGE	01
SITE PLAN	02
CABINET DETAILS	03-05
ELECTRICAL DETAILS/ GROUNDING PLAN	06

**CALL 48 HOURS  
BEFORE DIGGING**



Know what's below.  
**Call before you dig.**

PERMITTING

## METRONET CONTACTS:

PROJECT DIRECTOR:

CHRIS DEER  
334-805-7607  
CHRISTOPHER.DEER@METRONET.COM

ENGINEER:

LEE W. WRIGHT, P.E.  
METRONET  
8837 BOND ST  
OVERLAND PARK, KS 66214  
(810)-333-2303  
LEE.WRIGHT@METRONET.COM

SCALE:	NTS
SITE ADDRESS:	3856 NC-82
SITE NAME:	DUNN CABINET
SHEET NAME:	COVER SHEET
SHEET NUMBER:	1



**SEE SHEET 3  
FOR SITE DETAILS**



3781 COMMUNICATIONS WAY  
EVANSVILLE, IN 47715  
812-213-1095

THIS PRINT AND DESIGN ARE THE SOLE PROPERTY OF METRONET TECHNOLOGIES LLC, AND SHALL BE CONSIDERED CONFIDENTIAL. THIS PRINT MAY NOT BE REPRODUCED IN ANY MANNER WITHOUT THE WRITTEN CONSENT OF METRONET TECHNOLOGIES LLC, AND SHALL BE RETURNED UPON REQUEST.

**2-BAY NETWORK  
CABINET  
DUNN, NC**

DESIGN ENG: LWW  
DRAWN BY: SLF  
REVIEWED BY: LWW

SUBMITTALS		
DATE	DESCRIPTION	REV
9/22/22	PERMITTING	A

SCALE: 1" = 60'

SITE ADDRESS: 3856 NC-82

SITE NAME: DUNN CABINET

SHEET NAME: SITE PLAN

SHEET NUMBER: 2

# CABINET MOUNTING DETAIL



3701 COMMUNICATIONS WAY  
EVANSVILLE, IN 47715  
812-213-1095

THIS PRINT AND DESIGN ARE THE SOLE PROPERTY OF METRONET TECHNOLOGIES LLC, AND SHALL BE CONSIDERED CONFIDENTIAL. THIS PRINT MAY NOT BE REPRODUCED IN ANY WAY WITHOUT THE WRITTEN CONSENT OF METRONET TECHNOLOGIES LLC, AND SHALL BE RETURNED UPON REQUEST.

2-BAY NETWORK CABINET  
DUNN, NC

DESIGN ENG: LWW

DRAWN BY: SLF

REVIEWED BY: LWW

### SUBMITTALS

DATE	DESCRIPTION	REV
9/22/22	PERMITTING	A

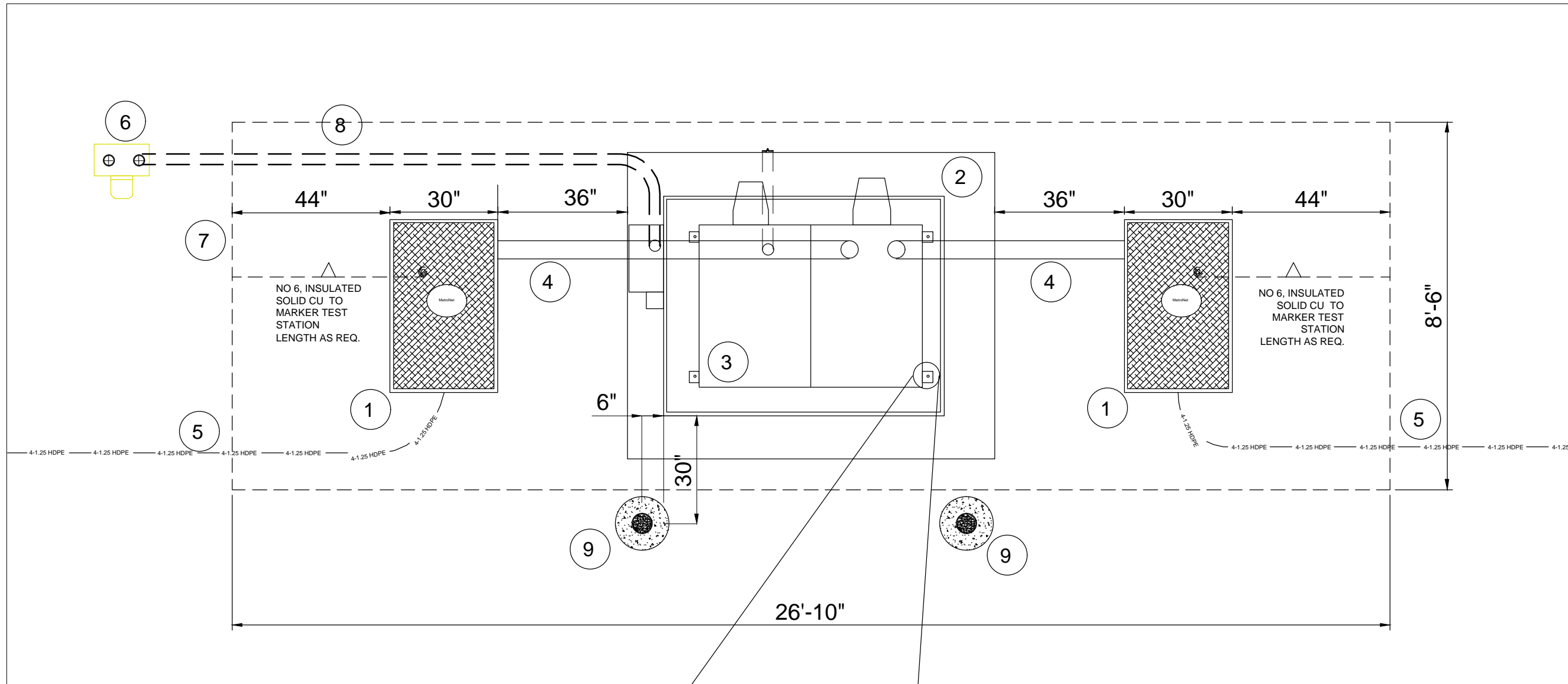

### DETAIL NOTES:

1. 30"Wx48"Lx30"D Handhole
2. Cabinet Concrete Pad 8'-6"L x 7'-1"W
3. Cabinet Footprint 62"L x 45"W
4. 2 Ea. 4" SCH 40 PVC Conduit
5. 4 Ea. 1 1/4" HDPE Duct
6. Meter Pedestal (ELECTRICAL)
7. 3" SCH 40 PVC Elect. Conduit-UL Listed
8. Ground Field Extents
9. 5" ID DIA x 7'L Steel Pipe Bollard, Concrete Filled. (As Required, Site Specific)

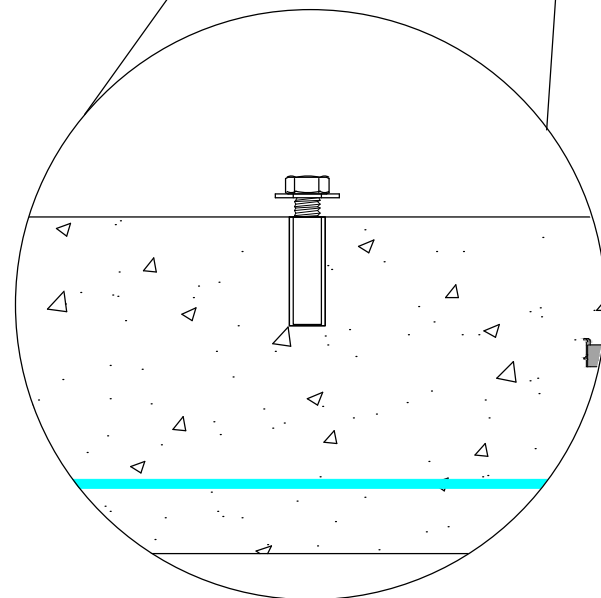

CONCRETE FASTENING TYPICAL  
1/2" STAINLESS STEEL DROP IN  
ANCHOR - 1/2" NUT & FLAT WASHER

**INSTALLATION NOTE:**  
DRILL AND INSTALL WEDGE ANCHORS  
DURING PLACEMENT OF THE CABINET  
ONTO THE PAD TO INSURE  
PLACEMENT ACCURACY.

SCALE: NTS

SITE ADDRESS:  
3846 NC-82

SITE NAME:  
DUNN CABINET

SHEET NAME:  
CABINET DETAILS

SHEET NUMBER:

3

**BOLLARDS - OPTIONAL AS SITE DICTATES**  
**PIPE BOLLARD SPECIFICATIONS:**

CARBON STEEL PIPE SHALL BE 5"ID DIA X 7'L, CONFORMING TO SCHEDULE 40 ASTM A 53 GRADES A AND B.

1. PIPE SHALL BE FILLED WITH A MIN 3,000 PSI CONCRETE. A DOMED CAP 1" HIGH SHALL BE HAND FORMED TO PROVIDE WATER RUNOFF.
2. CONCRETE FOOTER SHALL BE A MIN 3,000 PSI CONCRETE, 3'D X 15" DIA.
3. PIPE SHALL BE PROVIDED FACTORY PAINTED WITH RUST INHIBITOR PRIMER FINISH. THE FINAL FINISH SHALL BE PAINTED YELLOW.

**GENERAL NOTE:**

- A.) A FINAL INSPECTION OF THE SITE CONFIRMING THE SITE IS RESTORED AND CLEANED UP SHALL BE COMPLETED BY THE PROJECT MANAGER PRIOR TO FINAL METRONET ACCEPTANCE OF THE WORK.

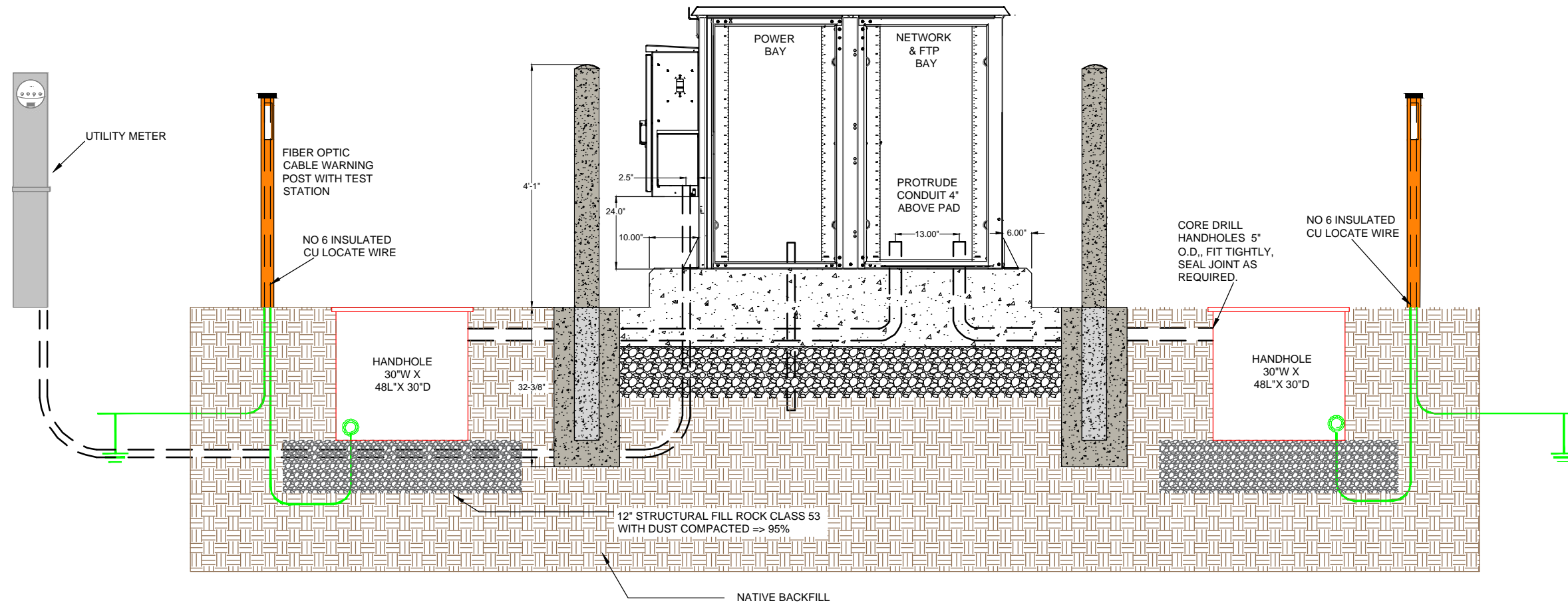

3701 COMMUNICATIONS WAY  
 EVANSVILLE, IN 47715  
 812-213-1095

THIS PRINT AND DESIGN ARE THE SOLE PROPERTY OF METRONET TECHNOLOGIES LLC, AND SHALL BE CONSIDERED CONFIDENTIAL. THIS PRINT MAY NOT BE REPRODUCED IN ANY MANNER WITHOUT THE WRITTEN CONSENT OF METRONET TECHNOLOGIES LLC, AND SHALL BE RETURNED UPON REQUEST.

**2-BAY NETWORK  
 CABINET  
 DUNN, NC**

DESIGN ENG: LWW  
 DRAWN BY: SLF  
 REVIEWED BY: LWW

SUBMITTALS		
DATE	DESCRIPTION	REV
9/22/22	PERMITTING	A

SCALE: NTS  
 SITE ADDRESS: 3856 NC-82  
 SITE NAME: DUNN CABINET  
 SHEET NAME: CABINET DETAILS  
 SHEET NUMBER: 4



3701 COMMUNICATIONS WAY  
EVANSVILLE, IN 47715  
812-213-1095

THIS PRINT AND DESIGN ARE THE SOLE PROPERTY OF METRONET TECHNOLOGIES LLC. AND SHALL BE CONSIDERED CONFIDENTIAL. THIS PRINT MAY NOT BE REPRODUCED IN ANY WAY WITHOUT THE WRITTEN CONSENT OF METRONET TECHNOLOGIES LLC, AND SHALL BE RETURNED UPON REQUEST.

**2-BAY NETWORK CABINET  
DUNN, NC**

DESIGN ENG: LWW  
DRAWN BY: SLF  
REVIEWED BY: LWW

**SUBMITTALS**

DATE	DESCRIPTION	REV
9/22/22	PERMITTING	A

SCALE: NTS  
SITE ADDRESS: 3856 NC-82  
SITE NAME: DUNN CABINET  
SHEET NAME: CABINET DETAILS  
SHEET NUMBER: 5

**SPECIFICATIONS AND NOTES**

**SITE:**  
STRUCTURAL FILL SHALL BE MECHANICALLY COMPACTED IN 6" LIFTS TO 95% OR GREATER PROCTOR (ASTM D-698). WITH A COMPACTION TEST RUN ON EACH LIFT (1 TEST PER 248 SF). STRUCTURAL FILL SHALL EXTEND A MINIMUM OF 12" BEYOND THE PAD PERIMETER. ALL SUBGRADE WITHIN THE SLAB AREA SHALL BE COMPACTED TO 95% STANDARD PROCTOR. THE CONTRACTOR SHALL MAINTAIN POSITIVE DRAINAGE ON THE SITE AT ALL TIMES. ALL EXCAVATION SHALL BE FREE OF WATER BEFORE PLACING CONCRETE.

**CONCRETE CODE:**  
ALL CONCRETE SHALL BE MIXED, FORMED, FINISHED, CURED, AND PROTECTED IN CONFORMANCE WITH THE RECOMMENDATIONS OF THE PORTLAND CEMENT ASSOCIATION (PCA) AND THE AMERICAN CONCRETE INSTITUTE (ACI)

**MIX:**  
PORTLAND CEMENT SHALL CONFORM TO ASTM C150, TYPE II. MIX SHALL HAVE 20% (BY CEMENTITIOUS MATERIAL WEIGHT) FLY ASH CONFORMING TO ASTM C618, CLASS F. MIX SHALL BE FIBER REINFORCED CONFORMING TO ASTM A820-06 - STANDARD SPECIFICATIONS FOR FOR COMMERCIAL FIBER-REINFORCED CONCRETE. AGGREGATE SIZE SHALL BE 1/2" NOMINAL AND SHALL CONFORM TO ASTM C33. MINIMUM COMPRESSIVE STRENGTH AT 28 DAYS SHALL BE 4000 PSI. MAXIMUM SLUMP SHALL BE 5.5 INCHES. NO STRENGTH ACCELERATING ADDITIVES WITHOUT APPROVAL OF ENGINEER.

**REINFORCEMENT STEEL:**  
REINFORCING SHALL BE DEFORMED BILLET-STEEL BARS CONFORMING TO ASTM A615, GRADE 60. REINFORCEMENT SHALL BE COLD BENT AND SHALL NOT BE WELDED. REINFORCEMENT SHALL BE CLEANED SO AS TO BE FREE OF OIL, DIRT, LOOSE MILL SCALE, AND LOOSE RUST OR OTHER COATINGS THAT WOULD DESTROY OR REDUCE THE BOND.

**REINFORCEMENT CONTINUITY:**  
UNLESS SHOWN OTHERWISE ON THE DESIGN DRAWINGS, ALL REINFORCEMENT SHALL BE PLACED CONTINUOUS BY LAP SPlicing, UNLESS DETAILED OTHERWISE ON DESIGN DRAWINGS. REINFORCEMENT SHALL BE ACCURATELY PLACED AS PER ACI 301 AND SECURELY TIGHTLY TIED INTO POSITION WITH NO. 16 GA. ANNEALED WIRE NO GREATER THAN 2" INTERVALS ALONG THE LAP SPlicing.

**PLACEMENT AND CURE:**  
PRODUCTION OF CONCRETE SHALL COMPLY WITH CHAPTER 7 OF ACI 301. PLACEMENT OF CONCRETE SHALL BE IN ACCORDANCE WITH CHAPTER 8 OF ACI 301. DURING HOT WEATHER, THE TEMPERATURE OF THE CONCRETE, AS PLACED, SHALL NOT EXCEED 90° F. DURING COLD WEATHER, CONCRETE SHALL BE MAINTAINED ABOVE 50° F FOR AT LEAST 7 DAYS AFTER PLACEMENT. HOT AND COLD WEATHER CONCRETE PLACEMENT SHALL BE IN ACCORDANCE WITH ACI 305 AND ACI 306. FRESHLY DEPOSITED CONCRETE SHALL BE PROTECTED FROM PREMATURE DRYING AND EXCESSIVELY HOT OR COLD TEMPERATURES AND SHALL BE MAINTAINED WITH MINIMAL MOISTURE LOSS AT A RELATIVELY CONSTANT TEMPERATURE FOR THE PERIOD OF TIME NECESSARY FOR THE HYDRATION OF THE CEMENT AND PROPER HARDENING OF THE CONCRETE. ALL NEWLY PLACED CONCRETE SHALL BE KEPT MOIST FOR A MINIMUM OF 7 DAYS. CURING SHALL CONFORM TO THE REQUIREMENTS IN CHAPTER 12, ACI 301.

**FINISHING:**  
TIE HOLES, HONEYCOMBS, AND OTHER CONCRETE SURFACE DEFECTS SHALL BE REPAIRED IN ACCORDANCE WITH CHAPTER 9 OF ACI 301 AS SOON AS PRACTICABLE AFTER FORM REMOVAL. THE REPAIR SHALL BE PERFORMED IN SUCH A MANNER AS TO NOT DELAY, INTERFERE WITH, OR IMPAIR THE PROPER CURING OF THE FRESH CONCRETE. THE ENGINEER SHALL BE NOTIFIED BEFORE PROCEEDING WITH REPAIR IF THE DEFECT IS GREATER THAN 5 INCHES DEEP AND LARGER THAN 200 SQUARE INCHES IN SURFACE AREA, OR IF THE DEPTH IS OVER 1/3 THE THICKNESS OF THE MEMBER AND GREATER THAN 6 INCHES IN ANY OTHER DIRECTION.

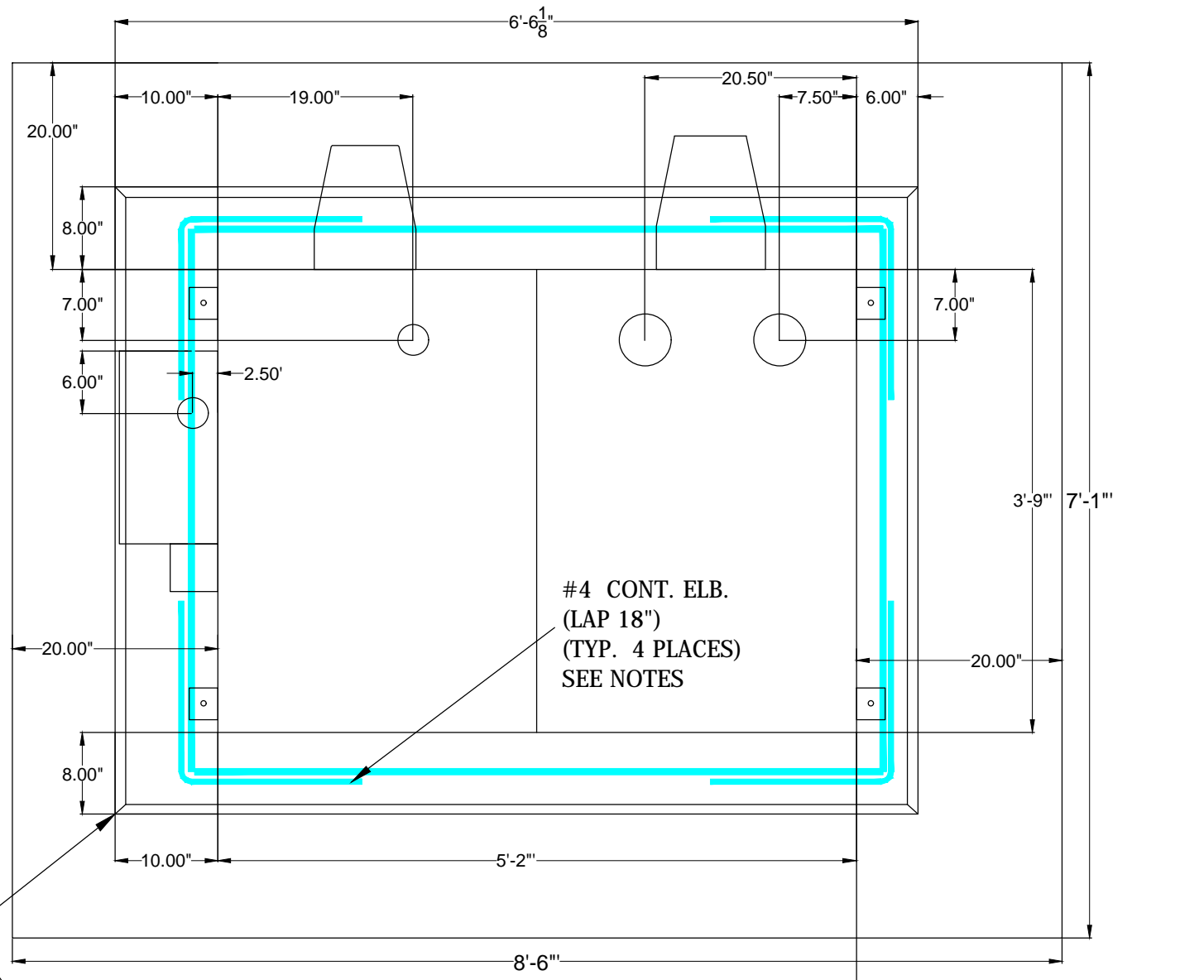

#4 CONT. ELB.  
(LAP 18")  
(TYP. 4 PLACES)  
SEE NOTES

3/4" 45 DEGREE CHAMFER  
EDGE ALL SIDES

8" REVEAL  
ABOVE  
FINAL  
GRADE

12" DEPTH CLASS 53  
CRUSHED ROCK, WITH  
DUST COMPACTED => 95%

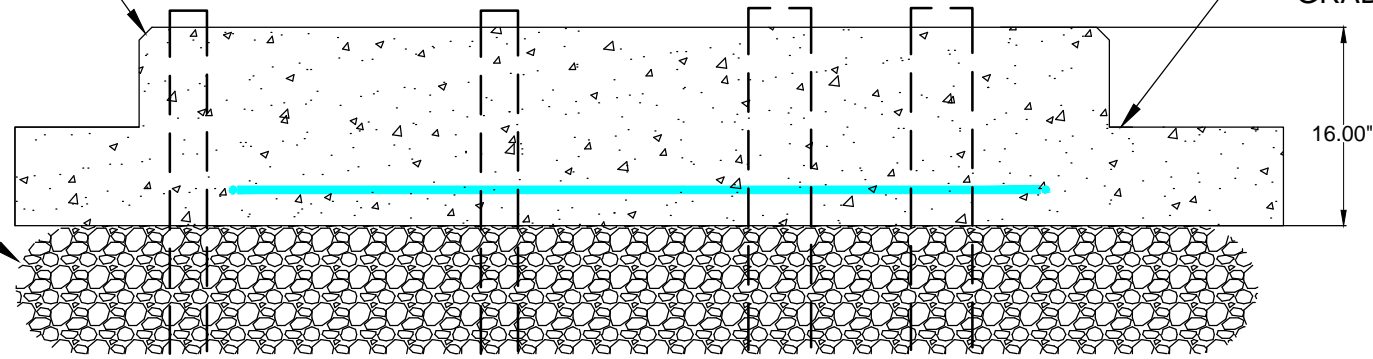

**NETWORK 2-BAY CABINET CONCRETE PAD  
CONSTRUCTION**



3701 COMMUNICATIONS WAY  
EVANSVILLE, IN 47715  
812-213-1095

THIS PRINT AND DESIGN ARE THE SOLE PROPERTY OF METRONET TECHNOLOGIES LLC, AND SHALL BE CONSIDERED CONFIDENTIAL. THIS PRINT MAY NOT BE REPRODUCED IN ANY MANNER WITHOUT THE WRITTEN CONSENT OF METRONET TECHNOLOGIES LLC, AND SHALL BE RETURNED UPON REQUEST.

2-BAY NETWORK CABINET  
DUNN, NC

DESIGN ENG: LWW

DRAWN BY: SLF

REVIEWED BY: LWW

SUBMITTALS

DATE	DESCRIPTION	REV
9/22/22	PERMITTING	A

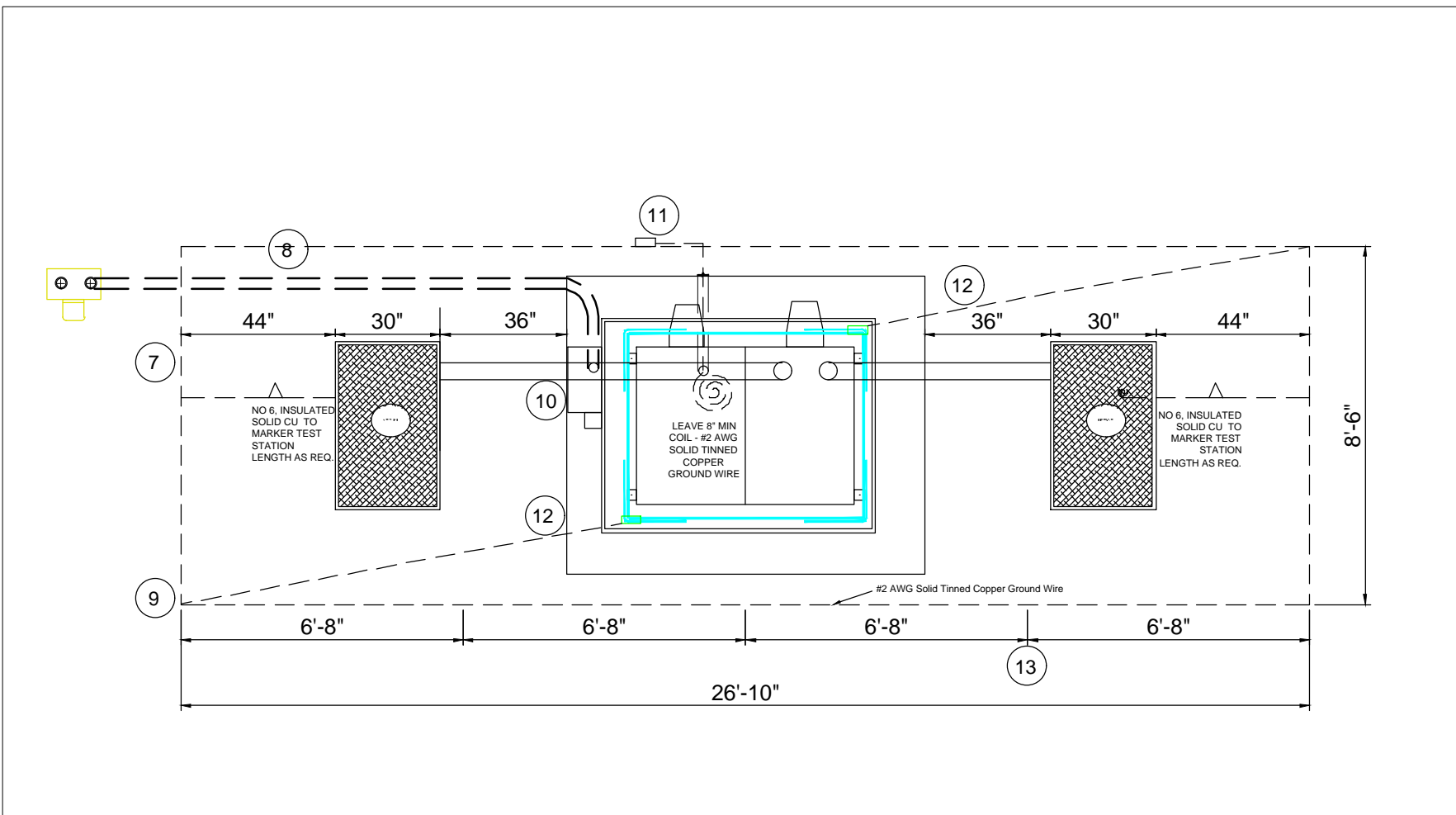
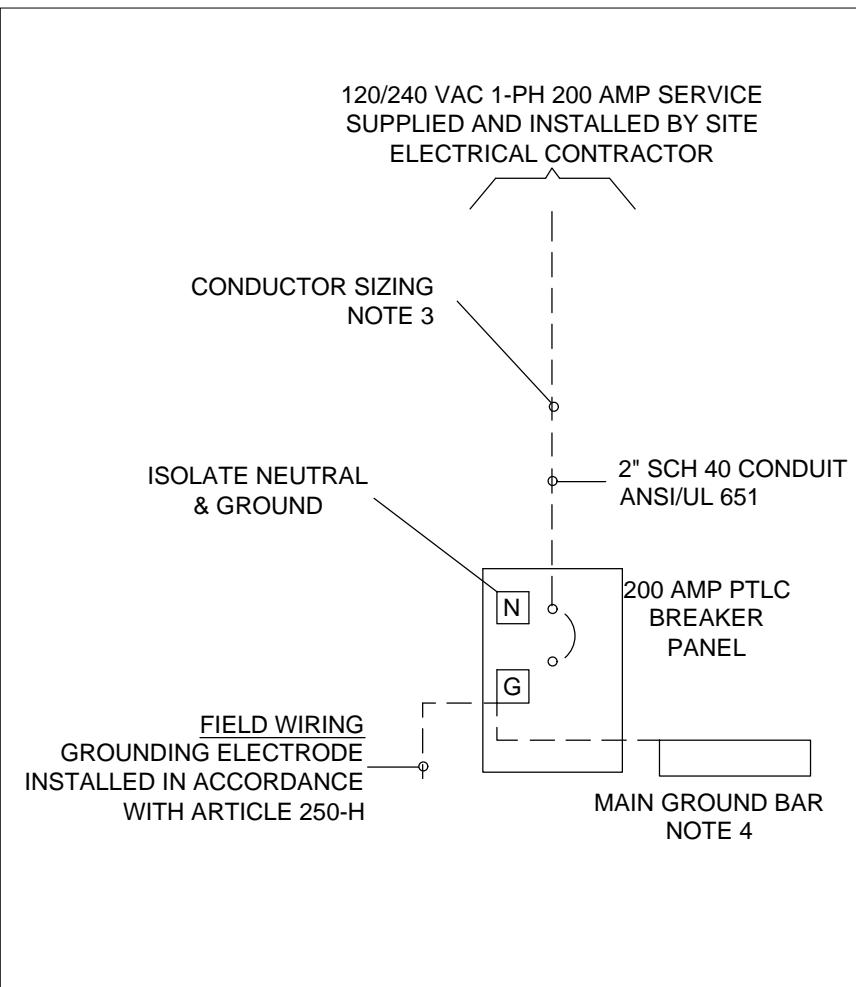

**NOTES:**

1. ----- DASHED LINES DENOTE FIELD WORK.
2. ISOLATE NEUTRAL & GROUND
3. FEEDER CONDUCTORS (3) 2/0 THHN AND (1) NO.4 THHN GROUND IN ACCORDANCE WITH NEC (ARTICLE 215.2).
4. #2 THHN BOND BETWEEN BREAKER GROUND AND MAIN GROUND BAR
5. ALL LUGS THAT HOLD MORE THAN ONE WIRE SHALL BE LISTED FOR MULTI-BARRELL CONNECTIONS.
6. ALL CONDUCTORS SHALL BE COPPER.
7. 120/240 VAC, 200AMP, SINGLE PHASE PEDESTAL COORDINATE INSTALLATION WITH LOCAL ELECTRIC UTILITY.
8. 3" SCHEDULE 40 CONDUIT, ANSI/UL 651. MEETING OR OR EXCEEDING THE REQUIREMENTS OF NEMA TC-2
9. COPPER CLAD STEEL GROUND RODS, 5/8" X 8', 10 EA.
10. INTERSECT 200 AMP 120/240 SINGLE PHASE POWER TRANSFER LOAD CENTER (PTLC)
11. ALL GROUND RING CONDUCTORS AND GROUND ROD CONNECTIONS SHALL BE EXOTHERMIC WELDED.
12. UFER GROUND-EXOTHERMIC WELD TO NO 4 REBAR, COORDINATE WITH CONCRETE CONTRACTOR.
13. GROUND RING CONDUCTORS AND TOP OF GROUND RODS SHALL BE BURIED A MINIMUM DEPTH OF 18".

SCALE: NTS

SITE ADDRESS:  
3846 NC-82

SITE NAME:  
DUNN CABINET

SHEET NAME:  
CABINET ELECTRICAL DETAILS/  
GROUNDING PLAN

SHEET NUMBER: