

Initial Application Date: 3-31-03

Application # C-50006719

COUNTY OF HARNETT LAND USE APPLICATION

BA-CU10-03

Central Permitting

102 E. Front Street, Lillington, NC 27546

Phone: (910) 893-4759

Fax: (910) 893-2793

LANDOWNER: Geraldine Smith
City: PO Box 5095

Mailing Address: _____
State: _____ Zip: _____ Phone #: _____

APPLICANT: Johnny & Kimberly James
City: Angier

Mailing Address: 373 E. William St
State: NC Zip: 27501 Phone #: 919-639-6484

PROPERTY LOCATION: SR #: 1532 SR Name: Langdon Rd.

Parcel: 04-0682-0012-06 PIN: 0682-77-3685

Zoning: RA30 Subdivision: Calvin Mycatt Lot #: 3 Lot Size: .69

Flood Plain: X Panel: 50 Watershed: IV Deed Book/Page: 1443/248 Plat Book/Page: Tax Map

If located with a Watershed indicate the % of Impervious Surface: _____
DIRECTIONS TO THE PROPERTY FROM LILLINGTON: 210 N to Angier (R) onto Hwy 55
towards Coats (L) onto Guy Rd, onto SR 1532 Lot 3

PROPOSED USE:

- Sg. Family Dwelling (Size x) # of Bedrooms _____ # Baths _____ Basement (w/wo bath) _____ Garage _____ Deck _____
- Multi-Family Dwelling No. Units _____ No. Bedrooms/Unit _____
- Manufactured Home (Size 28'x60') # of Bedrooms 3 Garage na Deck na

Comments: _____
Number of persons per household 3

- Business Sq. Ft. Retail Space _____ Type _____
- Industry Sq. Ft. _____ Type _____
- Home Occupation (Size x) # Rooms _____ Use _____
- Accessory Building (Size x) Use _____
- Addition to Existing Building (Size x) Use _____
- Other _____

Water Supply: County Well (No. dwellings _____) Other _____

Sewage Supply: New Septic Tank Existing Septic Tank County Sewer Other _____

Erosion & Sedimentation Control Plan Required? YES NO

Structures on this tract of land: Single family dwellings _____ Manufactured homes 1 proposed DWMH Other (specify) _____

Property owner of this tract of land own land that contains a manufactured home w/in five hundred feet (500') of tract listed above? YES NO

Required Property Line Setbacks:	Minimum	Actual	Minimum	Actual
Front	<u>35</u>	<u>60</u>	Rear	<u>25</u>
Side	<u>10</u>	<u>37</u>	Corner	<u>-</u>
Nearest Building	<u>-</u>	<u>-</u>		

If permits are granted I agree to conform to all ordinances and the laws of the State of North Carolina regulating such work and the specifications or plans submitted. I hereby swear that the foregoing statements are accurate and correct to the best of my knowledge.

Signature of Owner or Owner's Agent: [Signature]

Date: Mar 21, 03

This application expires 6 months from the date issued if no permits have been issued

A RECORDED SURVEY PLAT AND RECORDED DEED ARE REQUIRED WHEN APPLYING FOR A LAND USE PERMIT

201 3/21 N

1" = 100'

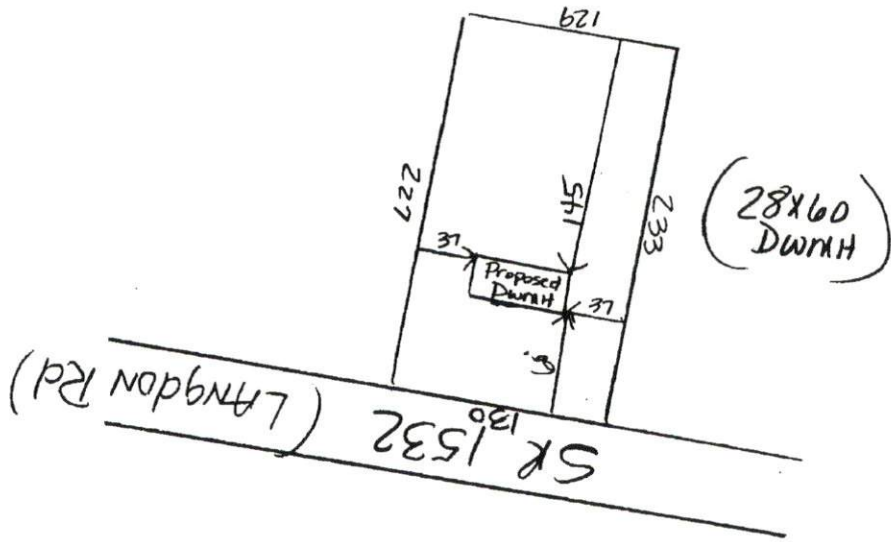

SITE PLAN APPROVAL

DISTRICT RA 30 USE DwMH

#BEDROOMS 3

3-21-03 C. Williams
Date Zoning Administrator