

HTE 04-5-8633

**IMPROVEMENT PERMIT**

20611

Be it ordained by the Harnett County Board of Health as follows: Section III, Item B. "No Person shall begin construction of any building at which a septic tank system is to be used for disposal of sewage without first obtaining a written permit from the Harnett County Health Department."

Name: (owner) Michael McDonald  New Installation  Septic Tank  
 Property Location: SR# 401N  Repairs  Nitrification Line

Subdivision CLASSIC COVE Lot # 8

Tax ID # \_\_\_\_\_ Quadrant # \_\_\_\_\_

Number of Bedrooms Proposed: 4 Lot Size: 1.150

Basement with Plumbing:  Garage:

Water Supply:  Well  Public  Community

Distance From Well: 50' ft.

**Following is the minimum specifications for sewage disposal system on above captioned property. Subject to final approval.**

Type of system:  Conventional  Other \_\_\_\_\_

Size of tank: Septic Tank: 1200 gallons Pump Tank: \_\_\_\_\_ gallons

Subsurface Drainage Field: No. of ditches 2 exact length of each ditch 250 ft. width of ditches 3 ft. depth of <sup>man</sup>ditches 22-28 in.

French Drain Required: - Linear feet

Date: 2-24-04

**This permit is subject to revocation if site plans or intended use change.**

Signed: James E. Maulant  
 Environmental Health Specialist

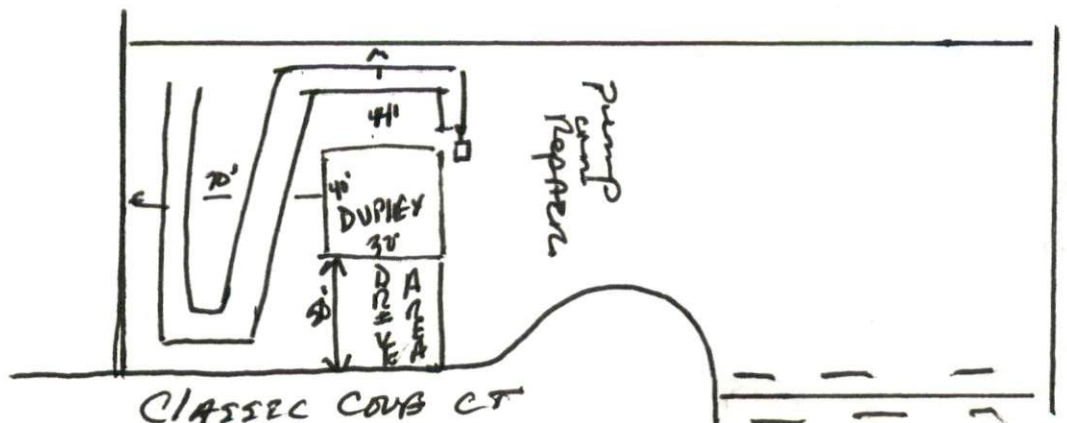

HARNETT COUNTY DEPARTMENT OF PUBLIC HEALTH  
AUTHORIZATION TO CONSTRUCT

Authorization is hereby given to construct a wastewater system to the specifications described by Harnett County Department of Public Health, Improvement Permit # 20611. This authorization shall be valid for a period not to exceed five (5) years from the date of issuance. *This authorization will be invalid if ownership, site plans, or intended use change.*

Name Michael McDonald Telephone # 919-868-2873

Address 155 CLASSIC COVE CT F.V. N.C. 27526

Property Location SR# 401 N Road Name 401 N

Subdivision CLASSIC COVE Lot # 8 # Bedrooms Proposed 4 Lot Size 1.150

**TYPE OF SYSTEM**

New Installation  Repair  Septic Tank  Nitrification Lines

Conventional  Other \_\_\_\_\_

Basement  With Plumbing  Without Plumbing

Water Supply:  Well  Public Water Supply Minimum Well Setback: \_\_\_\_\_ Ft.

Septic Tank 1200 gal Pump Chamber \_\_\_\_\_ gal

**NITRIFICATION FIELD SPECIFICATIONS**

Number of fields 2 # of lines per field 2 Length of lines 250 Ft.

Width of ditches 3 ft. Depth of ditches 22-718 inches

French Drain: Linear feet required \_\_\_\_\_ Depth of gravel \_\_\_\_\_

No wastewater system shall be covered or placed into use by any person until an inspection by the Harnett County Health Department has determined that the system has been installed according to the conditions of the Improvement Permit and that a valid Operations Permit has been issued.

Signature of Authorized Agent for Harnett County James E. Manhart

Date 2-24-04