

HTE 04-5-8814R

IMPROVEMENT PERMIT

20411

Be it ordained by the Harnett County Board of Health as follows: Section III, Item B. "No Person shall begin construction of any building at which a septic tank system is to be used for disposal of sewage without first obtaining a written permit from the Harnett County Health Department."

Name: (owner) CAVINESS LAND New Installation Septic Tank
Property Location: SR# 1141 Repairs Nitrification Line

Subdivision Highland Forest Lot # 101

Tax ID # _____ Quadrant # _____

Number of Bedrooms Proposed: 3 (50x51) Lot Size: 0.35 AC

Basement with Plumbing: Garage:

Water Supply: Well Public Community

Distance From Well: 50 ft.

Following is the minimum specifications for sewage disposal system on above captioned property. Subject to final approval.

Type of system: Conventional Other 25% Reduction SYSTEM

Size of tank: Septic Tank: 1000 gallons Pump Tank: _____ gallons

Subsurface Drainage Field No. of ditches 2 exact length of each ditch 75 ft. width of ditches 3 ft. depth of ditches 18-24 in.

French Drain Required: _____ Linear feet of 25% Reduction SYSTEM

Date: 3-26-04

This permit is subject to revocation if site SR1139 plans or intended use change. Signed: [Signature] Environmental Health Specialist

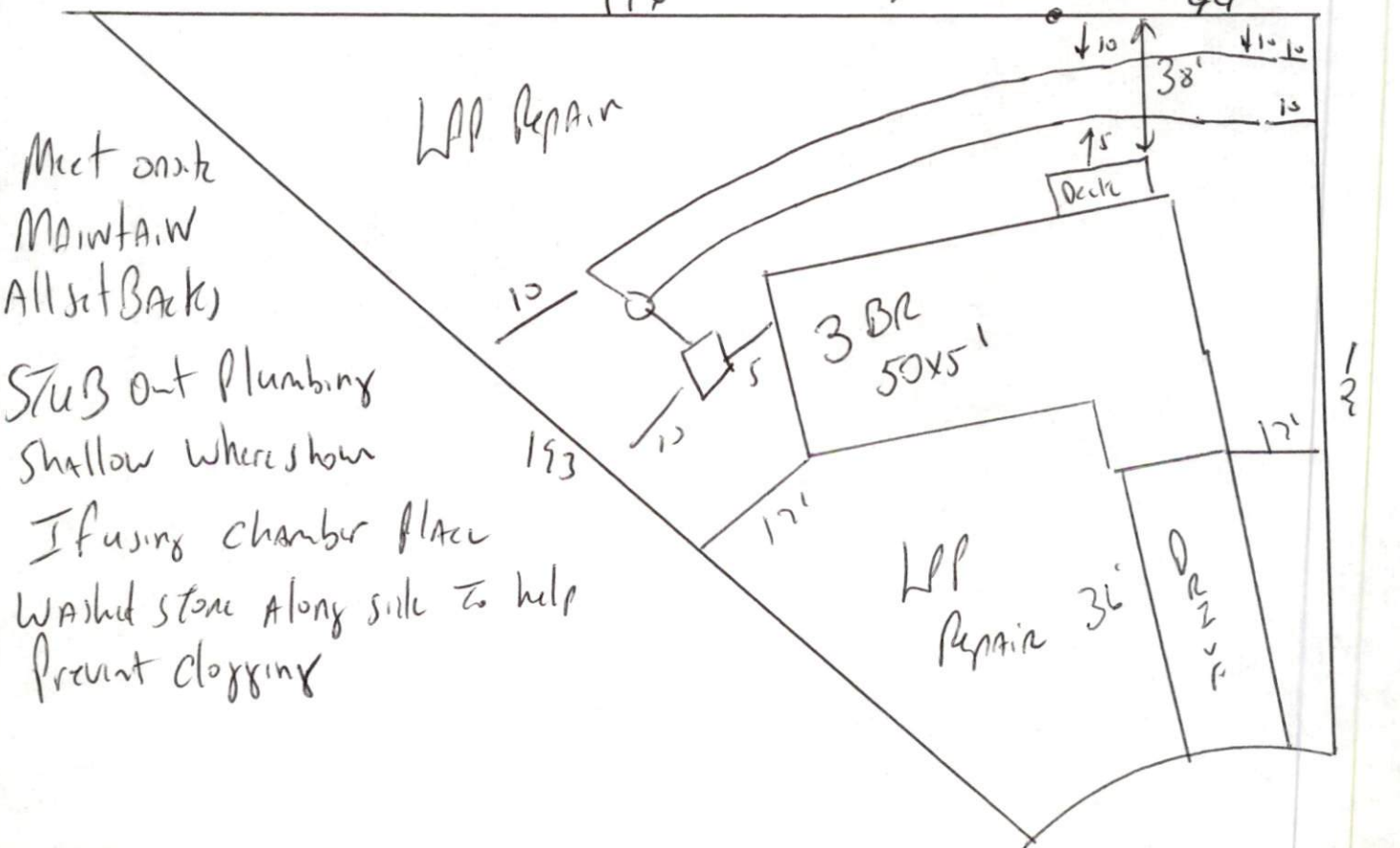

HARNETT COUNTY DEPARTMENT OF PUBLIC HEALTH
AUTHORIZATION TO CONSTRUCT

Authorization is hereby given to construct a wastewater system to the specifications described by Harnett County Department of Public Health, Improvement Permit # 20411. This authorization shall be valid for a period not to exceed five (5) years from the date of issuance.

This authorization will be invalid if ownership, site plans, or intended use change.

Caviness Land

Name _____ Telephone # _____

Address _____

1141

Property Location SR# _____ Road Name _____

Highland Forest 101 3(50x11) 0.35 ac

Subdivision _____ Lot # _____ # Bedrooms Proposed _____ Lot Size _____

TYPE OF SYSTEM

New Installation Repair Septic Tank Nitrification Lines

Conventional Other 2 1/2 Red-water 1012

Basement With Plumbing Without Plumbing

Water Supply: Well Public Water Supply Minimum Well Setback: 50 Ft.

Septic Tank 1000 gal Pump Chamber _____ gal

NITRIFICATION FIELD SPECIFICATIONS

Number of fields 1 # of lines per field 2 Length of lines 75 Ft.

Width of ditches 2 ft. Depth of ditches 18 in inches 4250

French Drain: Linear feet required _____ Depth of gravel _____

No wastewater system shall be covered or placed into use by any person until an inspection by the Harnett County Health Department has determined that the system has been installed according to the conditions of the Improvement Permit and that a valid Operations Permit has been issued.

J. West RS

Signature of Authorized Agent for Harnett County

3-26-04

Date