

HTE 04-5-8687

HARNEY COUNTY HEALTH DEPARTMENT
ENVIRONMENTAL HEALTH SECTION

16885

OPERATIONS PERMIT

Name: (owner) Kent Pierce New Installation Septic Tank
 Property Location: SR# 1115 Repairs Nitrification Line
 Subdivision Peach Tree Lot # 101
 Tax ID # _____ Quadrant # _____
 Contractor: Ted Brown Registration # _____

Basement with Plumbing: Garage:

Water Supply: Well Public Community

Distance From Well: 50 ft.

Following are the specifications for the sewage disposal system on above captioned property.

Type of system: Conventional Other Tree Chips

Size of tank: Septic Tank: _____ gallons Pump Tank: _____ gallons

Subsurface Drainage Field No. of ditches 1 exact length of each ditch 300 ft. width of ditches 3 ft. depth of ditches 18 in.

French Drain Required: _____ Linear feet

Date: 5-11-04

Inspected by: J. White
Environmental Health Specialist

PERMIT NO. 21095

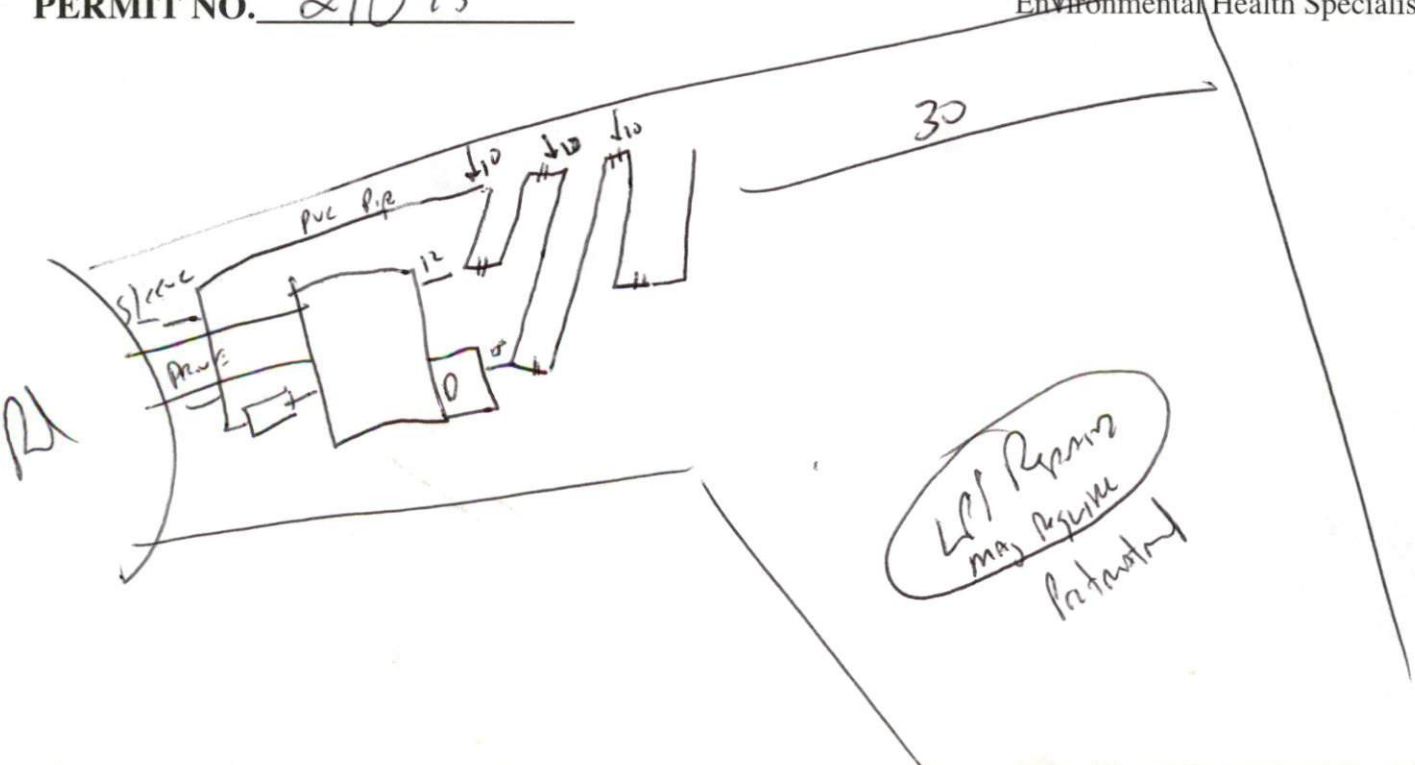

*Let Repair
may require
Patented*